

TREASURE ISLAND

DEVELOPMENT GROUP

April 15, 2024

Treasure Island Development Authority
One Avenue of the Palms, Suite 241
Treasure Island
San Francisco, CA 94130

Re: TI Vertical Lot C3.4 - 2023 Small Business Enterprise (SBE) Report

In accordance with the Small Business Enterprise Procedures adopted January 8, 2014, and amended September 14, 2016, TI Lots 3-4, LLC is providing this annual “SBE Report” documenting the project’s progress toward meeting the SBE Goals¹ through the calendar year 2023 and cumulatively to-date for January 8, 2014, through December 31, 2023.

Highlights for this year include:

- **14.1%** of the professional services contracts through 2023 included SBE firms (**\$600,327** out of **\$4,253,092** awarded).
- TI Lots 3-4, LLC awarded the construction contract for the development to Suffolk-Guzman JV III. **20.8%** of the construction contracts awarded through 2023 went to SBE firms (**\$19,203,837** out of **\$92,104,812** awarded).
- In total 2023 saw approximately \$2MM in contracts awarded to SBE firms – with \$91,413 of SBE scope added for professional services, and \$1,945,538 awarded for construction contracts.

A. PROFESSIONAL SERVICES CONTRACTS

Achieved SBE Measurement / SBE Progress on SBE Goals

The summary totals cumulative to-date contracts at calendar year end of 2023, amount awarded to SBEs, and amount awarded to San Francisco SBEs, along with the % against total covered contract values are listed in the table below.

	Cumulative To-Date
Total Covered Contracts Value	\$ 4,253,092
Amount Awarded to San Francisco-based SBEs	\$ 600,327
Amount Awarded to All SBEs	\$ 600,327
% of Total Covered Contract Value Awarded to San Francisco-based SBEs	14.1%
Achieved SBE Measurement	14.1%
Professional Services SBE Goal	38%

¹ TI Lots 3-4, LLC tracks Small Business Enterprise participation in accordance with TIDA’s adopted SBE Procedures. These goals do not require tracking of other disadvantaged businesses such as MBEs, DBEs, or WBEs, and therefore TI Lots 3-4, LLC does not have that information.

Exhibit A contains the compiled summary SBE Form 3 for each TI Lots 3-4, LLC prime consultant with the names and contract award amounts of SBE sub-consultant firms performing work under each TI Lots 3-4, LLC prime consultant.

Summary of 2023 Good Faith Effort SBE Outreach Compliance

New Professional Services Covered Contracts

2023 did not see any new contracts awarded and therefore no new awards to SBE firms.

Amendments to Existing Professional Services Covered Contracts

2023 saw \$91,413 of SBE scope added for professional services. The project initiated construction in 2022, and most design consultants continued under their initial contract scope this fiscal year.

B. CONSTRUCTION CONTRACTS

Achieved SBE Measurement / SBE Progress on SBE Goals

The summary totals for cumulative to-date and 2023 calendar year’s overall contract values, amount awarded to SBEs, and amount awarded to San Francisco SBEs, along with the % against total covered contract values are listed in the table below. Prime contracts through 2023 were awarded o Suffolk-Guzman JV III for the primary construction contract, and DeSilva Gates Construction for pre-construction site preparations.

	Cumulative To-Date
Total Covered Contracts Value	\$ 92,104,812
Amount Awarded to San Francisco-based SBEs	\$ 10,710,368
Amount Awarded to All SBEs	\$ 19,203,837
% of Total Covered Contract Value Awarded to San Francisco-based SBEs	11.6%
Achieved SBE Measurement	20.8%
Construction Contracts SBE Goal	41%

Exhibit B contains the compiled summary SBE Form 3 for each TI Lots 3-4, LLC prime contractors with the names and contract award amounts of SBE sub-contractors performing work under each TI Lots 3-4, LLC prime contractor.

Summary of 2023 Good Faith Effort SBE Outreach Compliance

Please see TI C3.4 – Portico, 2023 S/LBE Annual report attached, drafted by Suffolk Construction

SMALL BUSINESS ENTERPRISE PROCEDURES (TREASURE ISLAND/YERBA BUENA ISLAND)

EXHIBIT 2

Professional Services

FORM 3: SBE GOAL MEASUREMENT

This SBE Goal Measurement is to be provided by a Consultant or Subconsultant with its monthly progress payment request and upon final payment for the applicable Covered Contract under the Small Business Enterprise Procedures (Treasure Island/Yerba Buena Island) (as amended, the “SBE Procedures”). Capitalized terms used but not defined in this SBE Goal Measurement have the meanings ascribed to them in the SBE Procedures.

For column “A”, list the prime Consultant, each joint venture/associate partner and ALL Subconsultants including 2nd and 3rd tier Subconsultants. Make copies if more space is needed. Prime Consultant must retain copies of all the prime and subconsultant invoices supporting the information tabulated for this form. Information related to the Covered Contract must be retained and provided to the Authority in accordance with Section VII.C of the SBE Procedures.

Identify SBE Goal of this contract: %

A	B	C	D	E	F	G	H
	Service Performed	Dollar Value of Covered Contract at Time of Award	Amount of Modifications to Date	Total Amount of Covered Contract to Date +/- Modifications (C + D) or (C-D)	Amount Invoiced this Reporting Period	Amount Invoiced to Date	Percent Complete to Date (G÷E)
Mark Cavagnero Associates	Architect	1,602,000.00	798,905.00	2,400,905.00	23,248.00	2,103,957.00	88%
IMEG Illinois	Structural	268,400.00	179,058.00	447,458.00	2,145.00	392,590.00	88%
Plural (San Francisco SBE)	Landscape	240,429.20	107,220.30	347,649.50	1,586.75	350,612.65	101%
Hiram Banks (San Francisco SBE)	Lighting	60,079.25	29,150.00	89,229.25	-	77,604.87	87%
Clearstory (San Francisco SBE)	Signage	82,665.00	13,244.00	95,909.00	-	44,049.50	46%
Cross 2 Design Washington	Waterproofing	147,840.00	10,230.00	158,070.00	1,556.78	120,784.97	76%
C. S. Caulkins Irvine CA	Ext Bldg Maint	92,400.00	(36,300.00)	56,100.00	-	56,100.00	100%
Edgett Williams Mill Valley CA	Elevator	33,000.00		33,000.00		28,765.00	87%
MK Engineers (San Francisco SBE)	MEP	67,540.00		67,540.00	-	63,415.00	94%
Bright Green Strategies Santa Cruz	Energy Model	56,540.00	51,301.00	107,841.00	-	34,100.00	32%
Charles M Salter	Tel/Sec/Acoustics	248,600.00		248,600.00	-	165,394.08	67%
John Raeber	Specifications	11,550.00	2,750.00	14,300.00	-	12,100.00	85%
Fire Consultants Walnut Creek	Code / Life Safety	25,630.00		25,630.00	115.50	23,430.00	91%
LCM Chicago	Accessibility	63,195.00		63,195.00	-	15,331.36	24%
International Parking Design Encino	Parking	20,350.00		20,350.00	165.00	19,112.50	94%
American Trash Management	Waste Mgmt	14,300.00		14,300.00	-	13,475.00	94%
San Francisco SBE Professional Fees		450,713.45	149,614.30	600,327.75	1,586.75	535,682.02	89%
Other (Non-SF) SBE Professional Fees		-	0	-	-	-	#DIV/0!
All SBE Professional Fees Sub-Totals		450,713.45	149,614.30	600,327.75	1,586.75	535,682.02	89%
Non-SBE Professional Fees Sub-Totals		2,583,805.00	1,005,944.00	3,589,749.00	27,230.28	2,985,139.91	83%
SBE & Non-SBE Professional Fees		3,034,518.45	1,155,558.30	4,190,076.75	28,817.03	3,520,821.93	84%
Reimbursable Expenses		63,016.00	-	63,016.00	313.45	14,863.31	24%
CONTRACT TOTALS		3,097,534.45	1,155,558.30	4,253,092.75	29,130.48	3,535,685.24	83%

Amended 09.14.2016

Ajera 4253092.75

-

Treasure Island C3.4 Form 3: SBE Goal Measurement

Identify SBE Goal of this contract: 41 %

A	B	C	D	E	F	G	H
Name of Firm. List prime Contractor, including each JV/Association partner, and all Subcontractors. Indicate if the firm is a San Francisco SBE or Other SBE	Service Performed	Dollar Value of Covered Contract at Time of Award	Amount of Modifications to Date	Total Amount of Covered Contract to Date +/- Modifications (C + D) or (C-D)	Amount Invoiced this Reporting Period	Amount Invoiced to Date	Percent Complete to Date (C+E)
SUFFOLK/GUZMAN- San Francisco SBE	General Conditions	5,088,326.00	-	5,088,326.00	8,226,522.87	8,226,522.87	161.67%
LIBERTY/GUZMAN - San Francisco SBE	General Requirements	505,787.00	-	505,787.00	INCL. ABOVE		0.00%
SCAFFOLD SOLUTIONS	Scaffolding	330,997.00	-	330,997.00	120,845.00	120,845.00	36.51%
	Final Cleaning	-	-	-	-	-	-
LIBERTY	Cranes	313,854.00	-	313,854.00	-	-	-
LIBERTY	Hoists	553,949.00	-	553,949.00	-	-	0.00%
MARTIN RON - San Francisco SBE	Surveying	64,666.00	-	64,666.00	56,642.00	56,642.00	87.59%
LARGO	Concrete	7,302,763.00	-	7,302,763.00	7,346,514.84	7,346,514.84	100.60%
CELL-CRETE	Topping Slabs (Gyp Crete)	414,319.00	-	414,319.00	-	-	0.00%
CREATIVE MASONRY- CA State SB	Masonry	387,239.00	-	387,239.00	104,400.00	104,400.00	-
SOUTHWEST STEEL	Structural Steel / Metal Fabs	3,773,060.00	-	3,773,060.00	2,127,208.53	2,127,208.53	-
PACIFIC STAIR - San Francisco SBE	Metal Stairs	69,000.00	-	69,000.00	69,000.00	69,000.00	100.00%
COUNTRY BUILDERS	Rough Carpentry	10,780,654.00	-	10,780,654.00	5,442,434.79	5,442,434.79	50.48%
	Finish Carpentry	934,042.00	-	934,042.00	-	-	-
MTN INC.	Waterproofing	1,376,092.00	-	1,376,092.00	659,918.70	659,918.70	47.96%
COAST BUILDING PRODUCTS	Insulation	689,858.00	-	689,858.00	-	-	-
FREY - CA State SB	EIFS	6,230,786.00	-	6,230,786.00	-	-	0.00%
WESTERN ROOFING	Roofing	993,362.00	-	993,362.00	-	-	0.00%
BAY CITY MECHANICAL - San Francisco SBE	Flashing	1,827,754.00	-	1,827,754.00	82,911.90	82,911.90	-
PACIFIC SEALANTS	Joint Sealants	-	-	-	-	-	-
RT WESTERN	Doors, Frames & Hardware	2,143,847.00	-	2,143,847.00	22,500.00	22,500.00	-
	OH Doors	68,548.00	-	68,548.00	-	-	-
SMOKE GUARD CA	Elevator Entrance Smoke Containment	86,280.00	-	86,280.00	-	-	-
ALCAL GLASS SYSTEMS - CA SBE SUB	Windows & Curtainwall	304,944.00	-	304,944.00	304,944.00	304,944.00	100.00%
NORTH COUNTIES DRYWALL	Drywall	8,516,700.00	-	8,516,700.00	1,073,088.00	1,073,088.00	12.60%
D&J TILE	Tile	1,983,725.00	-	1,983,725.00	38,025.00	38,025.00	1.92%
ANDERSON	Wood Flooring	1,137,655.00	-	1,137,655.00	-	-	-
ANDERSON	Resilient Flooring	-	IN WOOD FLOORING	-	-	-	-
ANDERSON	Carpet	-	IN WOOD FLOORING	-	-	-	-
MAGNUM DRYWALL	Painting & Wallcovering	\$1,098,800	-	\$1,098,800	-	-	-
	Sealers & Coatings	-	IN PAINTING	-	-	-	-
	Misc Specialties (Corner Guards)	6,875.00	-	-	-	-	-
	Fire Protection Specialties & Knox Box	27,497.00	-	-	-	-	-
SPECIALTIES ETC.	Postal Specialties	-	CARRIED IN TRASH CHUTES	-	-	-	-
CREATIVE SHOWER	Toilet & Bath Accessories	334,692.00	-	334,692.00	-	-	-
CREATIVE SHOWER	Glass Shower Enclosures	262,607.00	-	262,607.00	-	-	-
ENERGY HOUSE	Fireplaces, Fire Pits, Outdoor Kitchens	155,536.00	-	155,536.00	-	-	-
	Signage	179,390.00	-	-	-	-	-
SIT-CO	Facade Maintenance (EBMS)	126,241.00	-	126,241.00	-	-	0.00%
R&B	Appliances	1,102,242.00	-	1,102,242.00	-	-	0.00%
SOZO (SUPPLY ONLY) San Francisco SBE, LBE	Manufactured Casework	1,655,338.00	-	1,655,338.00	329,204.10	329,204.10	-
D&J TILE	Countertops	1,296,999.00	-	1,296,999.00	34,425.00	34,425.00	2.65%
	Bicycle Racks	212,563.00	-	-	-	-	-
OTIS	Elevators	682,800.00	-	682,800.00	146,880.00	146,880.00	21.51%
SPECIALTIES ETC. San Francisco SBE	Chutes	218,299.00	-	218,299.00	-	-	0.00%
RCM FIRE - CA State SB	Fire Protection	1,570,500.00	-	1,570,500.00	695,107.53	695,107.53	44.26%
BROADWAY MECH.	Plumbing	10,696,833.00	-	10,696,833.00	5,713,990.23	5,713,990.23	53.42%
BAY CITY MECHANICAL - San Francisco SBE	HVAC	1,235,198.80	-	1,235,198.80	579,984.16	579,984.16	46.95%
SCOTT ELECTRIC / PHEONIX	Electrical	9,992,966.00	-	9,992,966.00	1,709,455.63	1,709,455.63	17.11%
CAL SOLAR	Power Generation (Solar)	746,197.40	-	746,197.40	-	-	0.00%
DESILVA GATES	Earthwork	786,253.00	-	786,253.00	1,088,527.93	1,088,527.93	138.44%
GRANITE	Utility Pit Shoring	99,500.00	-	99,500.00	-	-	0.00%
MALCOLM	Shoring & Dewatering	1,694,772.28	-	1,694,772.28	1,694,772.28	1,694,772.28	100.00%
CLEAR WATER	ATS	343,838.00	-	343,838.00	353,125.50	353,125.50	102.70%
	Paving (Parking Area Striping & Markings, Bumpers)	46,000.00	-	46,000.00	-	-	-
QLM	Site Concrete	678,242.00	-	678,242.00	-	-	-
SHOOTER AND BUTTS	Unit Paving	293,569.00	-	293,569.00	-	-	-
SHOOTER AND BUTTS	Landscape & Irrigation	740,451.00	-	740,451.00	-	-	-
SHOOTER AND BUTTS	Site Furnishings	353,731.00	-	353,731.00	-	-	-
	Utilities	-	-	-	-	-	-
ALLOWANCE	Gas-Powered Gator Utility Vehicle	15,000.00	-	15,000.00	-	-	0.00%
San Francisco SBE Professional Fees		11,809,168.80	-	10,710,368.80	9,344,265.03	9,344,265.03	87.25%
Other (Non-SF) SBE Professional Fees		8,493,469.00	-	8,493,469.00	1,104,451.53	1,104,451.53	0.00%
All SBE Professional Fees Sub-Totals		20,302,637.80	-	19,203,837.80	10,448,716.56	10,448,716.56	54.41%
Non-SBE Professional Fees Sub-Totals		72,228,499.68	-	72,900,974.68	27,571,711.43	27,571,711.43	37.82%
SBE & Non-SBE Professional Fees Totals		92,531,137.48	-	92,104,812.48	38,020,427.99	38,020,427.99	41.28%
Reimbursable Expenses		-	-	-	-	-	0.00%
CONTRACT TOTALS		\$ 92,531,137.48	\$ -	\$92,104,812.48	\$38,020,427.99	\$38,020,427.99	41.28%

Note: For SBE subcontractors, the Column E shows their contract amount with SGJV or their subcontracted SBE contract amount



TI C3.4 – 490 Avenue of The Palms

Date:04/06/2024

RE: S/LBE Annual Report

The below summarizes SGJV's S/LBE outreach efforts to date for the Treasure Island C3.4 Project:

Buyout Bid Outreach:

Landscape ITB (Invitation to Bid) Package was posted to TIDA website on 2/1/23 in addition to SGJV bid list. Email correspondence and tracking log included in supporting documentation.

630 Bidders

276 Responsive Bidders – 43.8% response rate

135 S/LBE Bid Invitations

79 S/LBE Bid Responses – 58.51% response rate

Refer to tracking log for S/LBE % under contract.

Ad Placed in San Francisco Examiner

Ad ran from February 8, 2023 – February 10, 2023

Ad included details for “pre-bid conference” to be held 2/22/23 and published to TIDA website.

Ad placement in San Francisco Examiner and ad snippet included in supporting documentation.

2/22/23 Prospective Bidder Pre-Bid Conference

Meeting held virtually on February 22, 2023, at 10am.

Power Point deck and attendee list included in supporting documents.

Suffolk “Build With us Program” (SBE Coalition Group)

As part of our commitment to community engagement, Suffolk hosts an annual educational program for S/M/DVBE contractors that guides newcomers on the prequalification, bidding, and contracting process with Suffolk. The program is open to all S/M/L/DVBE contractors and provides access to Suffolk executives in preconstruction and operations. Each contractor is assigned a mentor (Suffolk executive) responsible for presenting future bidding opportunities. The current cohort of 22 companies began meeting in March and will continue through June. More information can be provide on request.

Supporting Documents

6442542 - Treasure Island - C3.4 100%CD - Suffolk

010100.040 Surveying Services



Standing	Company	Contact	Email	City	ST	Phone	Mobile	Call	MBE
Will bid	BKF Engineers	Kevin Stein (No longer with Company)	kstein@bkf.com	Redwood City	CA		(650) 722-8781	LM	CA - Port of Oakland - LIA
Won't bid	F3 & Associates	Bidding Department (SF ITB)	Bidding@f3-inc.com	Benicia	CA	(707) 748-4300		DI	
Will bid	Martin M Ron Associates	Robert Slater (SF ITB)	robert@martinron.com	San Francisco	CA	(415) 543-4500	(707) 853-2651		CA - State of California, DGS - SB,CA - State of California, DGS - MBE,CA - State of California, DGS - SB-PW,CA - State of California, DGS - SB-PW,CA - City and County of San Francisco - OBE
No Response	REY Engineers Inc	Mike Shoup	mshoup@reyengineers.com	Mountain View	CA	(408) 219-3236	(408) 219-3236	LM	
Will bid	Sandis Civil Engineers Surveyors Planners	Behnaz Davis	bdavis@sandis.net	Campbell	CA	(408) 636-0900	(408) 607-2244	AI	CA - CUCP, Santa Clara VTA - SBE,CA - Port of Oakland - LIA,CA - Alameda County CTC - LBE,CO - Regional Transportation District - SBE,CA - State of California, DGS - SB,PA - Pennsylvania DOT - SBE,CA - Alameda County CTC - VSLBE,CA - Alameda County CTC - SLBE,CA - State of California, DGS - SB-PW,CA - State of California, DGS - SB-PW

013100.030 Final Cleaning - Building



Standing	Company	Contact	Email	City	ST	Phone	Mobile	Call	MBE
Will bid	Capital Building Maintenance & Cleaning Services Inc dba Clean Advantage	Allen Galang	allen@capitalbldg.com	South San Francisco	CA	(650) 588-9808	(650) 588-9808		CA - State of California, DGS - SB,CA - State of California, DGS - MBE,CA - State of California, DGS - SBE,CA - CADOT - SBE,CA - State of California, DGS - SB-PW
Won't bid	MGR Cleanup Inc	Marcello Scavotto	m scavotto@comcast.net	Fremont	CA	(408) 438-0056		AI	
No Response	Nor-Cal Building Maintenance	Jennifer DeHaro (SF ITB)	jenn@norcalbmi.com	Morgan Hill	CA	(408) 726-5853		LM	
Will bid	RT Western Inc	Rogelio Arellano (Final Clean ITBs)	rarellano@rtwestern.com	San Francisco	CA	(415) 677-9202	(408) 591-0391	BR	CA - City and County of San Francisco - MBE,The Supplier Clearinghouse - MBE,CA - Supplier Clearinghouse - MBE,CA - State of California, DGS - Micro SB,CA - State of California, DGS - SB,CA - CADOT - SBE
Will bid	S.J. General Building Maintenance Inc	Armando Lamas (ITB 1)	sjgbmnc@yahoo.com	San Jose	CA	(408) 392-0800	(408) 666-7475	BR	CA - State of California, DGS - SB,CA - State of California, DGS - MBE,MBE - Hispanic - Legacy iSqFt value,CA - State of California, DGS - SBE,CA - CADOT - SBE,CA - State of California, DGS - SB-PW,CA - State of California, DGS - Micro SB

014100.030 Temporary Tower Cranes - Use



Standing	Company	Contact	Email	City	ST	Phone	Mobile	Call	MBE
Won't bid	Bigge Group dba Bigge Crane and Rigging Co	Eric Hibler (CA ITB)	ehibler@bigge.com	San Leandro	CA	(510) 638-8100	(510) 254-1944	DI	
Won't bid	FUSE Specialty LLC	Patrick Fullerton (FL Crane ITBs)	pfullerton@fuseequip.com	Pompano Beach	FL	(786) 775-5169	(954) 295-8479	DI	
Will bid	Maxim Crane Works LP	Dean Berlin (SF ITB & Prequal)	dberlin@maximcrane.com	Pleasant Grove	CA	(916) 286-2770		AI	
Will bid	Morrow Equipment Company LLC	Cambiz Gholamshahi (SF ITB)	c.gholamshahi@morrow.com	American Canyon	CA	(707) 644-3731	(707) 815-6880	AI	

014100.070 Temporary Hoists - Use



Standing	Company	Contact	Email	City	ST	Phone	Mobile	Call	MBE
No Response	BrandSafway Services LLC (formerly Safway Services LLC)	Greg Mallek	gmallek@brandsafway.com	Santa Clara	CA	(408) 330-0721		LM	
Will bid	Fincco Services Inc	Art Torres	art@finccoservices.com	Fontana	CA	(909) 355-0707	(909) 240-0148		
Won't bid	FUSE Specialty LLC	Patrick Fullerton (FL Crane ITBs)	pfullerton@fuseequip.com	Pompano Beach	FL	(786) 775-5169	(954) 295-8479	DI	

Will bid	Maxim Crane Works LP	Dean Berlin (SF ITB & Prequal)	dberlin@maximcrane.com	Pleasant Grove	CA	(916) 286-2770		AI	
Will bid	Morrow Equipment Company LLC	Chris Whittle	c.whittle@morrow.com	American Canyon	CA	(707) 644-3731	(707) 815-6880	AI	
Will bid	Safway Atlantic LLC	Conal Molloy	conal.molloy@safwayatlantic.com	Union City	CA	(510) 441-7300	(929) 444-8509		



Standing	Company	Contact	Email	City	ST	Phone	Mobile	Call	MBE
Will bid	Bear Scaffold and Services	Carlos Velasco (SF ITB)	carlos@bearscaffold.com	Alviso	CA	(408) 262-1700	(408) 426-6547	AI	Federal - SDB - Small Disadvantaged Business, Federal - SB - Small Business Enterprise, CA - State of California, DGS - SB, CA - State of California, DGS - MBE, CA - City and County of San Francisco - OBE, CA - City and County of San Francisco - WBE
Will bid	BrandSafway Services LLC (formerly Safway Services LLC)	Steve Baldassarre (SF ITB)	steve.baldassarre@safway.com	Burlingame	CA	(650) 652-9250	(415) 559-8135	LM	
Will bid	Custom Scaffolding	Roberto Tames (ITB)	roberto@customscaffolding.com	Alviso	CA	(408) 934-9855		CN	
No Response	Nor Cal Scaffolding	roberto gonzalez (SF ITB 3)	rgonzalez@norcal-scaffolding.com	richmond	CA	(510) 635-6220		RS	CA - State of California, DGS - SB, CA - CADOT - SBE
Will bid	Scaffold Solutions Inc	Harold Pierre	hpierre@scaffoldsolutions.com	American Canyon	CA	(707) 561-7712		AI	CA - State of California, DGS - SB, CA - State of California, DGS - SB-PW, CA - State of California, DGS - SB-PW
No Response	Sightline Commercial Solutions LLC	Tracy Meister (SCS Prequal)	tmeister@sightlinecommercial.com	Minneapolis	MN	(877) 215-7245			

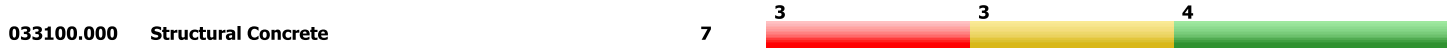

Standing	Company	Contact	Email	City	ST	Phone	Mobile	Call	MBE
No Response	Berkeley Cement Inc (BCI)	Billy Goode	billy.goode@bciconcrete.com	Berkeley	CA	(510) 525-8175			CA - Port of Oakland - LBA
Will bid	Blackrock Concrete	Teddy Mino	tmino@blackrock-concrete.com	San Francisco	CA	(415) 726-4017	(415) 726-4017		
No Response	CMC Rebar	Terrance Barry (SF ITB)	terrance.barry@cmc.com		CA		(707) 759-1402		
Won't bid	Gonsalves & Santucci Inc dba Conco	Jon Boone (SF ITB)	jboone@conconow.com	Concord	CA	(925) 685-6799		DI	
Won't bid	Joseph J Albanese Inc	Ricardo Rivera	rrivera@jbalbanese.com	Santa Clara	CA	(408) 727-5700	(408) 210-7168	DI	
Will bid	Largo Concrete Inc	Jon Scheele (SF ITB)	jscheele@largoconcrete.com	Campbell	CA	(408) 874-2500	(408) 640-0766		
Will bid	Pacific Structures Inc (PSI)	Sarah Montano (ITB)	sarah.montano@pacific-structures.com	San Francisco	CA	(415) 970-5434	(415) 816-3711		
Will bid	Peck and Hiller Co	Marcey Groves (SF ITB)	mgroves@peckandhiller.com	Napa	CA	(707) 258-8800	(707) 258-8800		
Won't bid	Webcor Craft LP	Lily Barrientos (Carpentry ITB)	lcai@webcor.com	Alameda	CA	(510) 748-1918		LM	CA - Port of Oakland - LIA, CA - City of Oakland - LBE
No Response	WestPro Construction Solutions	Mark Letscher	mark.l@westproconstruction.com	kansas city	TX	(816) 561-7667	(816) 561-7667		



Standing	Company	Contact	Email	City	ST	Phone	Mobile	Call	MBE
No Response	Alta Group	Gregg Granillo	gregg@altacmgc.com		CA		(415) 914-0468		
Will bid	Berkeley Cement Inc (BCI)	Charlie Wellborn (ITB)	charlie.wellborn@bciconcrete.com	Berkeley	CA	(510) 525-8175	(510) 388-4674		CA - Port of Oakland - LBA
Will bid	De Haro Ramirez Group	Juan Garcia	juan.g@dhrconcrete.com	San Francisco	CA		(415) 926-9993		CA - City and County of San Francisco - MBE
No Response	Dolan Concrete Construction	Lupe Moreno (SF ITB)	lupe@dolanconcrete.com		CA		(408) 869-3250	CN	
Won't bid	Joseph J Albanese Inc	Estimating Dept (ITB)	estimating@jbalbanese.com	Santa Clara	CA	(408) 727-5700		DI	
Won't bid	QLM Inc	Estimating Department (ITB)	estimating@qlm-inc.com	San Jose	CA	(408) 265-0904		AI	CA - CUCP, Santa Clara VTA - SBE, CA - State of California, DGS - SB, CA - BART - MSBE, CO - Regional Transportation District - SBE, CA - BART - SBE, CA - State of California, DGS - MBE, PA - Pennsylvania DOT - SBE

033500.000 Concrete Finishing

1

Standing	Company	Contact	Email	City	ST	Phone	Mobile	Call	MBE
No Response	Baker's Floor and Surface	Cheza Ligones	cheza@bakersfloorandsurface.com		CA		(956) 890-2637	AI	
Will bid	Floor Seal Technology Inc	Bonnie Boden (SF ITB)	bonnieb@floorseal.com	Milpitas	CA	(415) 716-1145	(415) 716-1145	AI	CA - State of California, DGS - SB,CA - State of California, DGS - SBE,CA - CADOT - SBE,CA - State of California, DGS - SB-PW

035000.000 Cast Decks and Underlayment

4

Standing	Company	Contact	Email	City	ST	Phone	Mobile	Call	MBE
Won't bid	AUS Decking Inc	Jared Chittenden (ITB)	jared@ausfloors.com	Sacramento	CA	(916) 373-5320		DI	
Won't bid	Cal-Lite Concrete	James Gallas	jim@cal-liteconcrete.com	Rancho Cucamonga	CA	(626) 967-9110		DI	
No Response	Camblin Steel Service Inc	Megan Villalobos (Prequal)	megan@camblinsteel.com	Rocklin	CA	(916) 644-1300			
No Response	Cell-Crete Corporation	Nathan Pieters	npieters@cell-crete.com	Hayward	CA	(510) 471-7257		BR	
Won't bid	Insul-Flow Inc	Albert Chang (All ITBs)	estimating@insul-flow.com	Fresno	CA	(559) 456-1105		DI	
No Response	M & M Lightweight Concrete Co	Wendy Anderson	wanderson_mm@msn.com	West Sacramento	CA	(916) 371-4630		CN	
No Response	Pj's Rebar Inc	ben Cobian	bcobian@pjsrebar.com	Fremont	CA	(510) 743-5290			

040000.000 Masonry

8

Standing	Company	Contact	Email	City	ST	Phone	Mobile	Call	MBE
Will bid	Creative Masonry Inc	Wendy Biczkow	creamas@comcast.net	Livermore	CA	(925) 606-8466			CA - State of California, DGS - MBE,CA - State of California, DGS - SB,CA - State of California, DGS - SBE,CA - CADOT - SBE,CA - State of California, DGS - SB-PW,CA - State of California, DGS - Micro SB
Will bid	Crown Masonry Inc	Pieter Dekock	crownmasonry@sbcglobal.net	Alameda	CA	(510) 917-1984		BR	
Will bid	E & S Masonry Corporation	Dave Pierson	davep@e-smasonry.com	Castro Valley	CA	(510) 581-2776		BR	CA - State of California, DGS - MBE,CA - Alameda County - SBE,CA - Alameda County - EB,CA - Alameda County - SLEB,CA - CADOT - SBE,CA - State of California, DGS - Micro SB
Won't bid	FUSE Specialty LLC	Aaron Sandland (San Francisco ITBs)	asandland@FUSEGroupL.C.com	San Francisco	CA	(718) 757-2310	(718) 757-2310	DI	
Won't bid	Hawksley Masonry Inc	Leo Vera	estimating@hawksleymasonry.com	Antioch	CA	(925) 754-5641	(510) 640-3131	DI	
Will bid	John Jackson Masonry	Rolando Robles	rolando@johnjacksonmasonry.com	Sacramento	CA	(916) 381-8021		BR	CA - State of California, DGS - SB,CA - State of California, DGS - MBE,CA - California Department of Industrial Relations - CADIR,CA - State of California, DGS - SBE,CA - CADOT - SBE,CA - State of California, DGS - SB-PW,CA - State of California, DGS - Micro SB
Will bid	Masonry Estimating	Jackie Sheppard	estimatingmasonry@gmail.com	Napa	CA			BR	
No Response	Precision Masonry	brian mitchell	precisionmasonry@att.net	vallejo	CA	(707) 208-7691		LM	CA - State of California, DGS - MBE,CA - State of California, DGS - SB

Will bid	Spencer Masonry Inc	Jackie Shepard	estimating@gmail.com	San Francisco	CA	(415) 467-1341	(707) 738-1566	BR	CA - CUCP, San Francisco MTA - DBE ,CA - State of California, DGS - MBE,CA - City and County of San Francisco - MBE,CA - City and County of San Francisco - WBE,CA - State of California, DGS - SB,CA - BART - MBE,CA - BART - SBE,CA - BART - MSBE,CA - CADOT - SBE,CA - Los Angeles County Metropolitan Transportation Authority - DBE,CA - State of California, DGS - Micro SB,CA - CADOT - DBE,CA - CADOT - DBE,CA - Port of Long Beach - DBE,CA - Metropolitan Water District of Southern California - DBE,CA - State of California, DGS - DVBE,CA - BART - DBE,CA - City and County of San Francisco - LBE,CA - CUCP, City of Fresno - DBE,CA - CUCP, San Mateo SAMTRANS - DBE,CA - METRO LA County MTA - DBE,CA - CUCP, METRO/LA County MTA - DBE,CA - Yolo County Transportation District - DBE,CA - California DOT, CALTRANS - DBE,CA - CUCP, Santa Clara VTA - DBE
----------	---------------------	----------------	----------------------	---------------	----	----------------	----------------	----	--

Won't bid	Walton & Sons Masonry	Amber Diamond	estimating@waltonsons.com	Morgan Hill	CA	(408) 782-8700	(650) 996-8975	DI	
-----------	-----------------------	---------------	---------------------------	-------------	----	----------------	----------------	----	--

055000.000 Metal Fabrications



Standing	Company	Contact	Email	City	ST	Phone	Mobile	Call	MBE
Undecided	Ahlborn Structural Steel Inc	Lance Ballenger (SF ITB 3)	Lance@ahlbornco.com	Santa Rosa	CA	(707) 573-0742	(707) 481-0003	UN	
Won't bid	Balco	Joni Fajardo	joni.fajardo@balcousa.com	Wichita	KS	(316) 946-9328			Other - Other - Legacy
Won't bid	CE Toland & Son	Dustin Toland	dustin@cetoland.com		CA		(707) 752-8233	LM	
Won't bid	Concord Iron Works	Hector Acosta (SF ITB)	hacosta@concordiron.com	PITTSBURG	CA	(925) 432-0136			
No Response	Glazier Steel Inc	Estimating Dept	estimating@glaziersteel.com	Hayward	CA	(510) 471-5300		LM	
Won't bid	Golden State Steel and Stair Inc	John Tuttle	john.tuttle@sbcglobal.net	Oakland	CA	(510) 763-2205	(510) 714-0924	DI	
No Response	Lee's Imperial Welding Inc	Estimating Department (ITB 1)	estimating@leeiw.com	Fremont	CA	(510) 657-4900	(510) 719-6515	LM	
No Response	O'Kane Structural Steel	George Wheelock	okanesteel@gmail.com	San Francisco	CA	(415) 990-2054		RS	CA - City and County of San Francisco - OBE,CA - City and County of San Francisco - WBE,CA - City and County of San Francisco - LBE
No Response	Olson Steel	Richard Louchart (ITB)	rlouchart@olsonsteel.com	San Leandro	CA	(510) 567-2200	(510) 567-2217	CN	CA - Port of Oakland - LIA
No Response	Red Cedar Steel Erectors Inc.	Dan Wengel	danw@redcedarsteel.com	Menomonie	WI	(715) 235-0618	(715) 505-2859	LM	
Won't bid	Romak Iron Works Inc	Lisa Alcares (Prequal/SF ITB)	lalcares@romak.com	Benicia	CA	(707) 751-2420			
Will bid	Southwest Steel of California Inc dba Southwest Steel Inc	Dan VanVerth (ITB)	dan.vanverth@sws-steel.com	Henderson	NV	(702) 856-1280	(702) 526-1689		
Will bid	TC Steel	Estimating Department (ITB)	tcsteel@tcsteel.com	Petaluma	CA	(707) 773-2150		AI	CA - Alameda County CTC - SLBE,CA - State of California, DGS - SB
Won't bid	Tom's Metal Specialists, Inc.	Lydia Yi	estimation@tomsmetalinc.com	San Francisco	CA	(415) 822-7971		NA	CA - City and County of San Francisco - MBE
Undecided	Trex Commercial Products	Patrick Cotter	pcotter@trexcommercial.com	Minneapolis	MN	(763) 999-4403			Federal - SB - Small Business Enterprise,Federal - SDB - Small Disadvantaged Business
Won't bid	Viking Steel	James Wright	j.wright@vikingsteel.net	Sacramento	CA	(916) 379-0210		DI	VA - DSBSD - SBE,VA - MWAA - LDDBE,VA - DSBSD - Micro

055100.000 Metal Stairs



Standing	Company	Contact	Email	City	ST	Phone	Mobile	Call	MBE
No Response	American Stair Corporation	Wes Ball (SF ITB)	wesball@sbcglobal.net	Hammond	IN	(916) 932-7334			Federal - VOSB - Veteran Owned Small Business,Federal - SDB - Small Disadvantaged Business,Federal - U. S. Department of Veteran Affairs - VOSB,IN - City of Indianapolis - VBE
Will bid	Pacific Stair Corporation	Tracy Goetsch	tracy@pacificstair.com	Salem	OR	(503) 390-8305	(503) 932-0330		
No Response	Southwest Steel of California Inc dba Southwest Steel Inc	Dan VanVerth (ITB)	dan.vanverth@sws-steel.com	Henderson	NV	(702) 856-1280	(702) 526-1689		

057000.000 Decorative Metal

0

Standing	Company	Contact	Email	City	ST	Phone	Mobile	Call	MBE
----------	---------	---------	-------	------	----	-------	--------	------	-----

061000.000 Rough Carpentry

8



Standing	Company	Contact	Email	City	ST	Phone	Mobile	Call	MBE
Will bid	Allied Framers Inc	Chris Cannon	chris@alliedframers.com	Vacaville	CA	(707) 452-7050		CN	
Won't bid	Bjork Construction Company Inc	Chrys Moreno (SF ITB)	cmoreno@bjorkconstruction.com	Fremont	CA	(510) 656-4688		DI	CA - State of California, DGS - MBE,Federal - Women's Business Enterprise National Council - WBENC,The Supplier Clearinghouse - WBE,CA - Alameda County CTC - SLBE,CA - State of California, DGS - SB,CA - City of Oakland - LBE,CA - Alameda County CTC - LBE,CA - California Department of Industrial Relations - CADIR,CA - State of California, DGS - SBE,CA - Alameda County CTC - VSLBE,CA - Alameda County - SBE,CA - Alameda County - EB,CA - Alameda County - SLEB,CA - Supplier Clearinghouse - WBE,CA - CUCP, Santa Clara VTA - MWBE
Will bid	Country Builders Construction Inc	David Acker	davida@countrybuilders.com	Livermore	CA	(925) 373-1020			CA - Port of Oakland - LBA
Won't bid	Daley's Drywall	Ed Davis	ed@daleysdrywall.com	Campbell	CA	(408) 374-7626	(408) 761-2652	CN	
Undecided	Gurnet Point LLC	Scott MacLellan	smacellan@gurnetpt.com	San Francisco	CA	(415) 800-1920	(617) 543-2995		CA - State of California, DGS - MBE,CA - CADOT - SBE,CA - State of California, DGS - Micro SB,CA - State of California, DGS - SB
Will bid	Hercules Builders	Willie McGary	herculesbuilders@yahoo.com	San Francisco	CA	(510) 568-5454	(510) 672-7041	CN	CA - City and County of San Francisco - MBE,CA - City and County of San Francisco - WBE
Won't bid	James E Roberts-Obayashi Corp	Rob Wangeline (SF ITB)	rwangeline@jerocorp.com	Danville	CA	(925) 820-0600	(925) 307-8821	DI	
No Response	Kawneer (an Arconic Company)	Brad Broyles	brad.broyles@arconic.com		TX		(479) 750-6305		
Will bid	Presidio Builders	Estimating Dept.	presidiobuilders@live.com	San Francisco	CA	(415) 508-9727	(415) 608-4450	CN	CA - City and County of San Francisco - MBE,CA - City and County of San Francisco - WBE,CA - City and County of San Francisco - LBE
No Response	Thompson Builders Corp	Matt Sasan	matts@tbcorp.com	Novato	CA	(415) 456-8972			

062000.000 Finish Carpentry

15



Standing	Company	Contact	Email	City	ST	Phone	Mobile	Call	MBE
No Response	Boyett Construction	Estimating Department (SF ITB)	bids@boyettconstruction.com	Hayward	CA	(510) 264-9100		CN	
Won't bid	Coastal International	Jesus Lopez (SF ITB)	jesus.lopez@coastalintl.com	Sausalito	CA	(415) 729-6190		DI	
Undecided	Crestmark Millwork Inc	Leslie Douglas (ITB 2)	leslied@crestmarkam.com	Arcata	CA	(707) 822-4034	(707) 496-4246	BR	CA - State of California, DGS - SB,CA - State of California, DGS - SBE,CA - CADOT - SBE,CA - State of California, DGS - SB-PW,CA - State of California, DGS - Micro SB
Won't bid	FUSE Specialty LLC	Aaron Sandland (San Francisco ITBs)	asandland@FUSEGroupL.C.com	San Francisco	CA	(718) 757-2310	(718) 757-2310	DI	
Will bid	Glacier DRS Inc	Mike Dezzani	mike@glacierdrs.com	Columbia Falls	MT	(406) 892-7278		AI	
Won't bid	Glenn Rieder LLC	Thomas Donohue (All Suffolk ITBs ITB)	tom.donohue@glennrieder.com	West Allis	WI	(414) 389-8670	(949) 254-1526	DI	
Will bid	House Construction	Elizabeth (ITB)	Liz@HouseCo.net	San Clemente	CA	(949) 429-5200		CN	
Will bid	MDB Interiors Inc	Zachary Burns	zachary@mdb-interiors.com	Petaluma	CA	(415) 444-5300	(406) 396-5059	BR	CA - State of California, DGS - SB,CA - State of California, DGS - SBE
Won't bid	Mission Bell Mfg, Inc.	Broc Harzinski (Prequal, West ITBs)	bharzinski@usa-millwork.com	Morgan Hill	CA	(303) 438-1612	(669) 244-1744		
Will bid	Om3 Inc	Estimating Dept (SF ITB 1)	estimating@om3inc.com	Union City	CA	(415) 660-7073	(415) 660-7073	BR	

Will bid	RT Western Inc	Orlando Guadarrama (Div:6,10,12 ITBs)	oguardarrama@rtwester n.com	San Francisco	CA	(415) 677-9202	(408) 887-5730	BR	CA - City and County of San Francisco - MBE,The Supplier Clearinghouse - MBE,CA - Supplier Clearinghouse - MBE,CA - State of California, DGS - Micro SB,CA - State of California, DGS - SB,CA - CADOT - SBE
No Response	Sullivan Construction Co Inc	Mike Dezzani (ITB)	mike@sullivaninstall.co m	Concord	CA	(406) 892-7278	(406) 270-9601	AI	CA - State of California, DGS - MBE,CA - State of California, DGS - SB,CA - State of California, DGS - SBE,CA - CADOT - SBE,CA - State of California, DGS - SB-PW,CA - State of California, DGS - Micro SB
No Response	Tarrant Group	Nicki Luck	nicole.tarrantgroup@gm ail.com	Sausalito	CA	(415) 425-3328		CN	CA - State of California, DGS - MBE,CA - CADOT - SBE,CA - State of California, DGS - Micro SB
No Response	Victory Woodworks	Mike Cook	mcook@victorywoodwor ks.com	sparks	NV	(775) 348-7552			
No Response	Victory Woodworks	Juan Acuna	bids@victorywoodworks. com	Sparks	NV	(775) 348-7552			
No Response	VT Industries Inc	Justin Cruise	schatzer2016@gmail.co m	La Mirada	CA	(714) 521-2167			
Won't bid	Webcor Craft LP	Kerriann McDermott	kerriann@webcor.com	Alameda	CA	(510) 748-1900	(650) 823-1751	LM	CA - Port of Oakland - LIA,CA - City of Oakland - LBE

064000.000 Architectural Woodwork



Standing	Company	Contact	Email	City	ST	Phone	Mobile	Call	MBE
Undecided	Crestmark Millwork Inc	Leslie Douglas (ITB 2)	leslied@crestmarkam.co m	Arcata	CA	(707) 822-4034	(707) 496-4246	BR	CA - State of California, DGS - SB,CA - State of California, DGS - SBE,CA - CADOT - SBE,CA - State of California, DGS - SB-PW,CA - State of California, DGS - Micro SB
Will bid	MDB Interiors Inc	Zachary Burns	zachary@mdb-interiors.com	Petaluma	CA	(415) 444-5300	(406) 396-5059	BR	CA - State of California, DGS - SB,CA - State of California, DGS - SBE
Not Invited	Stockham Construction Inc	Boyd Stockham (ITB)	bids@stockhamconstruc tion.com	Cotati	CA	(707) 664-0945			
No Response	Sullivan Construction Co Inc	Mike Dezzani (ITB)	mike@sullivaninstall.co m	Concord	CA	(406) 892-7278	(406) 270-9601	AI	CA - State of California, DGS - MBE,CA - State of California, DGS - SB,CA - State of California, DGS - SBE,CA - CADOT - SBE,CA - State of California, DGS - SB-PW,CA - State of California, DGS - Micro SB
No Response	VT Industries Inc	Justin Cruise	schatzer2016@gmail.co m	La Mirada	CA	(714) 521-2167			

071000.000 Dampproofing and Waterproofing



Standing	Company	Contact	Email	City	ST	Phone	Mobile	Call	MBE
Will bid	Alcal Specialty Contracting	Wyatt Foreman (SF ITB, WP, Pedestal Pavers)	wyatt.foreman@alcal.co m	Sacramento	CA	(510) 458-0156	(510) 458-0156	BR	
Won't bid	Alliance Roofing Company Inc	Michelle Marcus (SF ITB)	bids@alliancerooftingcal. com	Santa Clara	CA	(408) 261-2595	(408) 761-2189		
No Response	Best Contracting Services Inc	Steve Zawati	szawati@bestcontracting .com		CA		(310) 328-6969		CA - Port of Oakland - LBA
No Response	Blackwood DLE	Brett Tilley	brett@blackwood-dle.com	Vacaville	CA	(707) 422-7481	(916) 337-7090		
No Response	Blue's Roofing Company Inc	Leo Ibarra (ITB)	li@bluesroof.com	San Jose	CA	(408) 240-0687		CN	CA - State of California, DGS - SB,CA - State of California, DGS - SB-PW,CA - State of California, DGS - SB-PW
Will bid	FD Thomas Inc	Rick Pouncey (ITB)	rick.pouncey@fdthomas. com	Sacramento	CA	(916) 922-1505	(916) 367-8621	CN	AK - AKDOT - DBE,CA - CADOT - DBE,CA - CADOT - DBE,The Supplier Clearinghouse - MBE,CA - Supplier Clearinghouse - MBE,CA - Los Angeles County Metropolitan Transportation Authority - DBE,CA - Port of Long Beach - DBE,CA - Metropolitan Water District of Southern California - DBE,CA - State of California, DGS - DVBE,CA - BART - DBE,CA - CUCP, City of Fresno - DBE,CA - CUCP, San Francisco MTA - DBE,CA - CUCP, San Mateo SAMTRANS - DBE,CA - METRO LA County MTA - DBE,CA - CUCP, METRO/LA County MTA - DBE,CA - Yolo County Transportation District - DBE,CA - California DOT, CALTRANS - DBE,CA - CUCP, Santa Clara VTA - DBE

No Response	Foley Waterproofing	Estimating Department	estimating@foleywp.com	Kentfield	CA	(415) 663-6539			
No Response	MASCO-Top Build	Elmer Reyes	elmer.reyes@amnationalservices.com		CA			(408) 202-3057	
Will bid	MTN Inc	Pushpak Prajapati	pushpak.prajapati@mtn-inc.com	Englewood	CO				
Will bid	The Lawson Roofing Co Inc	Estimating Department (SF ITB)	lrc@lawsonroofing.com	San Francisco	CA	(415) 285-1661			LM
Will bid	Western Roofing Service	Calvin Lee (ITB)	clee@westroof.com	San Leandro	CA	(510) 686-4951			CA - Port of Oakland - LIA,CA - Port of Oakland - SBE

072100.000 Thermal Insulation 5 

Standing	Company	Contact	Email	City	ST	Phone	Mobile	Call	MBE
Will bid	Alcal Specialty Contracting	joshua faeh	joshua.faeh@alcal.com		CA		(510) 477-9380	BR	
Will bid	Bear Insulation Inc.	Don Mardesich	don@bearinsulation.com		CA		(925) 766-2228		
Will bid	Coast Building Products	Raymond (No longer works with Coast) Aranas	raymond.aranas@amnationalservices.com	Santa Clara	CA	(408) 882-0411	(408) 234-8769	CN	
Will bid	Pacific Sealants	Jared Ries	jared@pacificsealants.com	San Ramon	CA	(925) 443-6973	(925) 389-7309		CA - State of California, DGS - MBE,CA - State of California, DGS - SB,CA - CADOT - SBE,CA - State of California, DGS - Micro SB
No Response	Platinum Insulation Inc	Estimating Department (ITB)	admin@platinuminsul.com	Lathrop	CA	(209) 815-9982			CA - State of California, DGS - SB-PW,CA - State of California, DGS - SB-PW
No Response	Spring Valley Insulation Contractors	Chris Martellaro (SF ITB)	chris@svicont.com	Spring Valley	CA	(619) 463-0266	(408) 817-0465		CA - State of California, DGS - DVBE,CA - State of California, DGS - SB,CA - State of California, DGS - MBE,CA - California Department of Industrial Relations - CADIR,CA - CADOT - SBE,CA - State of California, DGS - Micro SB
Will bid	West Coast Insulation Inc	Jeff Dude (ITB)	jeffd@westcoastinsulation.com	Hayward	CA	(650) 369-7111	(510) 719-1020	CN	CA - State of California, DGS - SB,CA - State of California, DGS - MBE,CA - State of California, DGS - SBE,CA - CADOT - SBE,CA - State of California, DGS - SB-PW,CA - State of California, DGS - Micro SB

072400.000 Exterior Insulation and Finish Systems 8 

Standing	Company	Contact	Email	City	ST	Phone	Mobile	Call	MBE
Won't bid	Daley's Drywall	Ed Davis	ed@daleysdrywall.com	Campbell	CA	(408) 374-7626	(408) 761-2652	CN	
Will bid	Frey Inc	Jeff Campbell (Prequal)	jcampbell@freyplastering.com	Novato	CA	(415) 897-4510	(415) 246-2138		CA - State of California, DGS - SB,CA - State of California, DGS - SBE,CA - CADOT - SBE,CA - State of California, DGS - SB-PW,SBE - Small Disadvantaged Business - SDB - Legacy iSqFt value,Federal - WOSB - Women-Owned Small Business,CA - State of California, DGS - Micro SB
Won't bid	J & J Acoustics Inc	Abel Leon (ITB)	abel@jjacoustics.com	San Jose	CA	(408) 275-9255	(408) 639-7301		
No Response	Keenan Hopkins Suder Stowell Contractors Inc	Rob Shimetz (SF ITB)	rob.shimetz@khsswest.com	Concord	CA	(925) 677-0828	(714) 396-4294	LM	
Will bid	Patrick J Ruane Inc	John Fuetsch (SF ITB)	john.fuetsch@pjrueane.com	South San Francisco	CA	(650) 616-7676	(415) 596-8555	LM	CA - State of California, DGS - SB,CA - State of California, DGS - SBE,CA - CADOT - SBE,CA - State of California, DGS - SB-PW,CA - State of California, DGS - Micro SB
No Response	Raymond Group (Northern California)	Darrell Jones (SF ITB)	darrell.jones@raymondgroup.com	Martinez	CA	(925) 680-8300	(916) 690-7724	NA	
No Response	RFJ Meiswinkel Company	Anthony Arciniega (ITB)	anthony@rfjmeiswinkel.com	San Francisco	CA	(415) 404-2239		LM	

Will bid	Valdez Painting Inc	Gino Valdez (ITB)	gino@valdezpainting.net	Sacramento	CA	(916) 454-2243		BR	Federal - SB - Small Business Enterprise,Federal - SDB - Small Disadvantaged Business,Federal - WOSB - Women-Owned Small Business,Federal - MBE Hispanic - National Minority Supplier Development Council,CA - California Department of Industrial Relations - CADIR,CA - State of California, DGS - SB,National Minority Supplier Development Council,CA - State of California, DGS - MBE,National Minority Supplier Development Council - NMSDC - MBE,CA - CADOT - SBE,CA - State of California, DGS - Micro SB
----------	---------------------	-------------------	-------------------------	------------	----	----------------	--	----	---

074000.000 Roofing and Siding Panels



Standing	Company	Contact	Email	City	ST	Phone	Mobile	Call	MBE
Will bid	Alcal Specialty Contracting	Mark McAtee	mark.mcatee@alcal.com	Fremont	CA	(510) 477-9380	(510) 714-9224	BR	
Won't bid	Alliance Roofing Company Inc	Michelle Marcus (SF ITB)	bids@alliancerooftingcal.com	Santa Clara	CA	(408) 261-2595	(408) 761-2189		
No Response	Beacon Roofing Supply	Jake Adams	jadams@becn.com						
Will bid	Best Contracting Services Inc	Ryan Garcia (ITB)	Rgarcia@bestcontracting.com	Gardena	CA	(310) 328-6969	(310) 864-0104		CA - Port of Oakland - LBA
No Response	Blue's Roofing Company Inc	Leo Ibarra (ITB)	li@bluesroof.com	San Jose	CA	(408) 240-0687		CN	CA - State of California, DGS - SB,CA - State of California, DGS - SB-PW,CA - State of California, DGS - SB-PW
Will bid	FD Thomas Inc	Rick Pouncey (ITB)	rick.pouncey@fdthomas.com	Sacramento	CA	(916) 922-1505	(916) 367-8621	CN	AK - AKDOT - DBE,CA - CADOT - DBE,CA - CADOT - DBE,The Supplier Clearinghouse - MBE,CA - Supplier Clearinghouse - MBE,CA - Los Angeles County Metropolitan Transportation Authority - DBE,CA - Port of Long Beach - DBE,CA - Metropolitan Water District of Southern California - DBE,CA - State of California, DGS - DVBE,CA - BART - DBE,CA - CUCP, City of Fresno - DBE,CA - CUCP, San Francisco MTA - DBE ,CA - CUCP, San Mateo SAMTRANS - DBE,CA - METRO LA County MTA - DBE,CA - CUCP, METRO/LA County MTA - DBE,CA - Yolo County Transportation District - DBE,CA - California DOT, CALTRANS - DBE,CA - CUCP, Santa Clara VTA - DBE
No Response	NorthClad Rainscreen Solutions	Jeffrey Hutchinson	jhutchinson@northclad.com	Everett	WA				
No Response	Tapered Design Center	Brian Billingsley	taper@tdcroof.com	Irvine	CA	(949) 852-0111			
Will bid	The Lawson Roofing Co Inc	Estimating Department (SF ITB)	lrc@lawsonroofing.com	San Francisco	CA	(415) 285-1661		LM	
No Response	The Miller - Clapperton Partnership, Inc	Zeke Miller	bids@millerclapperton.com	Austell	GA	(770) 941-8281			
Will bid	Western Roofing Service	Calvin Lee (ITB)	clee@westroof.com	San Leandro	CA	(510) 686-4951			CA - Port of Oakland - LIA,CA - Port of Oakland - SBE

074200.000 Wall Panels



Standing	Company	Contact	Email	City	ST	Phone	Mobile	Call	MBE
Will bid	Paragon Mechanical	Jason Lujan (ITB 1)	jlujan@paragonmechanical.com	Morgan Hill	CA	(408) 727-7303	(669) 266-6803	CN	

076000.000 Flashing and Sheet Metal



Standing	Company	Contact	Email	City	ST	Phone	Mobile	Call	MBE
No Response	Bay City Mechanical Inc	John Swahn (RETIRED)	john@baycitymech.com	Richmond	CA	(510) 233-7000	(510) 815-1876		
No Response	Bear Insulation Inc.	Don Mardesich	don@bearinsulation.com		CA		(925) 766-2228		
No Response	M & S Sheet Metal	Danny Kim (SF ITB)	dannyk.mds@gmail.com	San Francisco	CA	(415) 822-8948	(415) 244-3603		CA - City and County of San Francisco - MBE,CA - City and County of San Francisco - WBE

No Response	Mauck Sheet Metal	Marcos Rocha	marcos@maucksheetmetal.com	Oakland	CA	(510) 638-3607			CA - Port of Oakland - LIA,CA - Port of Oakland - SBE,CA - State of California, DGS - SB,CA - State of California, DGS - SBE,CA - CADOT - SBE,CA - State of California, DGS - SB-PW,CA - State of California, DGS - SB-PW,CA - City of Oakland - SLBE,CA - Alameda County - SBE,CA - Alameda County - SLEB,CA - City of Oakland - LBE,CA - State of California, DGS - Micro SB
No Response	Omni Sheet Metal Inc	JASKAMAL SINGH	jsingh@omnisheetmetal.com		CA	(408) 435-5020			CA - State of California, DGS - MBE,CA - State of California, DGS - SB,CA - CADOT - SBE
No Response	Paragon Mechanical	Matt Miller	mmiller@paragonmechanical.com		CA	(408) 709-0404		CN	
No Response	S & L Payton Inc	Mike Payton	mikep@paytonsheetmetal.com	San Francisco	CA	(415) 822-8808	(415) 850-1832		
Will bid	West Coast Architectural Sheet Metal	Jason Boyd (SF ITB)	jason@westcoastasm.com	San Jose	CA	(408) 612-4385			

079200.000 Joint Sealants



Standing	Company	Contact	Email	City	ST	Phone	Mobile	Call	MBE
No Response	Bear Insulation Inc.	Don Mardesich	don@bearinsulation.com		CA		(925) 766-2228		
Will bid	Pacific Sealants	Jared Ries	jared@pacificsealants.com	San Ramon	CA	(925) 443-6973	(925) 389-7309		CA - State of California, DGS - MBE,CA - State of California, DGS - SB,CA - CADOT - SBE,CA - State of California, DGS - Micro SB

081000.000 Doors and Frames



Standing	Company	Contact	Email	City	ST	Phone	Mobile	Call	MBE
Will bid	American Direct	Estimating Department (All ITBs)	adpplans@americandirectco.com	Lenexa	KS	(913) 677-5588			Federal - SDB - Small Disadvantaged Business,Federal - SB - Small Business Enterprise
No Response	Boyett Construction	Anthony Tse	atse@boyettdoors.com	Hayward	CA	(510) 264-9100			CN
Won't bid	Capitol Builders Hardware	David Karaczoff	davidk@cbhsec.com	Sacramento	CA	(916) 451-2821			DI
Undecided	Commercial Door & Frame	Valon Cross	valon@cdoorframe.com	San Leandro	CA	(510) 957-5108			BR CA - State of California, DGS - MBE,CA - CADOT - SBE,CA - State of California, DGS - Micro SB,CA - Alameda County - SBE,CA - Alameda County - SLEB,CA - Port of Oakland - LIA,CA - Port of Oakland - SBE,CA - Port of Oakland - VSBE,CA - State of California, DGS - SB,CA - State of California, DGS - SBE,CA - State of California, DGS - SB-PW
No Response	Construction Specialties Inc	Alberto Favila	afavila@csgroup.com	Del Rio	TX	(908) 849-4784			
Will bid	Glacier DRS Inc	Mike Dezzani	mike@glacierdrs.com	Columbia Falls	MT	(406) 892-7278			AI
Will bid	House Construction	Elizabeth (ITB)	Liz@HouseCo.net	San Clemente	CA	(949) 429-5200			CN
Won't bid	ISEC Inc	John Patock (SF ITB)	jepatock@isecinc.com	dixon	CA	(707) 693-6555			DI CA - SD Airport - LBE
Will bid	MDB Interiors Inc	Michael Daly	mike_d@mdb-interiors.com	Petaluma	CA	(415) 444-5300	(415) 720-0364		BR CA - State of California, DGS - SB,CA - State of California, DGS - SBE
Undecided	Minton Door Company	Estimating Department (ITB)	bids@mintondoor.com	Sunnyvale	CA	(408) 743-9220			UN
No Response	Rowe Fenestration	Spencer Bennett	spencer@rowefen.com		CA		(916) 432-0404		LM
Will bid	RT Western Inc	Eric Subia	esubia@rtwestern.com		CA	(415) 677-9202	(714) 308-9155		BR CA - City and County of San Francisco - MBE,The Supplier Clearinghouse - MBE,CA - Supplier Clearinghouse - MBE,CA - State of California, DGS - Micro SB,CA - State of California, DGS - SB,CA - CADOT - SBE
Will bid	Sullivan Construction Co Inc	Jerry Sullivan (SF ITB 1)	jpsullivan44@aol.com	Concord	CA	(925) 689-2177	(916) 548-9035		AI CA - State of California, DGS - MBE,CA - State of California, DGS - SB,CA - State of California, DGS - SBE,CA - CADOT - SBE,CA - State of California, DGS - SB-PW,CA - State of California, DGS - Micro SB
Won't bid	Tri Valley Doors	Steve Haverland	steve@trivalleydoors.com	Livermore	CA	(925) 456-3667	(925) 580-5939		DI

No Response	VT Industries Inc	Justin Cruise	schatzer2016@gmail.com	La Mirada	CA	(714) 521-2167			
Won't bid	Webcor Craft LP	Kerriann McDermott	kerriann@webcor.com	Alameda	CA	(510) 748-1900	(650) 823-1751	LM	CA - Port of Oakland - LIA,CA - City of Oakland - LBE

083300.000 Coiling Doors and Grilles



Standing	Company	Contact	Email	City	ST	Phone	Mobile	Call	MBE
Will bid	Alcal Specialty Contracting	Tyler Nunes	tyler.nunes@alcal.com		CA		(510) 248-9226	BR	
No Response	American Direct	Andrew Suchaire	andrews@americandirectco.com		CA		(800) 593-5310		Federal - SDB - Small Disadvantaged Business,Federal - SB - Small Business Enterprise
Will bid	Barton Overhead Door Inc	Matt Haynes	mhaynes@bartondoor.com	Modesto	CA	(209) 571-3667		BR	CA - State of California, DGS - SB,CA - State of California, DGS - SBE,CA - CADOT - SBE,CA - State of California, DGS - SB-PW,CA - State of California, DGS - Micro SB
Won't bid	Contra Costa Door Inc	Mark Johnson	mark@contracostadoor.com	Concord	CA	(925) 250-0067		DI	
Will bid	D W Nicholson Overhead Door Company of Central Bay Area	Phil Kenaga	pkenaga@dwnicholson.com	Fremont	CA	(510) 887-0900	(510) 723-0773	BR	
Will bid	McKendry Door Sales & Service (MDS)	Nancy Gutierrez (ITB)	ngutierrez@mndsla.com	Santa Fe Springs	CA	(562) 531-2576		LM	CA - State of California, DGS - SB,CA - State of California, DGS - SBE,CA - State of California, DGS - SB-PW,CA - CADOT - SBE,CA - State of California, DGS - MBE,CA - State of California, DGS - Micro SB,CA - Metropolitan Water District of Southern California - SBE
Will bid	North Bay Overhead Doors Inc	Kim Berlin (SF ITB)	kim@northbaydoors.com	Petaluma	CA	(415) 499-0602		BR	CA - State of California, DGS - MBE,CA - State of California, DGS - SB,CA - CADOT - SBE,CA - State of California, DGS - Micro SB
Won't bid	Overhead Door Company of Santa Clara	Eddie Torres (Commercial)	etorres@odcsantaclara.com	Sunnyvale	CA	(408) 734-8010	(408) 640-1693	DI	
Not Invited	Smoke Guard California Inc	TYANN PATANE	tyann.patane@sgspecialties.com		CA		(925) 331-8261	BR	
Will bid	US Smoke & Fire	Flor Gomez	flor@ussmokeandfire.com	Reston	VA	(888) 917-8777		BR	

085000.000 Windows



Standing	Company	Contact	Email	City	ST	Phone	Mobile	Call	MBE
Will bid	ACR Glass and Doors	Daryl Ryor	dryor1@acrglazing.com		CA		(925) 408-4600		CA - Alameda County - SBE,CA - Alameda County - SLEB,CA - CADOT - SBE,CA - Los Angeles County Metropolitan Transportation Authority - DBE,CA - CADOT - DBE,CA - CADOT - DBE,CA - State of California, DGS - SB,CA - State of California, DGS - SB-PW,CA - State of California, DGS - SBE,CA - Port of Long Beach - DBE,CA - Metropolitan Water District of Southern California - DBE,CA - State of California, DGS - DVBE,CA - BART - DBE,CA - CUCP, City of Fresno - DBE,CA - CUCP, San Francisco MTA - DBE ,CA - CUCP, San Mateo SAMTRANS - DBE,CA - METRO LA County MTA - DBE,CA - CUCP, METRO/LA County MTA - DBE,CA - Yolo County Transportation District - DBE,CA - California DOT, CALTRANS - DBE,CA - CUCP, Santa Clara VTA - DBE,CA - State of California, DGS - Micro SB
Will bid	Alcal Glass Systems Inc	Kaytlyn Dale	kaytlyn.dale@alcalglass.com	Sacramento	CA	(916) 286-5700	(530) 286-5700		
Will bid	All Weather Architectural Aluminum	Jim Glodowski	jimg@allweatheraa.com	Vacaville	CA	(707) 689-3196			
No Response	American Direct	Andrew Suchaire	andrews@americandirectco.com		CA		(800) 593-5310		Federal - SDB - Small Disadvantaged Business,Federal - SB - Small Business Enterprise
Will bid	Capitol General Contractors	Nick Jauregui	nick@capitolglasscompany.com		CA		(510) 786-7200		

Will bid	Capitol Glass Company	Matt Jurado (ITB)	matt@capitolglasscomp any.com	Hayward	CA	(510) 786-4200	(650) 346-9261		Federal - SDVOSB - Service Disabled Veteran Owned Business, Federal - SDB - Small Disadvantaged Business, Federal - VOSB - Veteran Owned Small Business, Federal - SB - Small Business Enterprise, CT - Connecticut DAS Diversity - LEGACY, CT - Connecticut DAS Diversity - SBE
No Response	Collier Warehouse	Tammy Keller	tkeller@colliergroup.com	San Francisco	CA	(415) 920-9720			
Will bid	P & M Windows	Scott Meredith	scottkm@att.net	Orinda	CA	(925) 254-5894			CA - State of California, DGS - MBE, CA - State of California, DGS - SB, CA - State of California, DGS - SBE, CA - CADOT - SBE, CA - State of California, DGS - SB-PW, CA - State of California, DGS - Micro SB
Will bid	Peerless Products Inc	Coby Jones	cjones@peerlessproducts.com	Fort Scott	KS	(620) 223-4610	(620) 260-0024		
Won't bid	Pinnacle Installations Inc	Doug Whitsitt	dwhitsitt@pinninc.com	Oakland	CA	(510) 923-9009			CA - Port of Oakland - SBE, CA - Port of Oakland - LIA, CA - State of California, DGS - SB, CA - State of California, DGS - SBE, CA - Alameda County - SBE, CA - Alameda County - EB, CA - Alameda County - SLEB, CA - CADOT - SBE, CA - State of California, DGS - SB-PW, CA - State of California, DGS - Micro SB
No Response	Progress Glass Co Inc	Joe Mitchell (ITB)	joemitchell@progressglass.com	San Francisco	CA	(415) 824-7040			
No Response	QOL Corp dba CEOWD Glazing	Steve Landry (SF ITB)	steve@ceowd.com	Chuka Vista	CA	(415) 643-4551	(619) 292-1285		
Will bid	Rowe Fenestration	Ryan Stephens	ryan@rowefen.com	Turlock	CA	(559) 786-3964			LM
Will bid	US Glass & Aluminum Inc	Jennifer Norris	jennifer@us-glass.com	Pittsburg	CA	(925) 427-7100	(925) 427-7100		CN
Will bid	USGA Inc	Paul Wagner	pwagner@usgainc.com	Hayward	CA	(925) 427-7201	(510) 333-3528		CN
Won't bid	VPI Quality Windows	Catherine McGowan	estimating@vpiwindows.com	Spokane	WA	(509) 532-2226			
No Response	Walters & Wolf Glass Company	Paul Roy (ITB)	proy@waltersandwolf.com	Fremont	CA	(510) 490-1115			

092100.000 Plaster and Gypsum Board Assemblies

14



Standing	Company	Contact	Email	City	ST	Phone	Mobile	Call	MBE
No Response	Anning-Johnson Company (Anson Industries)	Ryan Colello (SF ITB)	rcolello@anningjohnson.com	Hayward	CA	(510) 670-0100	(510) 670-2337	LM	
No Response	Basis	John Basis	john.basis.test@gmail.com		CA		78528636		
No Response	California Drywall Co	Tom Jester	tjester@caldrywall.com		CA	(408) 292-7500	(856) 266-6565	LM	
No Response	Custom Drywall Inc	Nicole Nguyen	nicole.n@custom-drywall-inc.com		CA		40826316	LM	Federal - WBE - Women's Business Enterprise - Legacy iSqFt value, RI - State of Rhode Island - WBE
Won't bid	Daley's Drywall	Ed Davis	ed@daleysdrywall.com	Campbell	CA	(408) 374-7626	(408) 761-2652	CN	
Will bid	Freas Plastering Co Inc	Scott Rosien	scott@freasplastering.com	Concord	CA	(925) 260-1952	(925) 260-1952		CA - State of California, DGS - SB, CA - State of California, DGS - MBE, CA - State of California, DGS - SBE, CA - CADOT - SBE, CA - State of California, DGS - SB-PW, CA - State of California, DGS - Micro SB
Will bid	J & J Acoustics Inc	Abel Leon (ITB)	abel@jjacoustics.com	San Jose	CA	(408) 275-9255	(408) 639-7301		
No Response	Keenan Hopkins Suder Stowell Contractors Inc	Rob Shimetz (SF ITB)	rob.shimetz@khsswest.com	Concord	CA	(925) 677-0828	(714) 396-4294	LM	
Won't bid	Level 5 Drywall Inc	Alan Amirteymour (ITB, Prequal)	alan@levelfivedrywall.com	San Carlos	CA	(650) 486-1657	(650) 226-5441	RS	
Will bid	Magnum Drywall	Reka Young	Reka@magnumdrywall.com	Fremont	CA	(510) 979-0420		BR	
Will bid	MGM Drywall	Sal Madrigal (ITB)	sal@mgmdrywall.com	SAN JOSE	CA	(408) 590-0596		RS	
Will bid	North Counties Drywall Inc	Estimating Department (ITB)	estimating@ncdinc.net	Sonoma	CA	(707) 996-0198			
No Response	Patrick J Ruane Inc	John Fuetsch (SF ITB)	john.fuetsch@pjrune.com	South San Francisco	CA	(650) 616-7676	(415) 596-8555	LM	CA - State of California, DGS - SB, CA - State of California, DGS - SBE, CA - CADOT - SBE, CA - State of California, DGS - SB-PW, CA - State of California, DGS - Micro SB

Will bid	Raymond Group (Northern California)	Nor Cal (SF ITB) Estimating	norcalestimating@raymondgroup.com	Martinez	CA	(925) 680-8300		NA	
No Response	RFJ Meiswinkel Company	Anthony Arciniega (ITB)	anthony@rfjmeiswinkel.com	San Francisco	CA	(415) 404-2239		LM	
No Response	Sonoma Drywall & Insulation Inc	Juan Patino	patino@sonomadrywall.net	Santa Rosa	CA	(707) 494-8035		LM	
No Response	Webcor Craft LP	David Williams (Drywall ITB)	dwilliams@webcor.com		CA		(151) 081-3749	LM	CA - Port of Oakland - LIA,CA - City of Oakland - LBE

093000.000 Tiling

5

5

5

Standing	Company	Contact	Email	City	ST	Phone	Mobile	Call	MBE
Will bid	D & J Tile Company Inc	Jaleh Dale	jaleh@djtile.com	San Carlos	CA	(650) 632-4000		BR	
Undecided	De Anza Tile Co Inc	Jeff Pettit	jeffp@deanzatile.com	Fremont	CA	(510) 933-7617		CN	
No Response	Della Maggiore Tile Co	Luis Casas	luis@dellamaggiore.com	San Jose	CA	(408) 286-3991	(408) 693-1312	CN	
Will bid	Gino Rinaldi Inc	Rogelio Barranco (Prequal)	rogeljob@rinalditileandmarble.com	Watsonville	CA	(831) 761-0195		BR	CA - State of California, DGS - SB,CA - State of California, DGS - SB-PW,CA - State of California, DGS - SB-PW
No Response	Kember Floors Inc (CA Projects Only)	MaryLou Marois	marylou@kemberinc.com		CA		(289) 804-0032	BR	
No Response	Kember Interiors Inc (All Non-CA Projects)	Maura Coulter (ITB - Cabinets)	maura@kemberinc.com	Mono	ON	(289) 804-0032	(289) 804-0032		
No Response	KZ Tile Company	Eunice Fang (SF ITB)	eunice@kztile.com	South San Francisco	CA	(650) 875-9018	(650) 875-9018	AI	CA - State of California, DGS - SB,CA - State of California, DGS - MBE,CA - State of California, DGS - SBE,CA - State of California, DGS - SB-PW,CA - State of California, DGS - SB-PW
Will bid	MGM Drywall	Sal Madrigal (ITB)	sal@mgmdrywall.com	SAN JOSE	CA	(408) 590-0596		RS	
Will bid	Premier Stone and Tile	Esau Marrero	esau@premiersandt.com		CA		(669) 304-7675	AI	
Will bid	Superior Tile & Stone	jeff young	jyoung@superiortilestone.com	San Leandro	CA	(510) 351-1700		BR	CA - Port of Oakland - LIA,CA - Port of Oakland - SBE,CA - Port of Oakland - VSBE

096400.000 Wood Flooring

2

3

Standing	Company	Contact	Email	City	ST	Phone	Mobile	Call	MBE
Will bid	Anderson Commercial Flooring	Ryan Casagrande	Ryan.Casagrande@andersoncf.com	Oakland	CA	(510) 238-9868	(510) 926-2350	BR	CA - Port of Oakland - LIA,CA - Alameda County CTC - LBE,CA - Alameda County CTC - VSLBE,CA - Alameda County CTC - SLBE,CA - City of Oakland - LBE
Will bid	Kember Floors Inc (CA Projects Only)	Joel Kember	joel@kemberfloors.com	Beaverton	MI	(289) 804-0032	(989) 598-0471	BR	
Will bid	Om3 Inc	Estimating Dept (SF ITB 1)	estimating@om3inc.com	Union City	CA	(415) 660-7073	(415) 660-7073	BR	

096500.000 Resilient Flooring

4

5

Standing	Company	Contact	Email	City	ST	Phone	Mobile	Call	MBE
Will bid	Anderson Commercial Flooring	Ryan Casagrande	Ryan.Casagrande@andersoncf.com	Oakland	CA	(510) 238-9868	(510) 926-2350	BR	CA - Port of Oakland - LIA,CA - Alameda County CTC - LBE,CA - Alameda County CTC - VSLBE,CA - Alameda County CTC - SLBE,CA - City of Oakland - LBE
Will bid	Kember Floors Inc (CA Projects Only)	Joel Kember	joel@kemberfloors.com	Beaverton	MI	(289) 804-0032	(989) 598-0471	BR	
Will bid	MGM Drywall	Sal Madrigal (ITB)	sal@mgmdrywall.com	SAN JOSE	CA	(408) 590-0596		RS	
Will bid	Om3 Inc	Estimating Dept (SF ITB 1)	estimating@om3inc.com	Union City	CA	(415) 660-7073	(415) 660-7073	BR	
Will bid	Premier Stone and Tile	Justin Krulee	justin@premiersandt.com	San Francisco	CA	(415) 970-2400		AI	

099000.000 Painting and Coating

11

2

7

4

Standing	Company	Contact	Email	City	ST	Phone	Mobile	Call	MBE
Will bid	A & B Painting Inc	Chris Westlund	chriswestlund@abptg.com	Santa Clara	CA	(408) 727-4915	(408) 593-6728	BR	Federal - MBE Hispanic - National Minority Supplier Development Council,CA - State of California, DGS - SB-PW,CA - State of California, DGS - SB-PW

No Response	D Zelinsky & Sons Inc	Jerry Van Der Hoeven (SF ITB)	jerry@dzelinskyandsons.com	Oakland	CA	(510) 215-5253	(415) 377-2894	CN	CA - Alameda County CTC - LBE,CA - Port of Oakland - LIA,CA - Alameda County CTC - SLBE,CA - Port of Oakland - SBE,CA - Supplier Clearinghouse - MBE,CA - California DOT, CALTRANS - DBE,Small Business Administration - SBA - SB,Federal - WOSB - Women-Owned Small Business,CA - City of Oakland - LBE,National Minority Supplier Development Council - NMSDC - MBE,WA - OMWBE - DBE,Federal - SDB - Small Disadvantaged Business,CA - Alameda County - SBE,CA - Alameda County - EB,CA - Alameda County - SLEB,The Supplier Clearinghouse - MBE,PA - Pennsylvania UCP - DBE,CA - CUCP, Santa Clara VTA - MWBE,CA - Los Angeles County Metropolitan Transportation Authority - DBE,CA - BART - DBE
Will bid	Darden Painting Inc	Jenni Hernandez (SF ITB)	jenni@dardenpainting.com	Concord	CA	(925) 671-9993		AI	CA - State of California, DGS - MBE,CA - State of California, DGS - SB,CA - State of California, DGS - SB-PW,CA - State of California, DGS - SB-PW,CA - CADOT - SBE,CA - State of California, DGS - Micro SB
No Response	DC Vient Inc	Chris Vient	cvient@dcvient.com	Modesto	CA	(209) 578-1224	(209) 531-7990		CA - State of California, DGS - Micro SB
Won't bid	Dimetrius Painting II Inc	Dimitrios Lignos	dimitrios@dimpainting.com	Citrus Heights	CA	(408) 210-5583			
No Response	George E Masker Inc	Dennis Gilreath (RETIRED)	dennis@maskerpainting.com	Oakland	CA	(510) 568-1206	(510) 760-2116	CN	CA - Port of Oakland - LIA,CA - City of Oakland - LBE
No Response	Giampolini & Company Inc	Maria Angeles	mangeles@giampolini.com	Emeryville	CA	(415) 673-1236		BR	
Won't bid	Jerry Thompson & Sons Inc	Luke Thompson (ITB 2)	Luke@jtspainting.com	San Rafael	CA	(415) 454-1500		DI	
No Response	Magnum Drywall	brian folgar	bfolgar@magnumdrywall.com		CA		(510) 673-1072	BR	
Will bid	MGM Drywall	Sal Madrigal (ITB)	sal@mgmdrywall.com	SAN JOSE	CA	(408) 590-0596		RS	
No Response	Turman Commercial Painters	Steve Blakley	sblakley@turmaninc.com	Manteca	CA	(800) 455-9091	(925) 570-1947	CN	
Will bid	Valdez Painting Inc	Gino Valdez (ITB)	gino@valdezpainting.net	Sacramento	CA	(916) 454-2243		BR	Federal - SB - Small Business Enterprise,Federal - SDB - Small Disadvantaged Business,Federal - WOSB - Women-Owned Small Business,Federal - MBE Hispanic - National Minority Supplier Development Council,CA - California Department of Industrial Relations - CADIR,CA - State of California, DGS - SB,National Minority Supplier Development Council,CA - State of California, DGS - MBE,National Minority Supplier Development Council - NMSDC - MBE,CA - CADOT - SBE,CA - State of California, DGS - Micro SB
No Response	Valdez Plastering, Inc.	Karim Garibay	kgaribay@vpi.net		CA		(916) 454-2243	LM	

101400.000 Signage



Standing	Company	Contact	Email	City	ST	Phone	Mobile	Call	MBE
Will bid	Arrow Sign Company	Joseph Menzel (ITB, Prequal)	jmenzel@arrowsigncompany.com	Oakland	CA	(510) 533-7693		AI	CA - Alameda County CTC - LBE,CA - State of California, DGS - SB
Won't bid	Garnett Sign Studio	Lori Fraenza	lorif@garnettsigns.com	South San Francisco	CA	(650) 871-9518	(650) 871-9518		
Will bid	Golden Gate Sign Company	Erik Karlsrud	erik@goldengatesign.com	Concord	CA	(925) 771-6358		BR	
No Response	Illuminated Creations Inc dba Ellis & Ellis Sign Systems	Eric Borges	eborges@ellissigns.com	Sacramento	CA	(916) 924-1936		LM	CA - State of California, DGS - MBE,CA - State of California, DGS - SB,CA - State of California, DGS - SBE,CA - CADOT - SBE,CA - State of California, DGS - SB-PW,CA - State of California, DGS - Micro SB
Will bid	Martinelli Environmental Graphics	Jack Martinelli	jack@martinelli-graphics.com	San Francisco	CA	(415) 468-4000		BR	CA - City and County of San Francisco - OBE,CA - City and County of San Francisco - WBE,CA - City and County of San Francisco - LBE

Will bid	Priority Architectural Graphics	Estimating Department (SF ITB)	sales@prioritygraphics.com	san francisco	CA	(415) 643-1144		BR	CA - CUCP, San Francisco MTA - DBE ,CA - City and County of San Francisco - WBE,CA - BART - WBE,CA - BART - MBE,CA - State of California, DGS - SB,CA - State of California, DGS - SBE,CA - CADOT - SBE,CA - State of California, DGS - SB-PW,CA - State of California, DGS - SB-PW,CA - City and County of San Francisco - LBE,CA - State of California, DGS - Micro SB
Undecided	SignCraft Architectural Signage	Scott Becerra (ITB)	scott@thinksigncraft.com	San Jose	CA	(408) 885-9900	(510) 316-9147	UN	
Won't bid	VOMAR	Shimaal Carrim	shimaal@vomarproducts.com		CA		(818) 610-5115	DI	
No Response	Vomar Products Inc	John Barmaan (SF ITB)	johnbarmaan@vomarproducts.com	Canoga Park	CA	(818) 610-5115	(310) 569-3738	RS	CA - Port of Los Angeles - SBE,CA - Port of Long Beach - SBE,CA - CUCP, Santa Clara VTA - SBE,CA - Port of Long Beach - VSBE,CA - CUCP, Santa Clara VTA - MWBE,CA - Port of Los Angeles - VSBE,PA - Pennsylvania DOT - SBE
No Response	Weidner Architectural Signage/House of Signs Inc dba WeidnerCA	Arie korver ITB	ariel@weidnerca.com	Sacramento	CA	(916) 452-8000		CN	

102213.000 Wire Mesh Partitions **2**

Standing	Company	Contact	Email	City	ST	Phone	Mobile	Call	MBE
No Response	Acorn Wire & Iron	Laura Reyes	lreyes@acornwire.com	Chicago	IL	(312) 243-6414			
No Response	California Wire Products Corp	Darren Murray	darren@cawire.com	Corona	CA	(951) 371-7730			
No Response	Stumbaugh & Associates Inc	Michael Eubling	meubling@stumbaugh.com	Burbank	CA	(818) 240-1627			

102800.000 Toilet, Bath, and Laundry Accessories **7**

Standing	Company	Contact	Email	City	ST	Phone	Mobile	Call	MBE
No Response	ASI Global Partitions	Bill Glaser (SF ITB)	bglaser@specialtiesdirect.com	Oakland	CA	(510) 652-2060	(415) 900-8276	CN	
No Response	ASI West	Cristian Arellano	carellano@specialtiesdirect.com	Tecate	BC	(665) 655-7777			
Will bid	BathXcessories	Ken Spoor (Prequal, All ITBs)	kspoor@bathxcessories.com	Northbrook	IL	(312) 951-2885	(312) 720-6049	BR	
No Response	Construction Specialties Inc	Mauricio Cervantez	mcervantez@csgroup.com	Del Rio	TX	(908) 849-4700			
Will bid	Creative Shower Door Corp	Luke Hebert (ITB)	luke@creativeshowerdoor.com	Fremont	CA	(510) 552-7706	(510) 623-9000	BR	
Will bid	Global Specialties Direct Inc	Estimating Department (SF ITB)	SacramentoEstimating@specialtiesdirect.com	Oakland	CA	(510) 652-2060		BR	
No Response	Nor Cal Specialties Inc	Greg Merrill	greg@nor-calinc.com	San Jose	CA	(408) 487-9191		CN	
No Response	Rebarber Enterprises Inc	Stephen Hawkins (ITB 1)	stephen@rebarber.net	South San Francisco	CA	(650) 266-4577		CN	
No Response	SDI Mardale Specialties Direct Inc	Nancy Shipley (CA Prequal)	nshipley@specialtiesdirect.com			(562) 550-1395			
Will bid	Specialties Etc Corp	Dee Reynolds (ITB, Prequal)	SPECETC@AOL.COM	San Francisco	CA	(415) 309-8476	(415) 309-8476	BR	CA - City and County of San Francisco - WBE,CA - City and County of San Francisco - LBE

103100.000 Manufactured Fireplaces **3**

Standing	Company	Contact	Email	City	ST	Phone	Mobile	Call	MBE
Will bid	Blaze Fireplaces of N Cal Co	Rob Fredericks (ITB)	rob@blazefireplaces.com	San Francisco	CA	(415) 495-2002	(415) 683-7439	BR	
No Response	Earthcore Industries, LLC	Brian Young (ITB)	byoung@isokern.net	Glendale	AZ		(757) 816-2775	CN	
Will bid	The Energy House	Frank Fano (ITB)	frank@energy-house.com	San Carlos	CA	(650) 593-1496		BR	

104400.000 Fire Protection Specialties **6**

Standing	Company	Contact	Email	City	ST	Phone	Mobile	Call	MBE
Will bid	BathXcessories	Ken Spoor (Prequal, All ITBs)	kspoor@bathxcessories.com	Northbrook	IL	(312) 951-2885	(312) 720-6049	BR	

No Response	Division 10 Sales	Chris Long (SF ITB)	clong@division10sales.com	Ogden	UT	(801) 821-2548		LM	Federal - VOSB - Veteran Owned Small Business
Undecided	DLR Sales Inc	Don Reierson (SF ITB 2)	donr@dlrsales.com	Campbell	CA	(408) 988-1294		UN	
Will bid	Global Specialties Direct Inc	Estimating Department (SF ITB)	SacramentoEstimating@specialtiesdirect.com	Oakland	CA	(510) 652-2060		BR	
Will bid	Mobile Fire Extinguisher Inc	Marla Jarvis (SF ITB)	marla@mobilefire.net		CA	(800) 747-8467		BR	CA - State of California, DGS - MBE,CA - CADOT - SBE,CA - State of California, DGS - Micro SB,CA - State of California, DGS - SB
No Response	Rebarber Enterprises Inc	Estimating Department (ITB 2)	estimating@rebarber.net	So. San Francisco	CA	(650) 589-0713		CN	

105500.000 Postal Specialties 7 5 3

Standing	Company	Contact	Email	City	ST	Phone	Mobile	Call	MBE
No Response	American Mailboxes USA	Inger Hewitt	mailboxes@americanmailboxesusa.com	Frisco	TX	(214) 469-2379	(469) 919-3281	CN	
No Response	BathXcessories	Angela McJunkin	angie@bathxcessories.com	Northbrook	IL	(312) 685-2710	(312) 685-2710	BR	
No Response	Division 10 Sales	Quentin Whitaker (ITB)	qwhitaker@division10sales.com	Concord	NC	(704) 644-5913		LM	Federal - VOSB - Veteran Owned Small Business
Will bid	Global Specialties Direct Inc	Estimating Department (SF ITB)	SacramentoEstimating@specialtiesdirect.com	Oakland	CA	(510) 652-2060		BR	
No Response	Package Concierge	Ali Byrne (SF ITB)	allison.byrne@packageconcierge.com		CA	(508) 688-4678	(508) 688-4678	CN	
Will bid	Specialties Etc Corp	Dee Reynolds (ITB, Prequal)	SPECETC@AOL.COM	San Francisco	CA	(415) 309-8476	(415) 309-8476	BR	CA - City and County of San Francisco - WBE,CA - City and County of San Francisco - LBE
No Response	Specialties Etc Corp (Factory Only)	Amber Elwell	Amber_elwell@yahoo.com						
Will bid	US Mail Supply Inc	Linda Edenharder	linda@usmailsupply.com	Waukesha	WI	(262) 782-6510		AI	

111200.000 Parking Control Equipment 4 1 2 1

Standing	Company	Contact	Email	City	ST	Phone	Mobile	Call	MBE
Will bid	A & D Automatic Gate and Access	Jeff Bunker (SF All ITBs / Prequal)	jeffb@adautogate.com	Redwood City	CA	(650) 222-0516	(650) 222-1678	AI	
No Response	Amano McGann Inc	Sabrina Grubidge (All Suffolk ITBs)	marketing@amanomcgann.com	Roseville	MN	(612) 331-2020		LM	
Won't bid	McKinley Equipment Corporation	Greg Larsen (ITB)	greg.larsen@mckinleyequipment.com	Irvine	CA	(949) 261-9222	(949) 683-6223	DI	
Undecided	William D White Co Inc	Don White	donwhite@wmdwhiteco.com	Oakland	CA	(510) 658-8167	(510) 867-0231	BR	

113000.000 Residential Equipment 1 1

Standing	Company	Contact	Email	City	ST	Phone	Mobile	Call	MBE
Will bid	R & B Wholesale Distributors Inc	Tucker Thurman	tucker.thurman@rbdistributors.com	Ontario	CA		(415) 471-8173	BR	

118123.000 Facade Access Equipment 1 1

Standing	Company	Contact	Email	City	ST	Phone	Mobile	Call	MBE
Will bid	Access Systems & Solutions Inc dba Scaffold Inspection and Testing Company	Joan DeJesus (SF ITB)	joan@sit-co.com	South San Francisco	CA	(650) 588-4626			CA - State of California, DGS - SB,CA - State of California, DGS - MBE,CA - State of California, DGS - SBE,CA - CADOT - SBE,CA - State of California, DGS - SB-PW

123200.000 Manufactured Wood Casework 4 2 2

Standing	Company	Contact	Email	City	ST	Phone	Mobile	Call	MBE
Will bid	Om3 Inc	Estimating Dept (SF ITB 1)	estimating@om3inc.com	Union City	CA	(415) 660-7073	(415) 660-7073	BR	
Will bid	Sozo Studio	Cynthia Miyashita (Prequal)	cynthia@sozostudio.com	San Francisco	CA	(415) 431-7000	(415) 609-1053	AI	CA - State of California, DGS - MBE,CA - City and County of San Francisco - MBE,CA - CADOT - SBE,CA - State of California, DGS - Micro SB,CA - State of California, DGS - SB,CA - City and County of San Francisco - LBE

No Response	Sullivan Construction Co Inc	Jerry Sullivan (SF ITB 1)	jpsullivan44@aol.com	Concord	CA	(925) 689-2177	(916) 548-9035	AI	CA - State of California, DGS - MBE,CA - State of California, DGS - SB,CA - State of California, DGS - SBE,CA - CADOT - SBE,CA - State of California, DGS - SB-PW,CA - State of California, DGS - Micro SB
-------------	------------------------------	---------------------------	----------------------	---------	----	----------------	----------------	----	--

No Response	VT Industries Inc	Justin Cruise	schatzer2016@gmail.com	La Mirada	CA	(714) 521-2167			
-------------	-------------------	---------------	------------------------	-----------	----	----------------	--	--	--

123200.001 Manufactured Casework (Install) 0 1

Standing	Company	Contact	Email	City	ST	Phone	Mobile	Call	MBE
No Response	Om3 Inc	Craig Fuller (SF ITB 2)	craig@om3inc.com	Union City	CA	(415) 660-7073	(510) 320-2546	BR	

123200.002 Manufactured Casework (Supply) 1 1

Standing	Company	Contact	Email	City	ST	Phone	Mobile	Call	MBE
Will bid	Sozo Studio	Cynthia Miyashita (Prequal)	cynthia@sozostudio.com	San Francisco	CA	(415) 431-7000	(415) 609-1053	AI	CA - State of California, DGS - MBE,CA - City and County of San Francisco - MBE,CA - CADOT - SBE,CA - State of California, DGS - Micro SB,CA - State of California, DGS - SB,CA - City and County of San Francisco - LBE

123600.000 Countertops 10 1 7 3

Standing	Company	Contact	Email	City	ST	Phone	Mobile	Call	MBE
No Response	Belstone Products	Clyde Fralick	clyde@belstoneproducts.com	Van Nuys	CA	(818) 373-4900			
Will bid	D & J Tile Company Inc	Tyler Moisan (no longer w/co)	tyler@djtile.com	San Carlos	CA	(650) 632-4000		BR	
Undecided	De Anza Tile Co Inc	Rich Papapietro	rich@deanzatile.com	Fremont	CA	(510) 933-7600		CN	
No Response	Della Maggiore Tile Co	Luis Casas	luis@dellamaggiore.com	San Jose	CA	(408) 286-3991	(408) 693-1312	CN	
Will bid	Gino Rinaldi Inc	Jeremy Briscoe	jeremyb@rinalditileandmarble.com	Watsonville	CA	(831) 761-0195		BR	CA - State of California, DGS - SB,CA - State of California, DGS - SB-PW,CA - State of California, DGS - SB-PW
Will bid	Premier Stone and Tile	Justin Krulee	justin@premiersandt.com	San Francisco	CA	(415) 970-2400		AI	
Won't bid	Stone Etc Inc	Shiran Daskal	shiran@stoneetcinc.com	Gardena	CA	(310) 508-1528		DI	
No Response	Superior Tile & Stone	Robert Herman (ITB)	rherman@superiortileandmarble.com	Salt Lake City	UT	(702) 798-7882	(702) 303-7600	BR	CA - Port of Oakland - LIA,CA - Port of Oakland - SBE,CA - Port of Oakland - VSBE
No Response	Take It For Granite	Jason Krulee	jason@tifgranite.com	San Jose	CA	(408) 790-2812	(408) 971-8434		
No Response	VT Industries Inc	Justin Cruise	schatzer2016@gmail.com	La Mirada	CA	(714) 521-2167			
No Response	ZMI Stone Inc	Rob Madahar	rmadahar@zmistone.com	San Leandro	CA	(925) 639-9321			

131100.000 Swimming Pools 1 1

Standing	Company	Contact	Email	City	ST	Phone	Mobile	Call	MBE
No Response	Waterworks Industries Inc	Mathais Toupin	mathais@waterworksindustries.com	San Francisco	CA	(707) 837-7900	(707) 888-8777		CA - State of California, DGS - MBE,CA - State of California, DGS - SB,CA - State of California, DGS - SBE

142000.000 Elevators 3 2 2

Standing	Company	Contact	Email	City	ST	Phone	Mobile	Call	MBE
No Response	Kone Elevators	Clayton Mack (ITB NORCAL)	clay.mack@kone.com	San Leandro	CA	(510) 351-5141	(510) 714-9060	AI	CA - SD Airport - LBE
Will bid	Otis Elevator Company	Laura Pederson (SF ITB)	laura.pederson@otis.com	San Francisco	CA	(503) 547-5349	(503) 547-5349	CN	
No Response	Schindler Elevator Corporation	Callum Boyd (ITB SF)	callum.boyd@schindler.com	San Leandro	CA	(510) 225-5511	(510) 225-5511	CN	CT - Connecticut DAS Prequalification - \$500K
Will bid	TK Elevator Corporation	Tom Franco (NorCal, SF/South Bay ITB))	tom.franco@tkelevator.com	San Leandro	CA	(510) 972-7721	(510) 755-0248	AI	

149100.000 Facility Chutes 7 4 4

Standing	Company	Contact	Email	City	ST	Phone	Mobile	Call	MBE
No Response	American Trash Management	Karen Troth (ITB)	quotes@trashmanage.com	Emeryville	CA	(415) 292-5400		RS	CA - Port of Oakland - LIA
Will bid	Bay Area Trash Compactor	Mike Welden	mike@BATC-Compacts.com	Walnut Creek	CA	(925) 465-5133		BR	CA - State of California, DGS - Micro SB,CA - State of California, DGS - SB,CA - State of California, DGS - SB-PW,CA - State of California, DGS - SB-PW,CA - CADOT - SBE
No Response	Chute Pros	Jack Galvin	jackg@chutepros.com	Mission Viejo	CA	(949) 337-2314	(949) 582-1742	RS	
No Response	Chute Systems	Ms. Dion Whitaker (Prequal)	dion@chutesystems.com	Perris	CA	(951) 443-2800		RS	
Will bid	Chutes International	Sales Department (ITBs & PQ)	sales@chutes.com	Waldorf	MD	(240) 448-5000			
Will bid	Compactor Management Company, LLC	Ken Truong	estimating@compactormc.com		CA		(510) 788-8802	BR	
Will bid	Specialties Etc Corp	Dee Reynolds (ITB, Prequal)	SPECETC@AOL.COM	San Francisco	CA	(415) 309-8476	(415) 309-8476	BR	CA - City and County of San Francisco - WBE,CA - City and County of San Francisco - LBE
No Response	Specialties Etc Corp (Factory Only)	Amber Elwell	Amber_elwell@yahoo.com						

210000.000 Fire Suppression **2**

Standing	Company	Contact	Email	City	ST	Phone	Mobile	Call	MBE
Will bid	RCM Fire Protection Inc	Ali - MAIN SF CONTACT Namdar	anamdar@rcmfire.com	Tracy	CA	(209) 833-8228	(510) 299-3473		CA - State of California, DGS - SB,CA - State of California, DGS - MBE,CA - State of California, DGS - Micro SB,CA - State of California, DGS - SBE,CA - CADOT - SBE,CA - State of California, DGS - SB-PW
Will bid	Striping Graphics	Tony Lane	tony@stripinggraphics.com	Cotati	CA	(707) 793-9425		BR	

220000.000 Plumbing **1**

Standing	Company	Contact	Email	City	ST	Phone	Mobile	Call	MBE
Will bid	Broadway Mechanical Contractors Inc	Ken Nurisso	knurisso@broadwaymechanical.com	Oakland	CA	(510) 746-4035			CA - Port of Oakland - LIA
Not Invited	California Solar Integrators Inc	Stephen O'Leary (SF ITB)	stephen@catsolarinc.com	Los Angeles	CA	(707) 529-2738	(707) 529-2738		CA - State of California, DGS - MBE,CA - State of California, DGS - SB,CA - State of California, DGS - SBE,CA - CADOT - SBE,CA - State of California, DGS - SB-PW,CA - State of California, DGS - SB-PW

230000.000 Heating, Ventilating, and Air Conditioning (HVAC) **3**

Standing	Company	Contact	Email	City	ST	Phone	Mobile	Call	MBE
No Response	Air Systems Inc	Matthew Loewenstein	matt.loewensteinjr@airsystemsinc.com	San Jose	CA	(408) 918-1376	(408) 203-2777		
No Response	Bay City Mechanical Inc	John Swahn (RETIRED)	john@baycitymech.com	Richmond	CA	(510) 233-7000	(510) 815-1876		
Will bid	NV Heathorn Co	Steve Hirst	shirst@nvheathorn.com	Concord	CA	(510) 569-9100			
No Response	Ocean Park Mechanical Inc	Anthony Rud (SF ITB)	Anthony@oceanpm.com	Seattle	WA	(206) 674-4553			

260000.000 Electrical **1**

Standing	Company	Contact	Email	City	ST	Phone	Mobile	Call	MBE
Not Invited	California Solar Integrators Inc	Stephen O'Leary (SF ITB)	stephen@catsolarinc.com	Los Angeles	CA	(707) 529-2738	(707) 529-2738		CA - State of California, DGS - MBE,CA - State of California, DGS - SB,CA - State of California, DGS - SBE,CA - CADOT - SBE,CA - State of California, DGS - SB-PW,CA - State of California, DGS - SB-PW
Will bid	Edward W Scott Electric Co Inc	Mo De Leon	mdeleon@scottelectric.com	Richmond	CA	(415) 206-7120			
No Response	Phoenix Electric Company	Eugene Briody (Prequal)	ebriody@peccsf.com	San Francisco	CA	(415) 509-9272	(415) 509-9272		CA - State of California, DGS - SB,CA - BART - WBE,CA - BART - MBE,CA - City and County of San Francisco - MBE
Will bid	Striping Graphics	Tony Lane	tony@stripinggraphics.com	Cotati	CA	(707) 793-9425		BR	

260000.001 Permanent Power Set & Connect **0**

Standing	Company	Contact	Email	City	ST	Phone	Mobile	Call	MBE
No Response	Phoenix Electric Company	Eugene Briody (Prequal)	ebriody@pecsf.com	San Francisco	CA	(415) 509-9272	(415) 509-9272		CA - State of California, DGS - SB,CA - BART - WBE,CA - BART - MBE,CA - City and County of San Francisco - MBE
263300.000 Battery Equipment				1	1				
Will bid	California Solar Integrators Inc	Stephen O'Leary (SF ITB)	stephen@calsolarinc.com	Los Angeles	CA	(707) 529-2738	(707) 529-2738		CA - State of California, DGS - MBE,CA - State of California, DGS - SB,CA - State of California, DGS - SBE,CA - CADOT - SBE,CA - State of California, DGS - SB-PW,CA - State of California, DGS - SB-PW
310000.000 Earthwork				8	10				5
No Response	A & B Construction Inc	Rami El Khoury (ITB 3)	rami@abconstruction.net	Berkeley	CA	(510) 999-6000	(415) 726-3003		CA - Port of Oakland - LBA,CA - City of Oakland - LBE,CA - Port of Oakland - LIA
No Response	D-Line Constructors	Abel Canlas	abel@dlineconstructors.com		CA		(510) 947-7184		CA - BART - DBE,CA - State of California, DGS - SB,CA - Port of Oakland - LIA,CA - Port of Oakland - SBE,CA - Port of Oakland - VSBE,Federal - 8 - a - Section 8 - a Certified,CA - BART - MSBE,CA - BART - SBE,CA - Alameda County CTC - SLBE,CA - Alameda County CTC - LBE,CA - BART - MBE,CA - BART - WBE,CA - State of California, DGS - MBE,CA - State of California, DGS - SBE,CA - Alameda County CTC - VSLBE,CA - Alameda County - SBE,CA - Alameda County - EB,CA - Alameda County - SLEB,CA - State of California, DGS - SB-PW,CA - City of Oakland - LBE,CA - State of California, DGS - SB-PW,CA - City of Oakland - SLBE
Will bid	DeSilva Gates Construction	anita sahaugun	asahaugun@desilvagates.com	Dublin	CA	(925) 829-9220			
Will bid	Evans Brothers Inc	Greg Fulton (SF ITB)	gregf@evansbrothers.com	Livermore	CA	(925) 443-0225	(925) 383-8727		CA - Port of Oakland - LBA
No Response	Ferma Corporation	Raul Rangel	rrangel@fermacorp.com		CA		(650) 452-3125		
No Response	Granite Excavation & Demolition	Erwin O'Toole	erwinotoole@granitesf.com	South San Francisco	CA	(650) 737-8700	(415) 531-1009		
Will bid	Ground Control Inc	Jae Shin	jae@groundci.com	San Francisco	CA	(415) 508-8589	(209) 985-2177		CA - State of California, DGS - SB,CA - City and County of San Francisco - MBE,CA - State of California, DGS - MBE,CA - State of California, DGS - SB-PW,CA - CADOT - DBE,CA - CADOT - DBE,CA - State of California, DGS - SB-PW,CA - Los Angeles County Metropolitan Transportation Authority - DBE,CA - State of California, DGS - Micro SB,CA - CUCP, Santa Clara VTA - MWBE,CA - Port of Long Beach - DBE,CA - Metropolitan Water District of Southern California - DBE,CA - State of California, DGS - DVBE,CA - BART - DBE,CA - California DOT, CALTRANS - DBE,CA - City and County of San Francisco - LBE,CA - CUCP, City of Fresno - DBE,CA - CUCP, San Francisco MTA - DBE ,CA - CUCP, San Mateo SAMTRANS - DBE,CA - METRO LA County MTA - DBE,CA - CADOT - SBE,CA - CUCP, METRO/LA County MTA - DBE,CA - Yolo County Transportation District - DBE,CA - CUCP, Santa Clara VTA - DBE
No Response	Interstate Grading & Paving	Ryan Barrett (SF ITB)	ryan@igpinc.com	South San Francisco	CA	(650) 952-7333			
Will bid	Interstate Grading & Paving Inc	Gary Polson	gary@igpinc.com	South San Francisco	CA	(650) 952-7333		CN	

No Response	Marinship Development Interest LLC	Sal Villarreal	sal@marinship.com	SAN FRANCISCO	CA	(415) 282-5160	(415) 852-1752			CA - California DOT, CALTRANS - DBE,CA - BART - DBE,CA - State of California, DGS - SB,CA - City and County of San Francisco - MBE,CA - CUCP, San Francisco MTA - DBE ,CA - State of California, DGS - SBE,CA - CADOT - SBE,CA - State of California, DGS - SB-PW,CA - Los Angeles County Metropolitan Transportation Authority - DBE,CA - Alameda County - SBE,CA - Alameda County - SLEB,CA - City of Oakland - LBE,CA - CADOT - DBE,CA - CADOT - DBE,CA - Port of Long Beach - DBE,CA - Alameda County CTC - LBE,CA - Alameda County CTC - SLBE,CA - Port of Oakland - LIA,CA - Port of Oakland - SBE,CA - Metropolitan Water District of Southern California - DBE,CA - State of California, DGS - DVBE,CA - Alameda County CTC - VSLBE,CA - CADOT - SMBE,CA - City and County of San Francisco - LBE,CA - CUCP, City of Fresno - DBE,CA - CUCP, San Mateo SAMTRANS - DBE,CA - METRO LA County MTA - DBE,CA - CUCP, METRO/LA County MTA - DBE,CA - Yolo County Transportation District - DBE,CA - CUCP, Santa Clara VTA - DBE,CA - State of California, DGS - Micro SB
-------------	------------------------------------	----------------	-------------------	---------------	----	----------------	----------------	--	--	--

Will bid	Silverado Contractors	Ally Saetern (SF ITB)	bids@silveradocontractors.com	Oakland	CA	(510) 658-9960				CA - City of Oakland - LBE,CA - Port of Oakland - LIA,CA - Alameda County CTC - LBE,CA - Alameda County CTC - SLBE,CA - Alameda County CTC - VSLBE
No Response	Take It For Granite	Marcos Castaneda	marcos@tifgranite.com	san jose	CA	(408) 971-8434				
No Response	Take it for Granite	Chance O'Brien	chanceob360@gmail.com		CA		(408) 881-4828			
No Response	Take it for Granite	Chris C	chris@tifgranite.com		CA		(408) 971-8434			
No Response	Talus Construction Inc	Matthew Robertson (ITB)	matt@teamtalus.com	Lathrop	CA	(510) 583-0002				

312319.000 Dewatering **2**

Standing	Company	Contact	Email	City	ST	Phone	Mobile	Call	MBE
Will bid	Clear Water Services	Ronald Rinehart	rkrinehart@clearcreekstems.com	Livermore	CA	(925) 273-9900	(916) 990-4601		
Will bid	Malcolm Drilling Company Inc	Jason Malcolm (SF ITB)	jasonmalcolm@malcolmdrilling.com	Hayward	CA	(510) 780-9181			CA - Port of Oakland - LBA,CA - SD Airport - LBE

314000.000 Shoring and Underpinning **0**

Standing	Company	Contact	Email	City	ST	Phone	Mobile	Call	MBE
Will bid	Malcolm Drilling Company Inc	Alexandra Hernandez (SF ITB 2)	ahernandez@malcolmdrilling.com	Hayward	CA	(510) 780-9181			CA - Port of Oakland - LBA,CA - SD Airport - LBE

321400.000 Unit Paving **8**

Standing	Company	Contact	Email	City	ST	Phone	Mobile	Call	MBE
Undecided	Decorative paving, Inc.	Larry Mardock	larry@decorativepavers.com	San Jose, Ca.	CA	(408) 284-5440		CN	
Undecided	Egglil Landscape Contractors Inc	Estimating Department	admin@egglilandscape.com	Menlo Park	CA	(650) 369-0303		LM	Federal - SDB - Small Disadvantaged Business,Federal - SB - Small Business Enterprise,CA - State of California, DGS - SB,CA - State of California, DGS - SBE,CA - CADOT - SBE,CA - State of California, DGS - SB-PW,CA - State of California, DGS - Micro SB
Will bid	European Paving Designs	Estimating Department (SF ITB)	estimating@epdpavers.com	San Jose	CA	(408) 283-5233		LM	
No Response	Paver Decor	Jacob Beltran	jbeltran@paverdecor.com		CA		(951) 295-3163		
Will bid	Paver Decor Masonry Inc	Limor Moore (ITB)	lmoore@paverdecor.com	Los Angeles	CA	(818) 284-9236	(818) 284-9236	AI	CA - State of California, DGS - MBE

No Response	QLM Inc	Kenny Nguyen	kenny.nguyen@qlm-inc.com	San Jose	CA	(408) 265-0904		AI	CA - CUCP, Santa Clara VTA - SBE,CA - State of California, DGS - SB,CA - BART - MSBE,CO - Regional Transportation District - SBE,CA - BART - SBE,CA - State of California, DGS - MBE,PA - Pennsylvania DOT - SBE
Will bid	Shooter & Butts Inc	Israel Deluna	ideluna@shooterandbutts.com	Pleasanton	CA	(925) 460-5155		CN	CA - State of California, DGS - SB,CA - City and County of San Francisco - OBE,CA - Alameda County CTC - LBE,CA - City and County of San Francisco - WBE
Will bid	Striping Graphics	Tony Lane	tony@stripinggraphics.com	Cotati	CA	(707) 793-9425		BR	
No Response	The Lawson Roofing Co Inc	Joseph Lawson	j_lawson@lawsonroofing.com	San Francisco	CA	(415) 285-1661	(415) 285-1661	LM	

321700.000 Paving Specialties



Standing	Company	Contact	Email	City	ST	Phone	Mobile	Call	MBE
No Response	CEE GEE Parking Lot Striping Inc	Dan Puma	cg@cgstriping.com	Campbell	CA	(408) 370-3478	(408) 761-3594	LM	
Will bid	Compass Engineering Contractors Inc	Mike Moore	estimating@compassec.com	Hayward	CA	(510) 264-0235	(415) 760-8653	BR	Federal - SDB - Small Disadvantaged Business,CA - CUCP, Santa Clara VTA - SBE,CA - State of California, DGS - MBE,CA - State of California, DGS - SB,CA - State of California, DGS - Micro SB,CA - CADOT - SBE
No Response	Diablo Striping & Sealcoating	andrew thelwell	andrew@diablostriping.com	Concord	CA	(925) 262-3001	(925) 262-3001		CA - State of California, DGS - MBE,CA - State of California, DGS - Micro SB,CA - State of California, DGS - SB,CA - CADOT - SBE
Won't bid	Quality Striping	Teri Seright	qualitystriping@comcast.net	San mateo	CA	(650) 577-0406		DI	Federal - WOSB - Women-Owned Small Business,The Supplier Clearinghouse - WBE,CA - Supplier Clearinghouse - WBE
Will bid	Striping Graphics	Tony Lane	tony@stripinggraphics.com	Cotati	CA	(707) 793-9425		BR	
Won't bid	Tri-Valley Striping	George DeBoever	georged@trivalleystriping.com	Pleasant Hill	CA	(925) 787-1003	(925) 324-0982	DI	

323300.000 Site Furnishings



Standing	Company	Contact	Email	City	ST	Phone	Mobile	Call	MBE
Will bid	Advanced Integrated Pest Management	Randy Kopf (ITB)	rzopf@advancedipm.com	Roseville	CA	(916) 257-5481			
Will bid	Dero Bike Rack Company	Peter Lemieux	peter.lemieux@dero.com	San Francisco	CA	(415) 425-7562			
Undecided	Egglil Landscape Contractors Inc	Kara Haugen	KHaugen@egglilandscaping.com	Menlo Park	CA	(650) 369-0303		LM	Federal - SDB - Small Disadvantaged Business,Federal - SB - Small Business Enterprise,CA - State of California, DGS - SB,CA - State of California, DGS - SBE,CA - CADOT - SBE,CA - State of California, DGS - SB-PW,CA - State of California, DGS - Micro SB
No Response	Landscape Forms	Rebecca Casey (SF ITB)	rebecca@landscapeforms.com	Miami	FL	(800) 430-6206			
Will bid	Marina Landscaping	Jonathan Lundell	jlundell@marinaco.com		CA	(714) 939-6600	(817) 832-0667	LM	
No Response	QLM Inc	Quoc Nguyen	quoc.nguyen@qlm-inc.com	San Jose	CA	(408) 265-0904		AI	CA - CUCP, Santa Clara VTA - SBE,CA - State of California, DGS - SB,CA - BART - MSBE,CO - Regional Transportation District - SBE,CA - BART - SBE,CA - State of California, DGS - MBE,PA - Pennsylvania DOT - SBE
No Response	Saris Cycling Group	Peter Lewis	plewis@saris.com		WI		(608) 515-5148		
Will bid	Saris Infrastructure	Estimating Department	sales@sarisinfrastructure.com	Madison	WI	(608) 515-5148		AI	
Will bid	Shooter & Butts Inc	Israel Deluna	ideluna@shooterandbutts.com	Pleasanton	CA	(925) 460-5155		CN	CA - State of California, DGS - SB,CA - City and County of San Francisco - OBE,CA - Alameda County CTC - LBE,CA - City and County of San Francisco - WBE
No Response	Tournesol Siteworks LLC	Pamela Hernandez	phernandez@tournesol.com	UNION CITY	CA	(800) 542-2282		LM	TX - TxDOT - SBE
No Response	Yard Art	Jason Levine	jason@yardart.net	El Dorado Hills	CA	(925) 234-3153		AI	

329000.000 Planting

8



Standing	Company	Contact	Email	City	ST	Phone	Mobile	Call	MBE
Undecided	Bauman Landscape Inc	Estimating Department	estimating@baumanland.com	San Francisco	CA	(415) 447-4800		DI	
Won't bid	BrightView Landscape Development Inc	Skip Stevens (SF, ITBs)	skip.stevens@brightview.com	Pleasanton	CA	(925) 463-0700	(925) 580-2700	LM	
Will bid	Eggli Landscape Contractors Inc	Kara Haugen	KHaugen@eggli landscap e.com	Menlo Park	CA	(650) 369-0303		LM	Federal - SDB - Small Disadvantaged Business, Federal - SB - Small Business Enterprise, CA - State of California, DGS - SB, CA - State of California, DGS - SBE, CA - CADOT - SBE, CA - State of California, DGS - SB-PW, CA - State of California, DGS - Micro SB
No Response	Land Forms Landscape Construction	Mark Haase	Markh@landscapeforms.com	Kalamazoo	MI	(269) 337-1065			
No Response	Landscape Forms	Alex Tipton	alext@landscapeforms.com		MI		(269) 337-1219		
Will bid	Marina Landscaping	Charmaine Tyrrell	ctyrrell@marinaco.com	Lathrop	CA	(209) 981-9558		LM	
Undecided	McGuire and Hester	Mabel Cater (ITB)	mcater@mcguireandhes ter.com	Alameda	CA	(510) 632-7676		DI	CA - Alameda County CTC - LBE, CA - Port of Oakland - LIA, CA - Alameda County CTC - VSLBE, CA - Alameda County CTC - SLBE, CA - City of Oakland - LBE
Won't bid	Park West Landscape Inc	Kevin Hanes (SF ITB)	khanes@parkwestinc.co m	San Jose	CA	(925) 361-4900	(510) 203-6719	LM	
Undecided	QLM Inc	Anand Bonthu	anand.bonthu@qlm-inc.com		CA		(408) 265-0904	AI	CA - CUCP, Santa Clara VTA - SBE, CA - State of California, DGS - SB, CA - BART - MSBE, CO - Regional Transportation District - SBE, CA - BART - SBE, CA - State of California, DGS - MBE, PA - Pennsylvania DOT - SBE
Won't bid	RMT Landscape Contractors	Rick DeHerrera	rick@rmtlandscape.com	Oakland	CA	(510) 568-3208	(510) 715-0127	CN	CA - California Department of Industrial Relations - CADIR, CA - City of Oakland - LBE, CA - Port of Oakland - LIA, CA - California DOT, CALTRANS - DBE, CA - Alameda County - SBE, CA - Alameda County CTC - SLBE
Will bid	Shooter & Butts Inc	Israel Deluna	ideluna@shooterandbutt s.com	Pleasanton	CA	(925) 460-5155		CN	CA - State of California, DGS - SB, CA - City and County of San Francisco - OBE, CA - Alameda County CTC - LBE, CA - City and County of San Francisco - WBE

----- **UNASSIGNED**

2

Standing	Company	Contact	Email	City	ST	Phone	Mobile	Call	MBE
No Response	1	Taryn Jessen	jessent@my.canisius.edu						
No Response	Guzman Construction Group Inc	David Kramer	dkramer@guzmangc.co m	San Francisco	CA	(415) 821-2522	(415) 821-2522		CA - City and County of San Francisco - MBE, CA - State of California, DGS - SB-PW, CA - State of California, DGS - SB-PW
No Response	Marcor Woodwork	Boris Borisov	borisb@marcorwoodwor k.com		MT		(403) 258-2088		
No Response	Northwest Cabinet Works	David Ovik	dave@nwcabinetworks.c om		MT		(406) 752-8383		
No Response	Nystrom Building Products	Aaron Hammer	ahammer@nystrom.com	Minneapolis	MN				
No Response	Tremco CPG	Chuck Bundrick	chuck.bundrick@dryvit.c om	Beachwood	OH		(630) 432-9697		
No Response	Wilson Meany	Ariel Pasch	APasch@wilsonmeany.c om			(415) 926-0290			

SUFFOLK

ALL POTENTIAL SBE SUBCONTRACTORS
Suffolk Construction is requesting bids from SBE subcontractors for the following project:
Treasure Island Parcel C3.4 "Portico"
Owner: Stockbridge, William Amey and Lerner
Project Description: A six-story, 148-unit mixed residential development with amenities and one level of below grade parking on Parcel C3.4 of Treasure Island.

GOVERNMENT

City and County of San Francisco
Department of Disability and Aging Services
Request for Proposals
RP# F152 Neighborhood Based Programs and Initiatives
The San Francisco Department of Disability and Aging Services (DAS) announces its intent to seek proposals from interested organizations interested in providing neighborhood-based programs and/or services to older adults and adults with disabilities who live in the San Francisco neighborhood within a Supervised District that is identified in the Dignity Fund Continuum of Care Needs Assessment (FCNA) as having overall service participation rate lower than the citywide average. These programs would provide opportunities for older adults and adults with disabilities to socialize, build community, and participate in a meaningful life.

one-bedroom, and 133 studio, of which parking spaces, and 134 Class One bicycle parking spaces, under the Individually Requested Shared Space Program pursuant to Planning Code Section 400.000 and California Government Code Section 65915. The project includes development standards, including: New (Net) Density (44), Dwelling Unit Exposure (Section 140), CP Street Curb (Section 151.1), and Height Limit (Section 151.1). The project also includes the Planning Code, pursuant to the Planning Code Section 400.000 and California Government Code Section 65915. The project also includes the Planning Code, pursuant to the Planning Code Section 400.000 and California Government Code Section 65915. The project also includes the Planning Code, pursuant to the Planning Code Section 400.000 and California Government Code Section 65915.

BULK SALES

ESCROW NO. 23596-CV
DATE: February 3, 2023
NOTICE TO CREDITORS OF THE ESTATE OF MRS. MARGARET M. ROY, DECEASED
The Court orders that all persons interested in the estate of Mrs. Margaret M. Roy, deceased, who have claims against the estate, must file a written objection to the bulk sale of the real property described in the bulk sale agreement, within ten (10) days of the date of this order.

CIVIL

ORDER TO SHOW CAUSE FOR CHANGE OF NAME

Superior Court of California, County of San Mateo
Case No. 23CV00031
Petitioner: DAI ZHANG and YIMIN ZHANG for Change of Name
The Court orders that all persons interested in this matter should appear at the hearing indicated on the date set for the hearing to show cause why the petition should not be granted.

ORDER TO SHOW CAUSE FOR CHANGE OF NAME

Superior Court of California, County of San Mateo
Case No. 23CV00032
Petitioner: DAI ZHANG and YIMIN ZHANG for Change of Name
The Court orders that all persons interested in this matter should appear at the hearing indicated on the date set for the hearing to show cause why the petition should not be granted.

ORDER TO SHOW CAUSE FOR CHANGE OF NAME

Superior Court of California, County of San Mateo
Case No. 23CV00033
Petitioner: DAI ZHANG and YIMIN ZHANG for Change of Name
The Court orders that all persons interested in this matter should appear at the hearing indicated on the date set for the hearing to show cause why the petition should not be granted.

ORDER TO SHOW CAUSE FOR CHANGE OF NAME

Superior Court of California, County of San Mateo
Case No. 23CV00034
Petitioner: DAI ZHANG and YIMIN ZHANG for Change of Name
The Court orders that all persons interested in this matter should appear at the hearing indicated on the date set for the hearing to show cause why the petition should not be granted.

ORDER TO SHOW CAUSE FOR CHANGE OF NAME

Superior Court of California, County of San Mateo
Case No. 23CV00035
Petitioner: DAI ZHANG and YIMIN ZHANG for Change of Name
The Court orders that all persons interested in this matter should appear at the hearing indicated on the date set for the hearing to show cause why the petition should not be granted.

FICTITIOUS NAMES

Case No. 23CV00036
Superior Court of California, County of San Mateo
Case No. 23CV00037
Superior Court of California, County of San Mateo
Case No. 23CV00038
Superior Court of California, County of San Mateo
Case No. 23CV00039
Superior Court of California, County of San Mateo

ORDER TO SHOW CAUSE FOR CHANGE OF NAME

Superior Court of California, County of San Mateo
Case No. 23CV00040
Petitioner: DAI ZHANG and YIMIN ZHANG for Change of Name
The Court orders that all persons interested in this matter should appear at the hearing indicated on the date set for the hearing to show cause why the petition should not be granted.

ORDER TO SHOW CAUSE FOR CHANGE OF NAME

Superior Court of California, County of San Mateo
Case No. 23CV00041
Petitioner: DAI ZHANG and YIMIN ZHANG for Change of Name
The Court orders that all persons interested in this matter should appear at the hearing indicated on the date set for the hearing to show cause why the petition should not be granted.

ORDER TO SHOW CAUSE FOR CHANGE OF NAME

Superior Court of California, County of San Mateo
Case No. 23CV00042
Petitioner: DAI ZHANG and YIMIN ZHANG for Change of Name
The Court orders that all persons interested in this matter should appear at the hearing indicated on the date set for the hearing to show cause why the petition should not be granted.

ORDER TO SHOW CAUSE FOR CHANGE OF NAME

Superior Court of California, County of San Mateo
Case No. 23CV00043
Petitioner: DAI ZHANG and YIMIN ZHANG for Change of Name
The Court orders that all persons interested in this matter should appear at the hearing indicated on the date set for the hearing to show cause why the petition should not be granted.

ORDER TO SHOW CAUSE FOR CHANGE OF NAME

Superior Court of California, County of San Mateo
Case No. 23CV00044
Petitioner: DAI ZHANG and YIMIN ZHANG for Change of Name
The Court orders that all persons interested in this matter should appear at the hearing indicated on the date set for the hearing to show cause why the petition should not be granted.

ORDER TO SHOW CAUSE FOR CHANGE OF NAME

Superior Court of California, County of San Mateo
Case No. 23CV00045
Petitioner: DAI ZHANG and YIMIN ZHANG for Change of Name
The Court orders that all persons interested in this matter should appear at the hearing indicated on the date set for the hearing to show cause why the petition should not be granted.

ORDER TO SHOW CAUSE FOR CHANGE OF NAME

Superior Court of California, County of San Mateo
Case No. 23CV00046
Petitioner: DAI ZHANG and YIMIN ZHANG for Change of Name
The Court orders that all persons interested in this matter should appear at the hearing indicated on the date set for the hearing to show cause why the petition should not be granted.

ORDER TO SHOW CAUSE FOR CHANGE OF NAME

Superior Court of California, County of San Mateo
Case No. 23CV00047
Petitioner: DAI ZHANG and YIMIN ZHANG for Change of Name
The Court orders that all persons interested in this matter should appear at the hearing indicated on the date set for the hearing to show cause why the petition should not be granted.

ORDER TO SHOW CAUSE FOR CHANGE OF NAME

Superior Court of California, County of San Mateo
Case No. 23CV00048
Petitioner: DAI ZHANG and YIMIN ZHANG for Change of Name
The Court orders that all persons interested in this matter should appear at the hearing indicated on the date set for the hearing to show cause why the petition should not be granted.

FICTITIOUS BUSINESS NAME STATEMENT

Case No. 23CV00049
Superior Court of California, County of San Mateo
Case No. 23CV00050
Superior Court of California, County of San Mateo
Case No. 23CV00051
Superior Court of California, County of San Mateo
Case No. 23CV00052
Superior Court of California, County of San Mateo

FICTITIOUS BUSINESS NAME STATEMENT

Case No. 23CV00053
Superior Court of California, County of San Mateo
Case No. 23CV00054
Superior Court of California, County of San Mateo
Case No. 23CV00055
Superior Court of California, County of San Mateo
Case No. 23CV00056
Superior Court of California, County of San Mateo

FICTITIOUS BUSINESS NAME STATEMENT

Case No. 23CV00057
Superior Court of California, County of San Mateo
Case No. 23CV00058
Superior Court of California, County of San Mateo
Case No. 23CV00059
Superior Court of California, County of San Mateo
Case No. 23CV00060
Superior Court of California, County of San Mateo

FICTITIOUS BUSINESS NAME STATEMENT

Case No. 23CV00061
Superior Court of California, County of San Mateo
Case No. 23CV00062
Superior Court of California, County of San Mateo
Case No. 23CV00063
Superior Court of California, County of San Mateo
Case No. 23CV00064
Superior Court of California, County of San Mateo

FICTITIOUS BUSINESS NAME STATEMENT

Case No. 23CV00065
Superior Court of California, County of San Mateo
Case No. 23CV00066
Superior Court of California, County of San Mateo
Case No. 23CV00067
Superior Court of California, County of San Mateo
Case No. 23CV00068
Superior Court of California, County of San Mateo

FICTITIOUS BUSINESS NAME STATEMENT

Case No. 23CV00069
Superior Court of California, County of San Mateo
Case No. 23CV00070
Superior Court of California, County of San Mateo
Case No. 23CV00071
Superior Court of California, County of San Mateo
Case No. 23CV00072
Superior Court of California, County of San Mateo

FICTITIOUS BUSINESS NAME STATEMENT

Case No. 23CV00073
Superior Court of California, County of San Mateo
Case No. 23CV00074
Superior Court of California, County of San Mateo
Case No. 23CV00075
Superior Court of California, County of San Mateo
Case No. 23CV00076
Superior Court of California, County of San Mateo

FICTITIOUS BUSINESS NAME STATEMENT

Case No. 23CV00077
Superior Court of California, County of San Mateo
Case No. 23CV00078
Superior Court of California, County of San Mateo
Case No. 23CV00079
Superior Court of California, County of San Mateo
Case No. 23CV00080
Superior Court of California, County of San Mateo

FICTITIOUS BUSINESS NAME STATEMENT

Case No. 23CV00081
Superior Court of California, County of San Mateo
Case No. 23CV00082
Superior Court of California, County of San Mateo
Case No. 23CV00083
Superior Court of California, County of San Mateo
Case No. 23CV00084
Superior Court of California, County of San Mateo

FICTITIOUS BUSINESS NAME STATEMENT

Case No. 23CV00085
Superior Court of California, County of San Mateo
Case No. 23CV00086
Superior Court of California, County of San Mateo
Case No. 23CV00087
Superior Court of California, County of San Mateo
Case No. 23CV00088
Superior Court of California, County of San Mateo

FICTITIOUS BUSINESS NAME STATEMENT

Case No. 23CV00089
Superior Court of California, County of San Mateo
Case No. 23CV00090
Superior Court of California, County of San Mateo
Case No. 23CV00091
Superior Court of California, County of San Mateo
Case No. 23CV00092
Superior Court of California, County of San Mateo

FICTITIOUS BUSINESS NAME STATEMENT

Case No. 23CV00093
Superior Court of California, County of San Mateo
Case No. 23CV00094
Superior Court of California, County of San Mateo
Case No. 23CV00095
Superior Court of California, County of San Mateo
Case No. 23CV00096
Superior Court of California, County of San Mateo

FICTITIOUS BUSINESS NAME STATEMENT

Case No. 23CV00097
Superior Court of California, County of San Mateo
Case No. 23CV00098
Superior Court of California, County of San Mateo
Case No. 23CV00099
Superior Court of California, County of San Mateo
Case No. 23CV00100
Superior Court of California, County of San Mateo

FICTITIOUS BUSINESS NAME STATEMENT

Case No. 23CV00101
Superior Court of California, County of San Mateo
Case No. 23CV00102
Superior Court of California, County of San Mateo
Case No. 23CV00103
Superior Court of California, County of San Mateo
Case No. 23CV00104
Superior Court of California, County of San Mateo

FICTITIOUS BUSINESS NAME STATEMENT

Case No. 23CV00105
Superior Court of California, County of San Mateo
Case No. 23CV00106
Superior Court of California, County of San Mateo
Case No. 23CV00107
Superior Court of California, County of San Mateo
Case No. 23CV00108
Superior Court of California, County of San Mateo

FICTITIOUS BUSINESS NAME STATEMENT

Case No. 23CV00109
Superior Court of California, County of San Mateo
Case No. 23CV00110
Superior Court of California, County of San Mateo
Case No. 23CV00111
Superior Court of California, County of San Mateo
Case No. 23CV00112
Superior Court of California, County of San Mateo

FICTITIOUS BUSINESS NAME STATEMENT

Case No. 23CV00113
Superior Court of California, County of San Mateo
Case No. 23CV00114
Superior Court of California, County of San Mateo
Case No. 23CV00115
Superior Court of California, County of San Mateo
Case No. 23CV00116
Superior Court of California, County of San Mateo

FICTITIOUS BUSINESS NAME STATEMENT

Case No. 23CV00117
Superior Court of California, County of San Mateo
Case No. 23CV00118
Superior Court of California, County of San Mateo
Case No. 23CV00119
Superior Court of California, County of San Mateo
Case No. 23CV00120
Superior Court of California, County of San Mateo

FICTITIOUS BUSINESS NAME STATEMENT

Case No. 23CV00121
Superior Court of California, County of San Mateo
Case No. 23CV00122
Superior Court of California, County of San Mateo
Case No. 23CV00123
Superior Court of California, County of San Mateo
Case No. 23CV00124
Superior Court of California, County of San Mateo

FICTITIOUS BUSINESS NAME STATEMENT

Case No. 23CV00125
Superior Court of California, County of San Mateo
Case No. 23CV00126
Superior Court of California, County of San Mateo
Case No. 23CV00127
Superior Court of California, County of San Mateo
Case No. 23CV00128
Superior Court of California, County of San Mateo

SUFFOLK

ALL POTENTIAL SBE SUBCONTRACTORS
Suffolk Construction is requesting bids from SBE
subcontractors for the following project:

Treasure Island Parcel C3.4 "Portico"
Suffolk Job #223016

Owner: Stockbridge, Wilson Meany and Lennar

Project Description: A six-story, 148-unit planned
residential development with amenities and one level of
below grade parking on Parcel C3.4 of Treasure Island.

Pre-bid Meeting: Date 2/22/23 at 10AM

Meeting Description: Suffolk Construction will be hosting
a pre-bid meeting for available scopes of work on the
Treasure Island Parcel C3.4 "Portico" project. Project
Executive Scott Onick will have a short presentation
on the project. We will be providing a link to the project
documents post-meeting. Members of the Treasure Island
Development Authority (TIDA) and CityBuild will also be
present to discuss SBE project requirements. Suffolk will
briefly discuss our company's prequalification process,
as we require all subcontractors to be prequalified before
awarding any contracts. If you are interested in attending
the meeting, please send your name, company name, and
contact info to VDeshmukh@suffolk.com.

CNSB#3667272

SBE Prebid Meeting

February 22, 2023

Treasure Island
Parcel C3.4

PORTICO

SUFFOLK



GUZMAN
• CONSTRUCTION GROUP •



Agenda

1. Introductions
2. Project Overview
3. SBE Discussion (CityBuild and TIDA)
4. SGJV Prequalification
5. Q & A



SUFFOLK



GUZMAN
• CONSTRUCTION GROUP •



Introduction



Project Overview

Client: Treasure Island Development Group
Contractor: Suffolk-Guzman Joint Venture

- Located at 22 Johnson Street, SF Treasure Island Parcel C3.4
- Type III-A +VA over IA (Wood Frame over Concrete Podium)
- 148 Units, nearly 250,000 GSF
- One Level Below Grade Parking
- Design Build MEPs
- Under Project Labor Agreement
- OCIP
- Est Completion in 2024

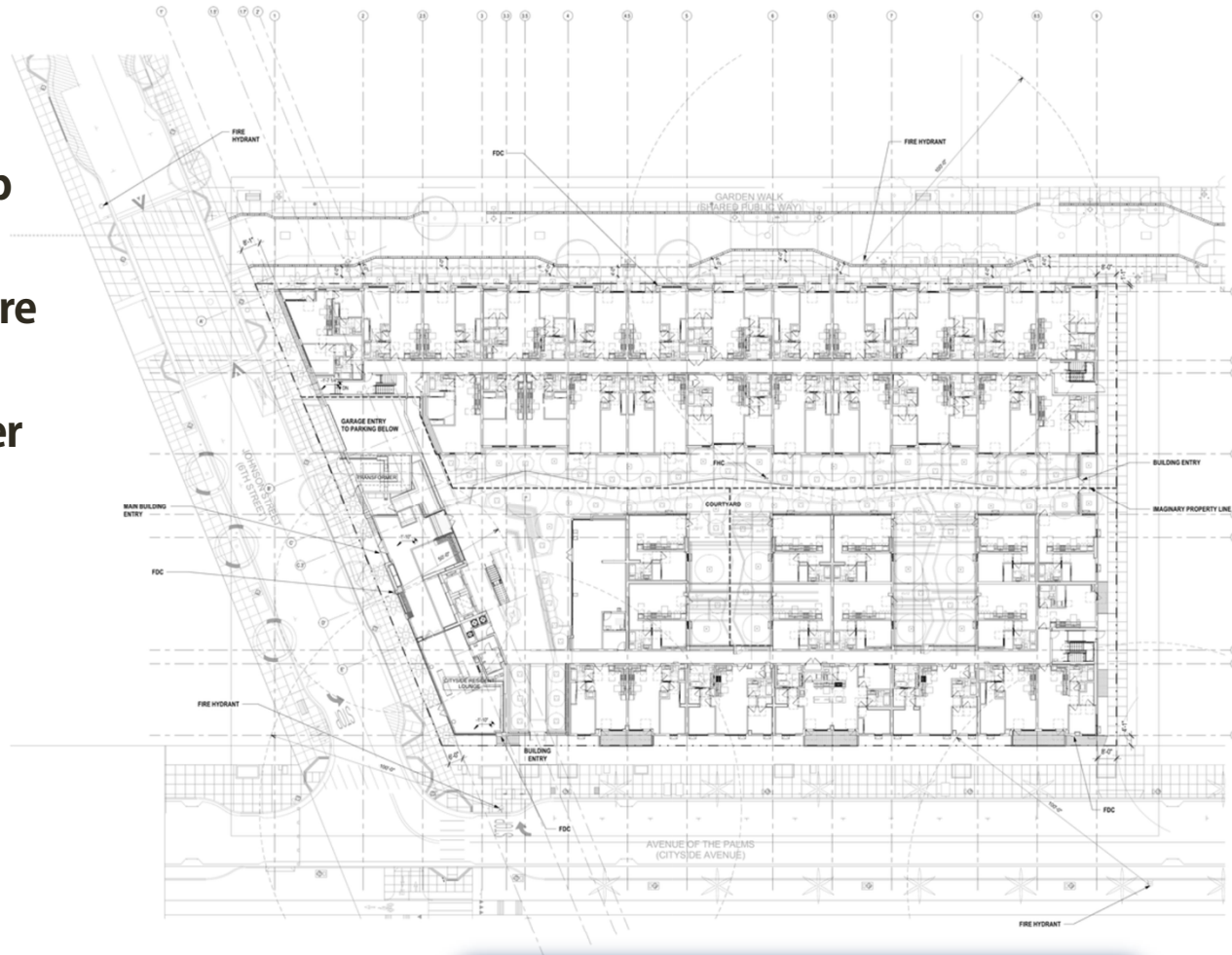

1 SITE PLAN
SCALE: 1/8"=1'-0"

SUFFOLK

GUZMAN
• CONSTRUCTION GROUP •

SBE Discussion

CityBuild

Treasure Island Development Authority
(TIDA)



City and County
of San Francisco

Prequalification



GUZMAN
• CONSTRUCTION GROUP •



SUFFOLK



GUZMAN
• CONSTRUCTION GROUP •

Questions & Answers



GUZMAN
• CONSTRUCTION GROUP •

1. Summary

Meeting title	SBE Prebid - Portico TI C3.4 - Suffolk/Guzman Joint Venture
Attended participants	3
Start time	2/22/23, 9:57:50 AM
End time	2/22/23, 10:17:37 AM
Meeting duration	19m 47s
Average attendance time	17m 58s

2. Participants

Name	First Join	Last Leave	In-Meeting	Email	Participant Role
Deshmukh, Vaishnavi	2/22/23, 10:00:00 AM	2/22/23, 10:15:55 AM	15m 55s	VDeshmukh	Organizer
Onick, Scott	2/22/23, 9:57:50 AM	2/22/23, 10:19:41 AM	19m 41s	SOnick@su	Presenter
James mabrey	2/22/23, 9:57:50 AM	2/22/23, 10:18:17 AM	18m 17s		Presenter

3. In-Meeting Activities

Name	Join Time	Leave Time	Duration	Email	Role
Deshmukh, Vaishnavi	2/22/23, 10:00:00 AM	2/22/23, 10:15:55 AM	15m 55s	VDeshmukh	Organizer
Onick, Scott	2/22/23, 9:57:50 AM	2/22/23, 10:19:41 AM	19m 41s	SOnick@su	Presenter
James mabrey	2/22/23, 9:57:50 AM	2/22/23, 10:18:17 AM	18m 17s		Presenter

Deshmukh, Vaishnavi

From: Deshmukh, Vaishnavi
Sent: Thursday, December 21, 2023 12:08 PM
To: jack@northbaydoors.com
Subject: FW: Treasure Island Parcel C3.4
Attachments: Exhibit B TI C3.4 - Coiling Grilles North Bay Overhead Doors.docx

Forwarding for Kim

From: Deshmukh, Vaishnavi
Sent: Thursday, December 21, 2023 12:06 PM
To: Kim Berlin <kim@northbaydoors.com>
Subject: FW: Treasure Island Parcel C3.4

FYI

From: Deshmukh, Vaishnavi
Sent: Wednesday, December 20, 2023 12:16 PM
To: Kim Berlin <kim@northbaydoors.com>
Subject: FW: Treasure Island Parcel C3.4

Hey Kim,

Hope everything is good. I tried calling and the office directed me to email you. The buyout got side tracked, however I want to follow up with you – can you please review the Exhibit B and if everything looks good we can proceed with the contract. Appreciate your response.

Thanks,
Vaish

From: Deshmukh, Vaishnavi
Sent: Tuesday, July 25, 2023 4:10 PM
To: Kim Berlin <kim@northbaydoors.com>
Cc: Schwieger, Nick <NSchwieger@suffolk.com>; Cheung, Matthew <MCheung@suffolk.com>; Onick, Scott <SONick@suffolk.com>
Subject: RE: Treasure Island Parcel C3.4

Hey Kim,

Thanks for answering my questions on call. Please find the attached Exhibit B for your review. Feel free to call me in case of any questions.

-Vaish

From: Deshmukh, Vaishnavi
Sent: Monday, June 12, 2023 7:53 AM
To: 'Kim Berlin' <kim@northbaydoors.com>

Cc: Schwieger, Nick <NSchwieger@suffolk.com>; Cheung, Matthew <MCheung@suffolk.com>

Subject: RE: Treasure Island Parcel C3.4

Good morning Kim,

Thanks for sharing these.

-Vaishnavi

From: Kim Berlin <kim@northbaydoors.com>

Sent: Thursday, June 8, 2023 5:23 PM

To: Deshmukh, Vaishnavi <VDeshmukh@suffolk.com>

Cc: Schwieger, Nick <NSchwieger@suffolk.com>; Cheung, Matthew <MCheung@suffolk.com>

Subject: [External] RE: Treasure Island Parcel C3.4

Please see attached revised quote, and shop drawings showing loads.

Thank you,

North Bay Overhead Doors Inc.

Kim Berlin

1130 Industrial Ave. # 6

Petaluma, Ca. 94952

Phone: (415) 499-0602

Fax: (415) 499-1711

Email: kim@northbaydoors.com

The information contained in this e-mail is intended only for the individual or entity to whom it is addressed. Its contents (including any attachments) are confidential and may contain privileged information. If you are not an intended recipient you must not use, disclose, disseminate, copy or print its contents. If you receive this e-mail in error, please notify the sender by reply e-mail and delete and destroy the message.

From: Deshmukh, Vaishnavi <VDeshmukh@suffolk.com>

Sent: Wednesday, June 7, 2023 9:35 AM

To: Kim Berlin <kim@northbaydoors.com>

Cc: Schwieger, Nick <NSchwieger@suffolk.com>; Cheung, Matthew <MCheung@suffolk.com>

Subject: RE: Treasure Island Parcel C3.4

Hey Kim,

Thanks for the proposal and answering my questions on call. As discussed can you please share the updated proposal with OCIP credit? Also, please share the cut sheet specifying the details of self load.

Thanks,

Vaishnavi

Vaishnavi Deshmukh
Project Engineer

C | +1 (415) 517 2043



suffolk.com



From: Kim Berlin <kim@northbaydoors.com>
Sent: Wednesday, June 7, 2023 8:43 AM
To: Deshmukh, Vaishnavi <VDeshmukh@suffolk.com>
Subject: [External] Treasure Island Parcel C3.4

Good morning,

Please see attached revised quote.

Thank you,

North Bay Overhead Doors Inc.

Kim Berlin
1130 Industrial Ave. # 6
Petaluma, Ca. 94952
Phone: (415) 499-0602
Fax: (415) 499-1711
Email: kim@northbaydoors.com

The information contained in this e-mail is intended only for the individual or entity to whom it is addressed. Its contents (including any attachments) are confidential and may contain privileged information. If you are not an intended recipient you must not use, disclose, disseminate, copy or print its contents. If you receive this e-mail in error, please notify the sender by reply e-mail and delete and destroy the message.

Isle House Parcel C2.4 Treasure Island
2023 SBE Report

Identify SBE Goal of this contract: 41%

Period: 01/01/2023-12/31/2023

A	B	Added	C	D	E	F	G	H
Name of Firm. List prime Contractor, including each JV partner, and all Subcontractors. Indicate if the firm is a San Francisco SBE or Other SBE	Service Performed	SBE / Other SBE / Non-SBE	Dollar Value of Covered Contract at Time of Award	Amount of Modifications to Date	Total Amount of Covered Contract to Date +/- Modifications (C+D) or (C-D)	Amount Invoiced this Reporting Period 12/31/2022	Amount Invoiced to Date 12/31/2022	Percent Complete to Date (G+E)
WECOR BUILDERS	PRIME CONTRACTOR	No	72,254,135.61	(44,586,043.03)	22,639,538.03	(81,910,538.41)	(81,910,538.41)	-361.80 %
ACR Glass and Doors (Other Sbe)	Const. WP-03.02 Nail Fin Windows	SBE Other	546,894.00	-	546,894.00	492,204.60	492,204.60	90.00 %
Alliance Roofing Company, Inc.	Const. WP #07 - Waterproofing and Roofing	No	10,000.00	2,226,001.00	2,236,001.00	2,138,340.00	2,138,340.00	95.63 %
Cell-Crete Corporation	Cell-Crete	No	-	-	-	-	-	%
Allied Fire Protection	Pre-Con - Fire Suppression Design for Connection to City Main	No	3,000.00	2,592,996.00	2,595,996.00	2,309,846.00	2,309,846.00	88.98 %
American Power Washing & Sanitation, Inc.	GC/GR's WP #50 Temp Toilets, Holding Tank and Fencing	Not Received	27,703.00	42,896.80	70,599.80	70,599.80	70,599.80	100.00 %
American Tile & Brick Veneer, Inc. (SF SBE)	Const. P#05-VMU Thin Brick Veneer	SF SBE	-	862,341.00	862,341.00	773,027.30	773,027.30	89.64 %
Anderson Commercial Flooring	Constr. WP # Carpet, Resilient Tile and Wood Flooring	No	1,796,818.00	-	1,796,818.00	473,976.60	473,976.60	26.38 %
Anning-Johnson Company	Const WP#12 Exterior Framing, Sheathing & Waterproofing	No	-	2,587,460.00	2,587,460.00	2,515,552.50	2,515,552.50	97.22 %
Bay Area Concretes, Inc	Const. WP # Architectural Topping Slabs	No	225,890.00	-	225,890.00	98,662.00	98,662.00	43.68 %
Bay City Mechanical (Goal 20%)	Const. WP #037 Design-Build HVAC	No	8,377,012.66	612,993.00	10,884,163.25	8,457,216.11	8,457,216.11	77.70 %
TM Construction (SF SBE)	Equipment Purchase, QA/QC, Contract Documents	SF SBE	1,407,207.59	-	1,407,207.59	1,290,897.99	1,290,897.99	91.73 %
System Mechanical (Other Sbe)	Controls	SBE Other	285,850.00	-	285,850.00	142,925.00	142,925.00	50.00 %
Temper Insulation (SF SBE)	Insulation	SF SBE	201,100.00	-	201,100.00	66,800.00	66,800.00	33.22 %
Bertco, Inc. (Other Sbe)	Precon - Temporary Shoring System Design	SBE Other	22,500.00	-	22,500.00	22,500.00	22,500.00	100.00 %
Bigge Crane & Rigging	GC/GR's - WP #044 Hoist Assembly & Dismantle	No	-	60,799.52	60,799.52	60,799.52	60,799.52	100.00 %
BOK Modern, Inc.	Const. WP#45 Exterior Sunshades	No	168,127.82	-	168,127.82	168,127.82	168,127.82	100.00 %
C. E. Toland & Son	Const. WP #06 Miscellaneous Metals	No	1,066,495.00	-	1,066,495.00	779,279.00	779,279.00	73.07 %
Clear Water Compliance, LLC	Const. WP #43 Ground Water Treatment System	No	113,627.00	-	113,627.00	105,991.22	105,991.22	93.28 %
Collier Building Specialties, Inc.	Const. WP #33 Metal Framed Skylight	SF SBE	53,490.00	-	53,490.00	1,755.00	1,755.00	3.28 %
Creative Masonry, Inc.	Const. WP #04 Unit Masonry	No	114,889.00	42,281.33	157,170.33	86,401.33	86,401.33	54.97 %
Crestmark Millwork Inc.	Const. WP # Common Area Millwork	No	1,141,338.00	-	1,141,338.00	27,789.00	27,789.00	2.43 %
D'Amato Conversano		Not Received	22,000.00	-	22,000.00	22,000.00	22,000.00	100.00 %
D&J Tile Company Inc.	Const. WP # Residential Tile	No	1,439,595.00	56,511.00	1,496,106.00	871,611.50	871,611.50	58.26 %
DeSilva Gates Construction LP	Const. WP #N/A Sanitary Sewer Lateral Extension	No	279,793.00	-	279,793.00	279,793.00	279,793.00	100.00 %
Foundation Constructors, Inc.	Pre-Con WP # Pile Foundations	No	290,000.00	3,718,400.00	4,008,400.00	4,008,400.00	4,008,400.00	100.00 %
Garnett Signs LLC	Const. WP # Code Signage	No	139,455.00	-	139,455.00	41,836.00	41,836.00	30.00 %
Ground Force Enterprises (Other Sbe)	GC/GR's - Debris Boxes	SBE Other	75,000.00	25,000.00	100,000.00	88,686.34	88,686.34	88.69 %
Hydrologic Systems	Const. WP #43 Dewatering System Design	Not Received	13,800.00	-	13,800.00	13,797.70	13,797.70	99.98 %
J & J Acoustics Inc	Const. WP #014 Metal Framing, Drywall and Insulation	No	12,562,908.00	232,628.66	12,795,536.66	11,116,982.01	11,116,982.01	86.88 %
Bear Insulation	Insulation	No	-	-	-	-	-	%
J.W. McClenahan Co.	Const. WP # Design/ Build Plumbing	No	(665,530.00)	12,325,694.50	11,647,465.53	11,031,830.00	11,031,830.00	94.71 %
White Water Plumbing (SF SBE)	Fuel Oil	SF SBE	291,655.00	-	291,655.00	262,489.00	262,489.00	90.00 %
Temper Insulation (SF SBE)	Insulation	SF SBE	160,410.00	-	160,410.00	120,305.00	120,305.00	75.00 %
Temper Insulation (SF SBE)	Firestopping	SF SBE	101,265.00	-	101,265.00	75,946.00	75,946.00	75.00 %
Hoseley Corporation (SF SBE)	Excavation and Backfill	SF SBE	125,000.00	12,698.97	137,698.97	137,698.97	137,698.97	100.00 %
Klaus Multiparking, Inc.	Const. WP #024 - Vehicle Parking System	No	2,282,366.90	-	2,282,366.90	1,358,022.41	1,358,022.41	59.50 %
Holm, LLC	Car Stacker Installation	No	-	-	-	-	-	%
Kone, Inc.	Const. WP #023 Vertical Transportation	No	1,895,440.00	-	1,895,440.00	1,876,302.00	1,876,302.00	98.99 %
M-I-N-T	Furnish Only 241 Residential Unit Entry Signs	Not Received	83,080.00	-	83,080.00	83,080.00	83,080.00	100.00 %
Malcolm Drilling Company, Inc.	Const. WP#43 Dewatering Well System	Not Received	136,092.00	65,857.70	201,949.70	201,949.70	201,949.70	100.00 %

Identify SBE Goal of this contract: 41%

Period: 01/01/2023-12/31/2023

A	B	Added	C	D	E	F	G	H
Name of Firm. List prime Contractor, including each JV partner, and all Subcontractors. Indicate if the firm is a San Francisco SBE or Other SBE	Service Performed	SBE /Other SBE / Non- SBE	Dollar Value of Covered Contract at Time of Award	Amount of Modifications to Date	Total Amount of Covered Contract to Date +/- Modifications (C+D) or (C-D)	Amount Invoiced this Reporting Period 12/31/2022	Amount Invoiced to Date 12/31/2022	Percent Complete to Date (G+E)
Martin M. Ron Associates Inc.(Other Sbe)	GC/GR's - Surveying	SBE Other	29,436.00	134,304.00	163,740.00	12,771.00	12,771.00	7.80 %
Mobile Modular Manag. Corp dba MM Portable Storage	GC/GR's - Job Site Trailers - Monthly Rental	No	67,972.32	18,963.36	86,935.68	62,831.17	62,831.17	72.27 %
Mobile Modular Manag. Corp dba MM Portable Storage	GC/GR's - Job Site Trailers - Supply and Install	No	93,765.45	20,800.76	114,566.21	95,422.64	95,422.64	83.29 %
Molina's Painting & Wallcovering, Inc. (Other Sbe)	Const. WP # Painting, Wall Covering, and Paneling	SBE Other	1,925,000.00	-	1,925,000.00	388,646.00	388,646.00	20.19 %
Morrow Equipment Company, LLC	GC/GR's WP #042 Tower Crane	No	271,458.33	-	271,458.33	262,014.17	262,014.17	96.52 %
North Bay Overhead Doors, Inc.	Const. WP #030 Overhead Coiling Door	No	73,743.00	-	73,743.00	44,886.30	44,886.30	60.87 %
Pacific Stair Corporation	Const. WP #06.1 Steel Stairs and Railings	No	770,870.00	-	770,870.00	773,874.00	773,874.00	100.39 %
BEI (Other Sbe)	Steel Stair Installation	SBE Other	352,250.00	-	352,250.00	331,397.00	331,397.00	94.08 %
Pheonix Electric Company	WP#57 - Natural Gas Underground Utility	Not Received	86,018.00	-	86,018.00	60,000.00	60,000.00	69.75 %
PMR PACIFIC SEALANTS, LLC	Const. WP55 - Exterior Misc. Caulking	Not Received	(1,272,978.45)	-	(1,272,978.45)	79,392.90	79,392.90	-6.24 %
R&B Wholesale Distributors, Inc.	Const. WP # Residential Appliances	No	1,369,942.45	(20,000.00)	1,349,942.45	6,000.00	6,000.00	0.44 %
Summit Construction	Installation	No	-	-	-	-	-	%
Reflection Window Company, LLC	Const. WP #03 Storefront and Window Wall	No	13,476,877.00	-	13,476,877.00	12,851,391.58	12,851,391.58	95.36 %
CEOWD	Installation	No	-	-	-	-	-	%
Rosendin Electric, Inc.	Pre-Const. Construction Site Temporary Power Engineering	No	14,280.00	668,981.00	683,261.00	899,186.00	899,186.00	131.60 %
Rosendin Electric, Inc.	Const. WP #040 and #41 Design-Build Electrical & Life Safety	No	(350,487.00)	18,259,953.79	17,535,950.79	13,642,979.29	13,642,979.29	77.80 %
Pacific Auxiliary Fire Alarm (SF SBE)	Fire Life Safety/ ERRCS	SF SBE	60,200.00	274,000.00	334,200.00	229,104.00	229,104.00	68.55 %
JD Firestop (Other Sbe)	Fire/ Acoustical Pads	SBE Other	86,704.00	-	86,704.00	46,333.12	46,333.12	53.44 %
Hoseley Corp		SBE Other	-	-	-	-	-	%
Hot Line Construction		No	-	-	-	-	-	%
Cochran		No	-	-	-	-	-	%
Microbiz (SF SBE)	Security/ CCTV	SF SBE	303,099.00	-	303,099.00	25,000.00	25,000.00	8.25 %
Sheedy Drayage		No	-	-	-	-	-	%
RT WESTERN, INC	Const. WP #09 Doors, Frames and Hardware	No	3,248,470.00	-	3,248,470.00	1,336,244.00	1,336,244.00	41.13 %
Scaffold Solutions, Inc.	GC/GR's - Hoist Scaffolding	No	50,000.00	315,139.00	365,139.00	334,502.00	334,502.00	91.61 %
Service By Medallion	GC/GR's WP #49 - Cleaning for Trailers	Not Received	5,525.00	-	5,525.00	5,525.00	5,525.00	100.00 %
Sheedy Drayage Co	GC/GR's WP #042 Tower Crane Erection & Dismantle	No	216,444.00	4,016.18	220,460.18	220,459.88	220,459.88	100.00 %
Silverado Contractors, Inc.	Const. WP #01 Earthwork	No	512,972.00	73,713.44	586,685.44	586,684.44	586,684.44	100.00 %
Champion Contractors		No	-	-	-	-	-	%
Eighteen Trucking, Inc.		No	-	-	-	-	-	%
Sky Rider Equipment Co., Inc (Other SBE)	Const. WP #20 Exterior Building Maintenance System	SBE Other	358,976.00	-	358,976.00	297,692.80	297,692.80	82.93 %
Rhoades Steel Services (Other SBE)	Equipment Installation	SBE Other	53,824.00	7,761.00	61,585.00	45,857.20	45,857.20	74.46 %
Specialties, Etc. Corp. (SF SBE)	Const. WP #21 Trash Chute and Equipment	SF SBE	209,626.00	65,869.00	275,495.00	72,236.00	72,236.00	26.22 %
Weboor Carpentry, a division of Weboor Craft, L.P.	Const. WP #10 & #10.1 Unit Casework Finish Carpentry	No	2,267,890.00	-	2,267,890.00	1,253,055.00	1,253,055.00	55.25 %
Destefano Design Group	Casework Supply	No	1,487,302.00	-	1,487,302.00	Inlc Above	Inlc Above	%
Weboor Concrete, a division of Weboor Craft, L.P.	Const. WP #02 Structural Concrete	No	10,009,239.22	1,655,615.65	15,185,466.80	19,515,407.71	19,515,407.71	128.51 %
Central Concrete Supply Co., Inc.	Concrete Supply	No	3,288,000.00	49,538.75	3,337,538.75	1,355,675.73	1,355,675.73	40.62 %
Ground Force (Other Sbe)	Debris Boxes	SBE Other	70,000.00	-	70,000.00	4,250.00	4,250.00	6.07 %
Interstate Concrete Pumping (Other Sbe)	Concrete Pumping	SBE Other	463,990.00	-	463,990.00	101,927.96	101,927.96	21.97 %
Pacific Steel Group	Rebar	No	7,277,565.10	11,040.00	7,288,605.10	5,160,458.00	5,160,458.00	70.80 %
Nationwide Shotcrete Inc.	Shotcrete	No	73,619.00	-	73,619.00	-	-	0.00 %

Identify SBE Goal of this contract: 41%

Period: 01/01/2023-12/31/2023

A	B	Added	C	D	E	F	G	H
Name of Firm. List prime Contractor, including each JV partner, and all Subcontractors. Indicate if the firm is a San Francisco SBE or Other SBE	Service Performed	SBE / Other SBE / Non-SBE	Dollar Value of Covered Contract at Time of Award	Amount of Modifications to Date	Total Amount of Covered Contract to Date +/- Modifications (C + D) or (C - D)	Amount Invoiced this Reporting Period 12/31/2022	Amount Invoiced to Date 12/31/2022	Percent Complete to Date (G+E)
EFCO Corp		Not Received		-	-		-	%
AJ Miller		Not Received		-	-		-	%
Top Deck AI		Not Received		-	-		-	%
Jordahl USA, Inc dba Decon USA		Not Received		-	-		-	%
RMD Kwiform North America		Not Received		-	-		-	%
NationwideShotcrete		Not Received		-	-		-	%
Construction Test Service		Not Received		-	-		-	%
Squire Lumber		Not Received		-	-		-	%
MJ2 Consulting		Not Received		-	-		-	%
UFP Thornton		Not Received		-	-		-	%
Vita Inclinata Technologies		Not Received		-	-		-	%
Hycrete		Not Received		-	-		-	%
			-	-	-	-	-	%
			-	-	-	-	-	%
			-	-	-	-	-	%
San Francisco SBE Professional Fees			2,913,052.59	1,214,908.97	4,127,961.56	3,055,259.26	3,055,259.26	74.01 %
Other (Non-SF) SBE Professional Fees			4,270,424.00	167,065.00	4,437,489.00	1,975,191.02	1,975,191.02	44.51 %
All SBE Professional Fees Sub-Totals			7,183,476.59	1,381,973.97	8,565,450.56	5,030,450.28	5,030,450.28	58.73 %
Non-SBE Professional Fees Sub-Totals			146,816,523.41	1,036,238.41	147,852,761.82	24,833,636.62	24,833,636.62	16.80 %
SBE & Non-SBE Professional Fees Totals			154,000,000.00	2,418,212.38	156,418,212.38	29,864,086.90	29,864,086.90	19.09 %
Reimbursable Expenses			-	-	-	-	-	-
CONTRACT TOTALS			154,000,000.00	2,418,212.38	156,418,212.38	29,864,086.90	29,864,086.90	19.09 %

Amended 09.14.2016

Proj.Final (Contracts Thru 12/2023)		Invoiced Through 12/31/2023	
% SF SBE	2.64%	% SF SBE	10.23%
% Other SBE	2.84%	% Other SBE	6.61%
% All SBE	5.48%	% All SBE	16.84%

March 1, 2024

Treasure Island Development Authority
One Avenue of the Palms, Suite 241
Treasure Island
San Francisco, CA 94130

Re: **2023 Small Business Enterprise (SBE) Report**
TI Lot 8 LLC, C2.2, (“Hawkins”)

In accordance with the Small Business Enterprise Procedures, Hawkins is providing our annual “SBE Report” documenting the progress toward meeting the SBE Goals for the calendar year 2023 and cumulatively to-date through December 31, 2023.

Summary and Highlights for this Year Include:

- Design Documents for Hawkins was completed in 2022,
- The Site Permit was approved in July 2022 and construction commenced in September 2022. Hawkins is scheduled to be completed in late-2024.
- The lead architect is Mark Cavagnero & Associates.
- The contractor is James E. Roberts – Obayashi Corporation. Approximately 97% of the contract had been awarded.
- Hawkins is being developed into a 178-apartment home community with a large courtyard, rooftop open space with views of San Francisco Bay and the East Bay, and other amenities, including a gym, co-working, and lounge.

A. Professional Services Contracts

Achieved SBE Measurement / SBE Progress on SBE Goals

The summary totals for cumulative to-date and 2023 calendar year’s overall contract values, amount awarded to SBEs, and amount awarded to San Francisco SBEs, along with the percentage against total covered contract values are listed in the table below.

	CY 2023	Cumulative
Total Covered Contracts Value	\$1,651,174	\$8,026,447
Amount Awarded to SF SBEs	\$51,254	\$980,872
Amount Awarded to all SBEs	\$51,254	\$1,593,105
Achieved SBE Percentage	3%	20%

B. Construction Contracts

Achieved SBE Measurement / SBE Progress on SBE Goals

The summary totals for cumulative to-date and 2023 calendar year's overall contract values, amount awarded to SBEs, and amount awarded to San Francisco SBEs, along with the percentage against total covered contract values are listed in the table below.

	CY 2023	Cumulative
Total Covered Contracts Value	\$31,743,539	\$105,617,182
Amount Awarded to SF SBEs	\$4,387,443	\$5,869,964
Amount Awarded to all SBEs	\$8,600,789	\$13,036,242
Achieved SBE Percentage	27%	12%

SBE participation is below the goal, we do not expect the percentage to increase in 2024 as the remaining work available for bid and buyout is minimal.

C. Summary of 2023 Good Faith Efforts and Outreach Activities

As part of the outreach efforts related to the solicitation process, the RFPs were advertised via the following mechanisms:

- TIDA Website
- All Bay Area Builder Exchanges
- Encouraged Small and Local Suppliers
- Pre-Construction Meetings with City Build
- Working with San Francisco City Build on recruiting job seekers who are interested in being sponsored as an apprentice, or have prior construction experience for, for construction employment opportunities.
- Pre-bid meetings have been held with subcontractors. The pre-bid meetings included a discussion of the SBE Policies for the project and contractors were encouraged to take steps to meet or exceed the project goals.

D. PROJECTED 2024 ACTIVITIES

Professional Services: The majority of the professional services at Hawkins has been contracted. However, any additional professional service could achieve the same percentage of SBE as outlined above.

Construction Work: 2024 will include the final construction change orders and contract to be valued at approximately \$30M. We do not anticipate an increase of SBEs to be picked up in the final \$30M.

DRAFT

March 7, 2024

Treasure Island Development Authority
One Avenue of the Palms, Suite 241
Treasure Island
San Francisco, CA 94130

Re: 2023 Small Business Enterprise (SBE) Report Revised

In accordance with the Small Business Enterprise Procedures adopted January 8, 2014, and amended September 14, 2016, Stockbridge / Wilson Meany YBI Investors, LLC is providing our annual “SBE Report” documenting YBI’s progress toward meeting the SBE Goals¹ for the calendar year 2023 and cumulatively to-date for January 8, 2014, through December 31, 2023.

Highlights for this year include:

- **13%** of the additional professional services contracts in 2023 included SBE firms (**\$173,843** out of **\$1,389,710** awarded).
- **32%** of the cumulative professional services contracts included SBE firms (**\$6,066,724** out of **\$18,889,035** awarded).
- **6%** of the construction contracts awarded in 2023 went to SBE firms (**\$356,460** out of **\$6,014,169** awarded).
- **22%** of the cumulative construction contracts awarded went to SBE firms (**\$44,986,941** out of **\$207,164,176** awarded).

A. PROFESSIONAL SERVICES CONTRACTS

Achieved SBE Measurement / SBE Progress on SBE Goals

The summary totals for cumulative to-date and 2023 calendar year’s overall contract values, amount awarded to SBEs, and amount awarded to San Francisco SBEs, along with the % against total covered contract values are listed in the table below.

	Cumulative To-Date	Calendar Year 2023
Total Covered Contracts Value	\$ 18,889,035	\$ 1,389,710
Amount Awarded to San Francisco-based SBEs	\$ 6,066,724	\$ 173,843
Amount Awarded to All SBEs	\$ 6,066,724	\$ 173,843
% of Total Covered Contract Value Awarded to San Francisco-based SBEs	32%	13%
Achieved SBE Measurement	32%	13%
Professional Services SBE Goal	38%	38%

¹ Stockbridge / Wilson Meany YBI Investors, LLC tracks Small Business Enterprise participation in accordance with TIDA’s adopted SBE Procedures. These goals do not require tracking of other disadvantaged businesses such as MBEs, DBEs, or WBEs, and therefore Stockbridge / Wilson Meany YBI Investors, LLC does not have that information.

A total of \$173,843 new contract value was awarded to SBEs in 2023, out of a total of \$18,889,035 in covered contracts. Of the \$173,843 contract value awarded to SBEs, all were awarded to San Francisco-based SBEs.

As represented in the table below, at the end of the 2023 calendar year, of the 85% (\$16,079,342) of total covered contract paid cumulatively to-date, 29.3% (\$4,715,900) of the total amount paid was for work completed by SBEs. Of this amount, 29.3% (\$4,715,900), was paid to San Francisco-based SBEs.

	Cumulative To-Date	Calendar Year 2023
Total Amount Paid	\$ 16,079,342	\$ 1,058,434
Amount Paid to San Francisco-based SBEs	\$ 4,715,900	\$ 301,501
Amount Paid to All SBEs	\$ 4,715,900	\$ 301,501
Total Amount Paid against Total Covered Contract Value	85%	5.6%
Amount Paid to All SBEs against Total Amount Paid	29.3%	1.9%
Amount Paid to All SBEs against Total Covered Contract Value	25%	1.6%

Exhibit A contains the compiled summary SBE Form 3 for each Stockbridge / Wilson Meany YBI Investors, LLC prime consultant with the names and contract award amounts of SBE sub-consultant firms performing work under each Stockbridge / Wilson Meany YBI Investors, LLC prime consultant.

Summary of 2023 Good Faith Effort SBE Outreach Compliance

New Professional Services Covered Contracts

Sage Consulting Engineers, one of our SBE sub-consultants under KPFF, was awarded a separate prime contract in 2023 to perform QA/QC and help augment our civil engineering needs for the project during construction. No other new professional services were required by the project in 2023.

Amendments to Existing Professional Services Covered Contracts

2023 saw an additional \$1,319,710 of contract value to existing contracts of which \$173,843 was awarded to SF SBEs bringing the participation to 32% of total cumulative contract value.

B. CONSTRUCTION CONTRACTS

Achieved SBE Measurement / SBE Progress on SBE Goals

The summary totals for cumulative to-date and 2023 calendar year’s overall contract values, amount awarded to SBEs, and amount awarded to San Francisco SBEs, along with the % against total covered contract values are listed in the table below.

	Cumulative To-Date	Calendar Year 2023
Total Covered Contracts Value	\$ 207,164,176	\$ 6,014,169
Amount Awarded to San Francisco-based SBEs	\$ 19,029,169	\$ 311,977
Amount Awarded to All SBEs	\$ 44,986,941	\$ 356,460
% of Total Covered Contract Value Awarded to San Francisco-based SBEs	9.2%	51.9%
Achieved SBE Measurement	22%	6%
Construction Contracts SBE Goal	38%	38%

As represented in the table below, at the end of the 2023 calendar year, of the 96% (\$198,778,814) of total covered contract paid cumulatively to-date, 21% (\$42,548,901) of the total amount paid was for work completed by SBEs. Of this amount, 9.2% (\$18,336,178), was paid to San Francisco-based SBEs.

	Cumulative To-Date	Calendar Year 2023
Total Amount Paid	\$ 198,778,814	\$ 3,058,161
Amount Paid to San Francisco-based SBEs	\$ 18,336,178	\$ 164,174
Amount Paid to All SBEs	\$ 42,548,901	\$ 498,105
Total Amount Paid against Total Covered Contract Value	96%	1.5%
Amount Paid to All SBEs against Total Amount Paid	21%	16.3%
Amount Paid to All SBEs against Total Covered Contract Value	20.5%	8.3%

Exhibit B contains the compiled summary SBE Form 3 for each Stockbridge / Wilson Meany YBI Investors, LLC prime contractors with the names and contract award amounts of SBE sub-contractors performing work under each Stockbridge / Wilson Meany YBI Investors, LLC prime contractor.

Summary of 2023 Good Faith Effort SBE Outreach Compliance

New Construction Work Covered Contracts

Plant Construction has been meeting with OEWD monthly to check in on participation and outreach goals.

C. PROJECTED 2024 ACTIVITIES

Public Meetings. Stockbridge / Wilson Meany YBI Investors plans to attend any re-established TIDA monthly meetings of the TI YBI Citizen Advisory Board (CAB), the TIDA Board, or the TIDA Infrastructure & Transportation Committee (ITC) to give construction updates.

Other Outreach Activities. Stockbridge / Wilson Meany YBI Investors, LLC will continue to work with One Treasure Island and its member organizations to promote opportunities for residents and businesses to participate in construction now that the project is further along and workforce requirements can be better projected.

Construction. Given the current market conditions, Wilson Meany has not yet awarded further construction contracts for 2024. It is anticipated that contracts will be awarded for the amenity building on 3Y and potentially the townhomes on 3Y in 2025.

SBE Professional Services Cumulative Report for 2023

2017 - 2023 Cumulative to Date										
Prime Consultant	San Francisco (SF) SBE or Non-SF SBE	Covered Professional Services	Total Contract Value (\$)	Amount Awarded to all SBE's (SF & Non-SF SBE) (\$)	Amount Awarded to San Francisco (SF) SBEs (\$)	Amount Awarded to Non-SF SBEs (\$)	Total Amount Paid to Date (\$)	Amount Paid to Date to All SBEs (SF & Non-SF SBE) (\$)	Amount Paid to Date to SF SBE (\$)	Amount Paid to Date to Non-SF SBE (\$)
1		Executive Architect	\$ 13,690,943.00	\$ 4,777,555.00	\$ 4,777,555.00	\$ -	\$ 11,340,174.00	\$ 3,815,278.00	\$ 3,815,278.00	\$ -
2		Geotechnical Engineering	\$ 1,405,162.60	\$ 201,440.00	\$ 201,440.00	\$ -	\$ 1,405,162.60	\$ 58,023.75	\$ 58,023.75	\$ -
3		Civil Engineering	\$ 1,827,201.00	\$ 929,928.50	\$ 929,928.50	\$ -	\$ 1,417,936.76	\$ 699,741.05	\$ 699,741.05	\$ -
4	(SF) SBE	Landscape Architecture	\$ 12,800.00	\$ 12,800.00	\$ 12,800.00	\$ -	\$ 12,800.00	\$ 12,800.00	\$ 12,800.00	\$ -
5		Design Architect	\$ 549,500.00	\$ -	\$ -	\$ -	\$ 539,766.84	\$ -	\$ -	\$ -
6		Civil Engineering and Survey	\$ 264,314.41	\$ -	\$ -	\$ -	\$ 264,314.41	\$ -	\$ -	\$ -
7		Signage Design	\$ 14,175.00	\$ -	\$ -	\$ -	\$ 11,137.50	\$ -	\$ -	\$ -
8		Security Consultant	\$ 58,800.00	\$ -	\$ -	\$ -	\$ 58,800.00	\$ -	\$ -	\$ -
9		Interior Design and FF&E	\$ 396,000.00	\$ -	\$ -	\$ -	\$ 396,000.00	\$ -	\$ -	\$ -
10	(SF) SBE	Interior Design and FF&E	\$ 75,000.00	\$ 75,000.00	\$ 75,000.00	\$ -	\$ 75,000.00	\$ 75,000.00	\$ 75,000.00	\$ -
11		Environmental Consultant	\$ 434,718.83	\$ -	\$ -	\$ -	\$ 433,763.66	\$ -	\$ -	\$ -
12		Archeological Services	\$ 31,650.00	\$ -	\$ -	\$ -	\$ 26,939.35	\$ -	\$ -	\$ -
13		Paleontological Services	\$ 31,270.00	\$ -	\$ -	\$ -	\$ 19,114.30	\$ -	\$ -	\$ -
14		Pool Design	\$ 27,500.00	\$ -	\$ -	\$ -	\$ 23,375.00	\$ -	\$ -	\$ -
15	(SF) SBE	Civil Engineering	\$ 70,000.00	\$ 70,000.00	\$ 70,000.00	\$ -	\$ 55,057.50	\$ 55,057.50	\$ 55,057.50	\$ -
16										
17										
18										
COVERED PROFESSIONAL SERVICES TOTALS (\$)			\$ 18,889,034.84	\$ 6,066,723.50	\$ 6,066,723.50	\$ -	\$ 16,079,341.92	\$ 4,715,900.30	\$ 4,715,900.30	\$ -
ACHIEVED SBE % (Goal = 38%)				32%	32%	0%		29%	29%	0%
% of Cumulative to Date Contract Total							85%	25%	25%	0%

SBE Professional Services Report for 2023

			2023								
Prime Consultant	San Francisco (SF) SBE or Non-SF SBE	Covered Professional Services	New Contracts Total (\$)	Existing Contracts Add Services Total (\$)	Amount Awarded to all SBE's (SF & Non-SF SBE) (\$)	Amount Awarded to San Francisco (SF) SBEs (\$)	Amount Awarded to Non-SF SBEs (\$)	2022 Contract Paid Total (\$)	Amount Paid to Date to All SBEs (SF & Non-SF SBE) (\$)	Amount Paid to Date to SF SBE (\$)	Amount Paid to Date to Non-SF SBE (\$)
1		Executive Architect	\$ -	\$ 305,249.00	\$ 90,000.00	\$ 90,000.00	\$ -	\$ 564,563.00	\$ 156,066.00	\$ 156,066.00	\$ -
2		Geotechnical Engineering	\$ -	\$ 464,106.60	\$ -	\$ -	\$ -	\$ 41,062.23	\$ -	\$ -	\$ -
3		Civil Engineering	\$ -	\$ 29,593.00	\$ 13,843.00	\$ 13,843.00	\$ -	\$ 63,828.35	\$ 55,377.00	\$ 55,377.00	\$ -
4	(SF) SBE	Landscape Architecture	\$ -	\$ -	\$ -	\$ -	\$ -	\$ -	\$ -	\$ -	\$ -
5		Design Architect	\$ -	\$ 180,000.00	\$ -	\$ -	\$ -	\$ 103,871.99	\$ -	\$ -	\$ -
6		Civil Engineering and Survey	\$ -	\$ 36,767.41	\$ -	\$ -	\$ -	\$ 39,265.73	\$ -	\$ -	\$ -
7		Signage Design	\$ -	\$ -	\$ -	\$ -	\$ -	\$ -	\$ -	\$ -	\$ -
8		Security Consultant	\$ -	\$ -	\$ -	\$ -	\$ -	\$ -	\$ -	\$ -	\$ -
9		Interior Design and FF&E	\$ -	\$ -	\$ -	\$ -	\$ -	\$ -	\$ -	\$ -	\$ -
10	(SF) SBE	Interior Design and FF&E	\$ -	\$ -	\$ -	\$ -	\$ -	\$ 35,000.00	\$ 35,000.00	\$ 35,000.00	\$ -
11		Environmental Consultant	\$ -	\$ 303,993.83	\$ -	\$ -	\$ -	\$ 150,718.83	\$ -	\$ -	\$ -
12		Archeological Services	\$ -	\$ -	\$ -	\$ -	\$ -	\$ 5,066.25	\$ -	\$ -	\$ -
13		Paleontological Services	\$ -	\$ -	\$ -	\$ -	\$ -	\$ -	\$ -	\$ -	\$ -
14		Pool Design	\$ -	\$ -	\$ -	\$ -	\$ -	\$ -	\$ -	\$ -	\$ -
15	(SF) SBE	Civil Engineering	\$ 70,000.00	\$ -	\$ 70,000.00	\$ 70,000.00	\$ -	\$ 55,057.50	\$ 55,057.50	\$ 55,057.50	\$ -
16											
17											
18											
COVERED PROFESSIONAL SERVICES TOTALS (\$)			\$ 70,000.00	\$ 1,319,709.84	\$ 173,843.00	\$ 173,843.00	\$ -	\$ 1,058,433.88	\$ 301,500.50	\$ 301,500.50	\$ -
ACHIEVED SBE % (Goal = 38%)					13%	13%	0%		28%	28%	0%
% of Cumulative to Date Contract Total								80%	23%	23%	0%

SBE Cumulative Construction Contracts Report for 2023

		2017 - 2023 Cumulative to Date								
	Contractor	Covered Scope of Work	Total Contract Value (\$)	Amount Awarded to all SBE's (SF & Non-SF SBE) (\$)	Amount Awarded to San Francisco (SF) SBEs (\$)	Amount Awarded to Non-SF SBEs (\$)	Total Amount Paid to Date (\$)	Amount Paid to Date to All SBEs (SF & Non-SF SBE) (\$)	Amount Paid to Date to SF SBE (\$)	Amount Paid to Date to Non-SF SBE (\$)
1	Cahill Contractors - Sub-contractors	The Bristol	\$ 117,550,838.00	\$ 25,842,135.00	\$ 9,602,473.00	\$ 16,239,662.00	\$ 117,544,579.00	\$ 25,842,135.00	\$ 9,602,473.00	\$ 16,239,662.00
4	Plant Construction Company	4Y Early Work	\$ 8,088,110.00	\$ 601,535.00	\$ 382,880.00	\$ 218,655.00	\$ 8,088,110.00	\$ 601,535.00	\$ 382,880.00	\$ 218,655.00
5	Plant Construction Company	4Y Phase 1	\$ 81,525,228.00	\$ 18,543,271.00	\$ 9,043,816.00	\$ 9,499,455.00	\$ 73,146,125.00	\$ 16,105,231.00	\$ 8,350,825.00	\$ 7,754,406.00
6										
7										
8										
9										
10										
11										
12										
13										
14										
15										
16										
17										
18										
COVERED CONSTRUCTION CONTRACTS TOTALS (\$)			\$ 207,164,176.00	\$ 44,986,941.00	\$ 19,029,169.00	\$ 25,957,772.00	\$ 198,778,814.00	\$ 42,548,901.00	\$ 18,336,178.00	\$ 24,212,723.00
ACHIEVED SBE % (Goal = 38%)				22%	9%	13%		21%	9%	12%
% of Cumulative to Date Contract Total							96%	21%	9%	12%

SBE Construction Contracts Report for 2023

		2023									
Contractor	Covered Scope of Work	New Contracts Total (\$)	Existing Contracts Add Services Total (\$)	Amount Awarded to all SBE's (SF & Non-SF SBE) (\$)	Amount Awarded to San Francisco (SF) SBEs (\$)	Amount Awarded to Non-SF SBEs (\$)	2023 Contract Paid Total (\$)	Amount Paid to Date to All SBEs (SF & Non-SF SBE) (\$)	Amount Paid to Date to SF SBE (\$)	Amount Paid to Date to Non-SF SBE (\$)	
2	Plant Construction Company	4Y Phase 1	\$ -	\$ 6,014,169.00	\$ 356,460.00	\$ 311,977.00	\$ 44,483.00	\$ 3,058,161.00	\$ 498,105.00	\$ 164,174.00	\$ 333,931.00
3			\$ -	\$ -	\$ -	\$ -	\$ -	\$ -	\$ -	\$ -	\$ -
4			\$ -	\$ -	\$ -	\$ -	\$ -	\$ -	\$ -	\$ -	\$ -
5			\$ -	\$ -	\$ -	\$ -	\$ -	\$ -	\$ -	\$ -	\$ -
6			\$ -	\$ -	\$ -	\$ -	\$ -	\$ -	\$ -	\$ -	\$ -
7			\$ -	\$ -	\$ -	\$ -	\$ -	\$ -	\$ -	\$ -	\$ -
8			\$ -	\$ -	\$ -	\$ -	\$ -	\$ -	\$ -	\$ -	\$ -
9			\$ -	\$ -	\$ -	\$ -	\$ -	\$ -	\$ -	\$ -	\$ -
10			\$ -	\$ -	\$ -	\$ -	\$ -	\$ -	\$ -	\$ -	\$ -
11			\$ -	\$ -	\$ -	\$ -	\$ -	\$ -	\$ -	\$ -	\$ -
12			\$ -	\$ -	\$ -	\$ -	\$ -	\$ -	\$ -	\$ -	\$ -
13			\$ -	\$ -	\$ -	\$ -	\$ -	\$ -	\$ -	\$ -	\$ -
14			\$ -	\$ -	\$ -	\$ -	\$ -	\$ -	\$ -	\$ -	\$ -
15											
16											
17											
18											
COVERED PROFESSIONAL SERVICES TOTALS (\$)		\$ -	\$ 6,014,169.00	\$ 356,460.00	\$ 311,977.00	\$ 44,483.00	\$ 3,058,161.00	\$ 498,105.00	\$ 164,174.00	\$ 333,931.00	
ACHIEVED SBE % (Goal = 38%)				6%	5%	1%		16%	5%	11%	
% of Cumulative to Date Contract Total							51%	8%	3%	6%	

FORM 3: SBE GOAL MEASUREMENT

This SBE Goal Measurement is to be provided by a Consultant or Subconsultant with its monthly progress payment request and upon final payment for the applicable Covered Contract under the Small Business Enterprise Procedures (Treasure Island/Yerba Buena Island) (as amended, the “SBE Procedures”). Capitalized terms used but not defined in this SBE Goal Measurement have the meanings ascribed to them in the SBE Procedures.

For column “A”, list the prime Consultant, each joint venture/associate partner and ALL Subconsultants including 2nd and 3rd tier Subconsultants. Make copies if more space is needed. Prime Consultant must retain copies of all the prime and subconsultant invoices supporting the information tabulated for this form. Information related to the Covered Contract must be retained and provided to the Authority in accordance with Section VII.C of the SBE Procedures.

Identify SBE Goal of this contract: %

A	B	C	D	E	F	G	H
Name of Firm. List prime Consultant, including each JV/Association partner, and all Subconsultants. Indicate if the firm is a San Francisco SBE or Other SBE	Service Performed	Dollar Value of Covered Contract at Time of Award	Amount of Modifications to Date	Total Amount of Covered Contract to Date +/- Modifications (C + D) or (C-D)	Amount Invoiced this Reporting Period	Amount Invoiced to Date	Percent Complete to Date (G÷E)
BDE Architecture	Architect of Record	3,259,500	1,477,752	4,737,252	295,822	3,827,880	81 %
Hart Howerton	Design Architect	1,697,373	413,064	2,110,437	7,011	1,883,118	89 %
Aidlin Darling	Design Architect	0	597,978	597,978	0	504,442	84 %
Cliff Lowe/Hart Howerton (CLA SBE)	Landscape	1,012,000	275,797	1,287,797	18,577	1,200,602	81 %
KPFF/Rivera (Rivera SBE)	Structural	233,000	-156,000	77,000	0	77,000	100 %
DCI/Structura (Structus SBE)	Structural	670,000	1,040,000	1,710,000	117,595	1,200,602	70 %
Meyer Davis	Interior Design	0	561,278	561,278	82,763	557,106	99 %
San Francisco SBE Professional Fees							%
Other (Non-SF) SBE Professional Fees							%
All SBE Professional Fees Sub-Totals							%
Non-SBE Professional Fees Sub-Totals							%
SBE & Non-SBE Professional Fees Totals							%
Reimbursable Expenses							%
CONTRACT TOTALS							%

FORM 3: SBE GOAL MEASUREMENT

This SBE Goal Measurement is to be provided by a Consultant or Subconsultant with its monthly progress payment request and upon final payment for the applicable Covered Contract under the Small Business Enterprise Procedures (Treasure Island/Yerba Buena Island) (as amended, the “SBE Procedures”). Capitalized terms used but not defined in this SBE Goal Measurement have the meanings ascribed to them in the SBE Procedures.

For column “A”, list the prime Consultant, each joint venture/associate partner and ALL Subconsultants including 2nd and 3rd tier Subconsultants. Make copies if more space is needed. Prime Consultant must retain copies of all the prime and subconsultant invoices supporting the information tabulated for this form. Information related to the Covered Contract must be retained and provided to the Authority in accordance with Section VII.C of the SBE Procedures.

Identify SBE Goal of this contract: %

A Name of Firm. List prime Consultant, including each JV/Association partner, and all Subconsultants. Indicate if the firm is a San Francisco SBE or Other SBE	B Service Performed	C Dollar Value of Covered Contract at Time of Award	D Amount of Modifications to Date	E Total Amount of Covered Contract to Date +/- Modifications (C + D) or (C-D)	F Amount Invoiced this Reporting Period	G Amount Invoiced to Date	H Percent Complete to Date (G÷E)
Hart Howerton	Interior Design	105,000	-105,000	0	0	0	100 %
ELA (SBE)	Interior Design	540,000	-112,800	427,200	0	394,829	98 %
Watry	Parking	32,500	-19,375	13,125	0	13,125	100 %
Charles M. Salter Associates	Acoustical	115,000	4,500	119,500	1,380	77,710	65 %
Cross 2 Design Group	Waterproofing	204,900	77,268	282,168	4,145	195,627	69 %
Hiram Banks Lighting Design (SBE)	Lighting	124,980	58,620	183,600	0	172,921	94 %
The Fire Consultants	FLS Code Consulting	57,500	10,280	67,780	7,215	60,880	90 %
San Francisco SBE Professional Fees							%
Other (Non-SF) SBE Professional Fees							%
All SBE Professional Fees Sub-Totals							%
Non-SBE Professional Fees Sub-Totals							%
SBE & Non-SBE Professional Fees Totals							%
Reimbursable Expenses							%
CONTRACT TOTALS							%

FORM 3: SBE GOAL MEASUREMENT

This SBE Goal Measurement is to be provided by a Consultant or Subconsultant with its monthly progress payment request and upon final payment for the applicable Covered Contract under the Small Business Enterprise Procedures (Treasure Island/Yerba Buena Island) (as amended, the “SBE Procedures”). Capitalized terms used but not defined in this SBE Goal Measurement have the meanings ascribed to them in the SBE Procedures.

For column “A”, list the prime Consultant, each joint venture/associate partner and ALL Subconsultants including 2nd and 3rd tier Subconsultants. Make copies if more space is needed. Prime Consultant must retain copies of all the prime and subconsultant invoices supporting the information tabulated for this form. Information related to the Covered Contract must be retained and provided to the Authority in accordance with Section VII.C of the SBE Procedures.

Identify SBE Goal of this contract: %

A	B	C	D	E	F	G	H
Name of Firm. List prime Consultant, including each JV/Association partner, and all Subconsultants. Indicate if the firm is a San Francisco SBE or Other SBE	Service Performed	Dollar Value of Covered Contract at Time of Award	Amount of Modifications to Date	Total Amount of Covered Contract to Date +/- Modifications (C + D) or (C-D)	Amount Invoiced this Reporting Period	Amount Invoiced to Date	Percent Complete to Date (G÷E)
Meyers + Engineering (SBE)	MEP, LV	1,063,000	-261,322	801,678	0	793,775	99 %
Gabel (SBE)	Title 24	82,000	60,300	142,300	0	89,011	63 %
Bright Green Strategies (SBE)	Sustainability/ Green	63,500	148,000	211,500	12,700	64,829	31 %
Sit-Co.	EBMS	24,000	36,700	60,700	0	31,827	52 %
American Trash Management	Waste Consulting	19,700	19,700	39,400	0	14,000	36 %
LCM Architects	ADA Consulting	121,245	128,005	249,250	1,443	49,003	20 %
Structus	Structural		11,000	11,000	0	11,470	104 %
San Francisco SBE Professional Fees		3,763,980	1,013,575	4,777,555	156,066	3,815,278	%
Other (Non-SF) SBE Professional Fees							%
All SBE Professional Fees Sub-Totals		3,763,980	1,013,575	4,777,555	156,066	3,815,278	%
Non-SBE Professional Fees Sub-Totals		5,661,218	3,252,170	8,913,388	392,564	7,242,849	%
SBE & Non-SBE Professional Fees Totals		9,425,198	4,265,745	13,690,943	548,630	11,058,127	%
Reimbursable Expenses					15,933	282,047	%
CONTRACT TOTALS		9,425,198	4,265,745	13,690,943	564,563	11,340,174	%

Amended 09.14.2016

FORM 3: SBE GOAL MEASUREMENT

This SBE Goal Measurement is to be provided by a Contractor or Subcontractor with its monthly progress payment request and upon final payment for the applicable Covered Contract under the Small Business Enterprise Procedures (Treasure Island/Yerba Buena Island) (as amended, the “SBE Procedures”). Capitalized terms used but not defined in this SBE Goal Measurement have the meanings ascribed to them in the SBE Procedures.

For column “A”, list the prime Contractor, each joint venture/associate partner and ALL Subcontractors including 2nd and 3rd tier Subcontractors. Make copies if more space is needed. Prime Contractor must retain copies of all the prime and subcontractor invoices supporting the information tabulated for this form. Information related to the Covered Contract must be retained and provided to the Authority in accordance with Section VII.C of the SBE Procedures.

Identify SBE Goal of this contract:

A	B	C	D	E	F	G	H
Name of Firm. List prime Contractor, including each JV/Association partner, and all Subcontractors. (Indicate if the firm is a San Francisco SBE or Other SBE)	Service Performed	Dollar Value of Covered Contract at Time of Award	Amount of Modifications to Date	Total Amount of Covered Contract to Date +/- Modifications (C + D) or (C-D)	Amount Invoiced this Reporting Period	Amount Invoiced to Date	Percent Complete to Date (G÷E)
ENGEO Incorporated (prime)	Geotechnical	\$ 294,284.00	\$445,332.00	\$739,616.00	\$41,062.23	\$1,347,138.85	182%
Terra Engineers (SF SBE)	Geotechnical	\$158,460.00	\$42,980.00	\$201,440.00		\$58,023.75	8%
				\$0.00		\$0.00	0%
				\$0.00		\$0.00	0%
				\$0.00		\$0.00	#DIV/0!
							#DIV/0!
San Francisco SBE Professional Fees		\$158,460.00	\$42,980.00	\$201,440.00	\$0.00	\$58,023.75	8%
Other (Non-SF) SBE Professional Fees							#DIV/0!
All SBE Professional Fees Sub-Totals		\$158,460.00	\$42,980.00	\$201,440.00	\$0.00	\$58,023.75	29%
Non-SBE Professional Fees Sub-Total		\$294,284.00	\$445,332.00	\$739,616.00	\$41,062.23	\$1,347,138.85	182%
SBE & Non-SBE Professional Fees Totals		\$452,744.00	\$488,312.00	\$941,056.00	\$41,062.23	\$1,405,162.60	149%
Reimbursable Expenses				\$0.00			#DIV/0!
CONTRACT TOTALS		\$452,744.00	\$488,312.00	\$941,056.00	\$41,062.23	\$1,405,162.60	149%

EXHIBIT A

YBI CIVIL ENGINEERING AND DRY UTILITIES - SBE SUMMARY FOR 2023

**SMALL BUSINESS ENTERPRISE PROCEDURES
(TREASURE ISLAND/YERBA BUENA ISLAND)**

Professional Services

FORM 3: SBE GOAL MEASUREMENT

This SBE Goal Measurement is to be provided by a Consultant or Subconsultant with its monthly progress payment request and upon final payment for the applicable Covered Contract under the Small Business Enterprise Procedures (Treasure Island/Yerba Buena Island) (as amended, the "SBE Procedures"). Capitalized terms used but not defined in this SBE Goal Measurement have the meanings ascribed to them in the SBE Procedures.

For column "A", list the prime Consultant, each joint venture/associate partner and ALL Subconsultants including 2nd and 3rd tier Subconsultants. Make copies if more space is needed. Prime Consultant must retain copies of all the prime and subconsultant invoices supporting the information tabulated for this form. Information related to the Covered Contract must be retained and provided to the Authority in accordance with Section VII.C of the SBE Procedures.

Identify SBE Goal of this contract:	%							
A		B	C	D	E	F	G	H
Name of Firm. List prime Consultant, including each JV/Association partner, and all Subconsultants. Indicate if the firm is a San Francisco SBE or Other SBE		Service Performed	Dollar Value of Covered Contract at Time of Award	Amount of Modifications to Date	Total Amount of Covered Contract to Date +/- Modifications (C + D) or (C-D)	Amount Invoiced 2023	Amount Invoiced from Beginning of Contract to End of 2023	Percent Complete to Date (G÷E)
KPFF - PRIME		CIVIL ENGINEERING	\$263,400.00	\$ 320,772.50	\$ 584,172.50	\$ 15,512.06	\$466,699.83	79.89%
SAGE - SF SBE		CIVIL ENGINEERING	\$ 207,000.00	\$ 100,200.00	\$ 307,200.00	\$ 26,934.00	\$221,740.55	72.18%
KCA - SF SBE		SURVEYING/MAPPING	\$ 203,400.00	\$ 419,328.50	\$ 622,728.50	\$ 28,443.00	\$478,000.50	76.76%
GICALONE		DRY UTILITY CONSULTANT	\$ 186,000.00	\$ 122,500.00	\$ 308,500.00	\$ 600.00	\$257,742.09	83.55%
San Francisco SBE Professional Fees			\$ 410,400.00	\$ 519,528.50	\$ 929,928.50	\$ 55,377.00	\$699,741.05	75.25%
Other (Non-SF) SBE Professional Fees								
All SBE Professional Fees Sub-Totals			\$ 410,400.00	\$ 519,528.50	\$ 929,928.50	\$ 55,377.00	\$699,741.05	75.25%
Non-SBE Professional Fees Sub-Totals			\$ 449,400.00	\$ 443,272.50	\$ 892,672.50	\$ 16,112.06	\$724,441.92	81.15%
SBE & Non-SBE Professional Fees Totals			\$ 859,800.00	\$ 962,801.00	\$ 1,822,601.00	\$ 63,739.06	\$1,416,432.97	77.71%
Reimbursable Expenses			\$4,600.00		\$ 4,600.00	\$ 89.29	\$1,503.79	32.69%
CONTRACT TOTALS			\$864,400.00	\$ 962,801.00	\$ 1,827,201.00	\$ 63,828.35	\$1,417,936.76	77.60%

FORM 3: SBE GOAL MEASUREMENT

This SBE Goal Measurement is to be provided by a Consultant or Subconsultant with its monthly progress payment request and upon final payment for the applicable Covered Contract under the Small Business Enterprise Procedures (Treasure Island/Yerba Buena Island) (as amended, the “SBE Procedures”). Capitalized terms used but not defined in this SBE Goal Measurement have the meanings ascribed to them in the SBE Procedures.

For column “A”, list the prime Consultant, each joint venture/associate partner and ALL Subconsultants including 2nd and 3rd tier Subconsultants. Make copies if more space is needed. Prime Consultant must retain copies of all the prime and subconsultant invoices supporting the information tabulated for this form. Information related to the Covered Contract must be retained and provided to the Authority in accordance with Section VII.C of the SBE Procedures.

Identify SBE Goal of this contract: %

A Name of Firm. List prime Consultant, including each JV/Association partner, and all Subconsultants. Indicate if the firm is a San Francisco SBE or Other SBE	B Service Performed	C Dollar Value of Covered Contract at Time of Award	D Amount of Modifications to Date	E Total Amount of Covered Contract to Date +/- Modifications (C + D) or (C-D)	F Amount Invoiced this Reporting Period	G Amount Invoiced to Date	H Percent Complete to Date (G÷E)
SAGE Consulting Engineers, Inc. (SBE)	Civil Engineering	\$70,000.00	\$0.00	\$70,000.00	\$55,057.50	\$55,057.50	78.6 %
							%
							%
							%
							%
							%
							%
San Francisco SBE Professional Fees							%
Other (Non-SF) SBE Professional Fees							%
All SBE Professional Fees Sub-Totals							%
Non-SBE Professional Fees Sub-Totals							%
SBE & Non-SBE Professional Fees Totals							%
Reimbursable Expenses							%
CONTRACT TOTALS							%

FORM 3: SBE GOAL MEASUREMENT

This SBE Goal Measurement is to be provided by a Contractor or Subcontractor with its monthly progress payment request and upon final payment for the applicable Covered Contract under the Small Business Enterprise Procedures (Treasure Island/Yerba Buena Island) (as amended, the "SBE Procedures"). Capitalized terms used but not defined in this SBE Goal Measurement have the meanings ascribed to them in the SBE Procedures.
For column "A", list the prime Contractor, each joint venture/associate partner and ALL Subcontractors including 2nd and 3rd tier Subcontractors. Make copies if more space is needed. Prime Contractor must retain copies of all the prime and subcontractor invoices supporting the information tabulated for this form. Information related to the Covered Contract must be retained and provided to the Authority in accordance with Section VII.C of the SBE Procedures.

Identify SBE Goal of this contract: **41%**

A	B	C	D	E	F	G	H
Name of Firm. List prime Contractor, including each JV/Association partner, and all Subcontractors. Indicate if the firm is a San Francisco SBE or Other SBE	Service Performed	Dollar Value of Covered Contract at Time of Award	Amount of Modifications to Date	Total Amount of Covered Contract to Date +/□ Modifications (C + D) or (C/D)	Amount Invoiced this Reporting Period	Amount Invoiced to Date	Percent Complete to Date (G+E)
Plant	GC costs including B21	\$ 5,521,902.00	\$ 10,677,772.00	\$ 16,199,674.00	\$ 1,289,925.00	\$ 13,732,609.00	85%
Aclarity Systems	Security Systems	\$ 98,100.00	\$ 12,883.00	\$ 110,983.00		\$ 110,983.00	100%
Acosta & Sons (Other SBE)	Photovoltaic Collectors	\$ 142,300.00	\$ (33,691.00)	\$ 108,609.00		\$ 90,643.00	83%
Acosta & Sons (Other SBE)	Railings	\$ 650,000.00	\$ 102,274.00	\$ 752,274.00	\$ 120,907.00	\$ 639,433.00	85%
Alaco Ladder	Ladders & Fall Protection	\$ 8,863.00		\$ 8,863.00		\$ 8,863.00	100%
Anning Johnson	Plaster	\$ 3,331,565.00	\$ 217,775.00	\$ 3,549,340.00	\$ 42,515.00	\$ 3,379,043.00	95%
Anning Johnson	Structural Metal Stud Framing	\$ 3,815,236.00	\$ 385,698.00	\$ 4,200,934.00		\$ 4,200,934.00	100%
Azul Works	Site Utilities	\$ 2,308,950.00	\$ 1,814,583.00	\$ 4,123,533.00		\$ 4,007,942.00	97%
Bay Area Concrete (Other SBE)	Site Concrete	\$ 639,038.00		\$ 639,038.00	\$ 31,000.00	\$ 487,118.00	76%
Bay City Mechanical	HVAC	\$ 1,875,065.00	\$ 99,651.00	\$ 1,974,716.00	\$ 3,582.00	\$ 1,934,625.00	98%
Bei Steel (Other SBE)	Metal Stairs	\$ 353,575.00	\$ 7,572.00	\$ 361,147.00		\$ 361,147.00	100%
CA Tile Installers	Tiling	\$ 3,346,341.00	\$ 158,646.00	\$ 3,504,987.00	\$ 329,630.00	\$ 2,827,733.00	81%
CA Water Trucks & Street Sweepers Inc	Street Sweeper	\$ 33,425.00		\$ 33,425.00		\$ 19,720.00	59%
Capital Bldg Maintenance (Other SBE)	Cleaning	\$ 14,040.00	\$ 6,060.00	\$ 20,100.00	\$ 1,250.00	\$ 18,090.00	90%
Capital Bldg Maintenance (Other SBE)	Cleaning	\$ 58,650.00		\$ 58,650.00		\$ -	0%
CBF Inc	Electrical for Bldg 21	\$ 236,010.00		\$ 236,010.00	\$ 2,301.00	\$ 233,210.00	99%
Cell Crete	Gyp-crete	\$ 199,370.00		\$ 199,370.00	\$ 28,401.00	\$ 199,370.00	100%
Cedar Hills Investment Group	Galvanized Steel Bollards	\$ 8,348.00		\$ 8,348.00		\$ -	0%
Chrisp Company	Signage and Striping	\$ 8,000.00		\$ 8,000.00		\$ 6,950.00	87%
Conco	Structural Concrete	\$ 3,267,200.00	\$ 98,392.00	\$ 3,365,592.00		\$ 3,365,592.00	100%
Concrete Wall Sawing Co	Saw Cutting	\$ 2,970.00		\$ 2,970.00		\$ 2,970.00	100%
Creative Shower Doors (Other SBE)	Showers, doors, bath, accessories,	\$ 224,124.00		\$ 224,124.00		\$ 90,444.00	40%
Crown Masonry (Other SBE)	Concrete Masonry & Wall Caps	\$ 246,125.00	\$ (92,223.00)	\$ 153,902.00	\$ 38,357.00	\$ 144,155.00	94%
Desilva Gates	Dewatering	\$ 35,410.00	\$ 1,110.00	\$ 36,520.00		\$ 36,520.00	100%
Earth Cam	Camera Services	\$ 20,129.00	\$ 750.00	\$ 20,879.00		\$ 20,879.00	100%
Egan Plumbing (Other SBE)	Plumbing	\$ 3,859,770.00	\$ 406,190.00	\$ 4,265,960.00		\$ 3,872,412.00	91%
EJ Weber (SBA LBE)	Security & Communications Sytems	\$ 443,189.00	\$ 210,672.00	\$ 653,861.00		\$ 595,768.00	91%
FD Thomas	Roofing	\$ 686,928.00	\$ 601,427.00	\$ 1,288,355.00		\$ 1,260,082.00	98%
FD Thomas	Waterproofing	\$ 612,100.00	\$ 66,465.00	\$ 678,565.00		\$ 614,882.00	91%
G&M Appliances (Other SBE)	Residential Appliances	\$ 76,064.00		\$ 76,064.00		\$ 32,431.00	43%
Giacalone Design	Temp Power Design	\$ 15,000.00		\$ 15,000.00		\$ 3,750.00	25%
Ground Control Systems (Other SBE)	Bicycle Equipment	\$ 7,814.00		\$ 7,814.00		\$ 7,814.00	100%
KCA Engineers (SF SBE)	Surveying	\$ 50,000.00	\$ 160,093.00	\$ 210,093.00		\$ 210,093.00	100%
Lahue & Associates	Signage	\$ 75,495.00		\$ 75,495.00	\$ 14,200.00	\$ 14,200.00	19%
Malcolm Drilling	Earthshoring & Underpinning	\$ 367,130.00	\$ 358,344.00	\$ 725,474.00		\$ 725,474.00	100%
Marina Mech	Sheet Metal	\$ 1,759,500.00	\$ 79,064.00	\$ 1,838,564.00	\$ 86,800.00	\$ 1,774,514.00	97%
MGM Drywall	Drywall	\$ 3,267,492.00	\$ 1,187,540.00	\$ 4,455,032.00	\$ 189,141.00	\$ 4,455,032.00	100%
Multivista (SF SBE)	Scanning Documentation	\$ 3,600.00	\$ 3,600.00	\$ 7,200.00		\$ 7,200.00	100%
NC Flooring (Other SBE)	Wood/Rubber Flooring	\$ 1,500,309.00	\$ 134,582.00	\$ 1,634,891.00	\$ 62,279.00	\$ 1,207,204.00	74%
Nor-cal Scaffolding (Other SBE)	Stair Scaffold	\$ 5,530.00	\$ 6,178.00	\$ 11,708.00	\$ 1,907.00	\$ 11,708.00	100%
North Bay Overhead Doors (Other SBE)	Overhead Doors	\$ 115,600.00	\$ 106,800.00	\$ 222,400.00		\$ 133,440.00	60%
Obayashi	Rough Carpentry	\$ 3,618,981.00	\$ 2,529,219.00	\$ 6,148,200.00		\$ 6,148,200.00	100%
Pacific Access Contractors (Other SBE)	Elevator Work	\$ 156,500.00		\$ 156,500.00		\$ 109,550.00	70%
Performance Contracting Inc	Exterior Scaffolding	\$ 467,152.00	\$ 362,095.00	\$ 829,247.00	\$ 58,871.00	\$ 507,307.00	61%
Performance Contracting Inc	Thermal and Acoustical Insulation	\$ 353,914.00	\$ 32,907.00	\$ 386,821.00		\$ 386,821.00	100%
Pinnacle Installations	Material Deposits for Glass	\$ 1,948,728.00	\$ (1,577,029.00)	\$ 371,699.00		\$ 371,699.00	100%
Plant Construction LP (Total: 1,316,537)	Self-Perform Concrete	\$ 347,121.00	\$ 787,384.00	\$ 1,134,505.00	\$ 76,416.00	\$ 960,544.00	85%
Dolan Concrete (Lower tier to Plant)	Concrete Pumping & Placement	\$ 36,000.00	\$ 150,398.00	\$ 186,398.00	\$ 14,607.00	\$ 54,555.00	29%
Dees Hennessey (Lower Tier to Plant)	Shotcrete	\$ 21,000.00	\$ 77,980.00	\$ 98,980.00	\$ 6,500.00	\$ 34,980.00	35%
Interstate Concrete Pumping Lower Tier to Plant	Concrete Pumping	\$ 4,000.00	\$ 9,040.00	\$ 13,040.00		\$ 10,610.00	81%
Transpacific Steel (SF SBE) Lower Tier to Plant	Rebar	\$ 128,512.00	\$ 41,302.00	\$ 169,814.00		\$ 169,814.00	100%
Tuan & Robinson (SF LBE)	Engineering & Construction Docs	\$ 11,000.00	\$ 5,000.00	\$ 16,000.00	\$ 8,000.00	\$ 16,000.00	100%
Platt Electric Supply	EV Chargers	\$ 295,089.00	\$ 32,080.00	\$ 327,169.00	\$ 17,610.00	\$ 320,506.00	98%
PMR Pacific Sealants	Joint Sealants	\$ 9,105.00		\$ 9,105.00		\$ 9,053.00	99%
Precision Ladders	Ladders & Roof Hatch	\$ 14,325.00		\$ 14,325.00		\$ 11,321.00	79%
Pribuss Engineering	Fire Protection Design Build	\$ 546,117.00	\$ 173,235.00	\$ 719,352.00		\$ 690,501.00	96%
R&B Wholesale Distributors	Residential Appliances	\$ 69,170.00		\$ 69,170.00	\$ 15,474.00	\$ 42,644.00	62%
Riggs Distributing	Residential Appliances	\$ 598,902.00	\$ (28,577.00)	\$ 570,325.00	\$ 83,347.00	\$ 522,480.00	92%
RT Western (SBA LBE)	Doors, Frames, Hardware	\$ 952,289.00	\$ 279,060.00	\$ 1,231,349.00	\$ 91,365.00	\$ 1,143,656.00	93%
RT Western (Total: 706,385) (SBA LBE)	Finish Carpentry	\$ 180,123.00	\$ 23,682.00	\$ 203,805.00	\$ 11,297.00	\$ 148,227.00	73%
Sullivan Construction Co (Other SBE) (Lower Tier)	Finish Carpentry	\$ 502,204.00	\$ 376.00	\$ 502,580.00	\$ 78,231.00	\$ 324,235.00	65%
Scaffold Inspection & Testing CO (Other SBE)	Exterior Scaffolding	\$ 107,908.00		\$ 107,908.00		\$ 49,823.00	46%
SDI Insulation	Fireplaces	\$ 191,119.00	\$ 37,763.00	\$ 228,882.00		\$ 228,882.00	100%
Sheedy Dryage	Tower Cranes	\$ 7,000.00		\$ 7,000.00		\$ 5,501.00	79%
Shooter & Butts	Landscaping	\$ 1,136,905.00	\$ (111,987.00)	\$ 1,024,918.00	\$ 177,036.00	\$ 370,876.00	36%
Sierra Electric (Total: 3,819,620) (SBA LBE)	Electrical	\$ 3,593,374.00	\$ 178,150.00	\$ 3,771,524.00	\$ 39,312.00	\$ 3,771,524.00	100%
IDT (Lower Tier to Sierra)	Data & Telecommunications	\$ 74,185.00		\$ 74,185.00		\$ 74,185.00	100%
SF Concrete Scanning & Coring (SF SBE)	Concrete Scanning	\$ 7,750.00		\$ 7,750.00		\$ 7,750.00	100%
Smoke Guard	Elevator Smoke Doors	\$ 157,600.00		\$ 157,600.00	\$ 137,900.00	\$ 137,900.00	88%
Specialties, Etc. Corp (SF SBE)	Mailboxes	\$ 7,957.00		\$ 7,957.00		\$ 7,139.00	90%
Submeter Solutions Inc.	Submeters, transceivers, data loggers,	\$ 17,613.00	\$ (1,260.00)	\$ 16,353.00		\$ 7,835.00	48%
Terminex	Pest Control	\$ 2,640.00	\$ 3,235.00	\$ 5,875.00		\$ 2,908.00	49%
TK Elevator Corp	Elevators	\$ 453,780.00	\$ 145,879.00	\$ 599,659.00		\$ 567,356.00	95%
Tom's Metal Specialist (SF SBE)	Metal Railings & Misc Metals	\$ 706,156.00	\$ 25,514.00	\$ 731,670.00		\$ 470,663.00	64%
Tom's Metal Specialist (SF SBE)	Structural Steel	\$ 449,837.00	\$ 21,263.00	\$ 471,100.00		\$ 471,100.00	100%
Towill (Other SBE)	Staking/Surveying Services	\$ 87,303.00	\$ 66,294.00	\$ 153,597.00		\$ 153,597.00	100%
Tuan & Robinson (SF LBE)	Temporary Shoring	\$ 3,000.00		\$ 3,000.00		\$ 3,000.00	100%
Universal Plastics (Other SBE)	Plastic Fabrications	\$ 18,597.00		\$ 18,597.00		\$ -	0%
USGA (Other SBE)	Glass & Glazing	\$ 2,598,545.00	\$ 229,472.00	\$ 2,828,017.00		\$ 2,385,196.00	84%
Valdez Painting	Painting	\$ 828,422.00	\$ 132,315.00	\$ 960,737.00		\$ 649,666.00	68%
Woodford Studio (SF SBE)	Furnish Millwork & Cabinetry.	\$ 785,772.00	\$ 336,279.00	\$ 1,122,051.00		\$ 953,544.00	85%
San Francisco SBE Professional Fees		\$ 7,751,629.00	\$ 1,292,187.00	\$ 9,043,816.00	\$ 164,174.00	\$ 8,350,825.00	92%
Other (Non-SF) SBE Professional Fees		\$ 10,364,604.00	\$ (865,149.00)	\$ 9,499,455.00	\$ 333,931.00	\$ 7,754,406.00	82%
All SBE Professional Fees Sub-Totals		\$ 18,116,233.00	\$ 427,038.00	\$ 18,543,271.00	\$ 498,105.00	\$ 16,105,231.00	87%
Non-SBE Professional Fees Sub-Totals		\$ 42,669,719.00	\$ 20,312,238.00	\$ 62,981,957.00	\$ 2,560,056.00	\$ 57,040,894.00	91%
SBE & Non-SBE Professional Fees Totals		\$ 60,000,180.00	\$ 20,402,997.00	\$ 80,403,177.00	\$ 3,058,161.00	\$ 73,146,125.00	91%
Reimbursable Expenses							%
CONTRACT TOTALS							%