

## Facility Maps

### Maps should not exceed 11" x 17"

Facility maps are intended to aid Emergency First Responders in the event of fires or other disasters. The maps should be clearly drawn and legible. There is no need to have the maps drawn by a professional. Maps with extraneous information (**i.e. engineering drawings & blueprints**) are unacceptable. To prepare facility maps:

- A. Use the standardized symbols found on the map key on the next page.
- B. **At a minimum, the map shall include (*if applicable*) the locations of the following, per HSC 6.95 25505(a)(2), 25508(a)(1):**
  - 1) North orientation
  - 2) Loading area(s)
  - 3) Internal roads and adjacent streets
  - 4) Storm and sewer drains
  - 5) Access and exit points
  - 6) Emergency shutoffs
  - 7) Evacuation staging area(s)
  - 8) Hazardous material handling and storage areas
  - 9) Emergency response equipment

Once the facility site map(s) minimum requirements have been met, upload an electronic copy to the California Environmental Reporting System (CERS).

<http://cers.calepa.ca.gov/>

## MAP SYMBOLS

At a minimum, the shall map include ( if applicable) the locations of the following, per HSC 6.95, 25505(a)(2), 25508(a)(1)

- |  |  |
|--|--|
| 1) North orientation                   | 2) Loading area(s)                               |
| 3) Internal roads and adjacent streets | 4) Storm and sewer drains                        |
| 5) Access and exit points              | 6) Emergency shutoffs                            |
| 7) Evacuation staging area(s)          | 8) Hazardous material handling and storage areas |
| 9) Emergency response equipment        |  |

Use these symbols to designate general site safety/fire protection locations:

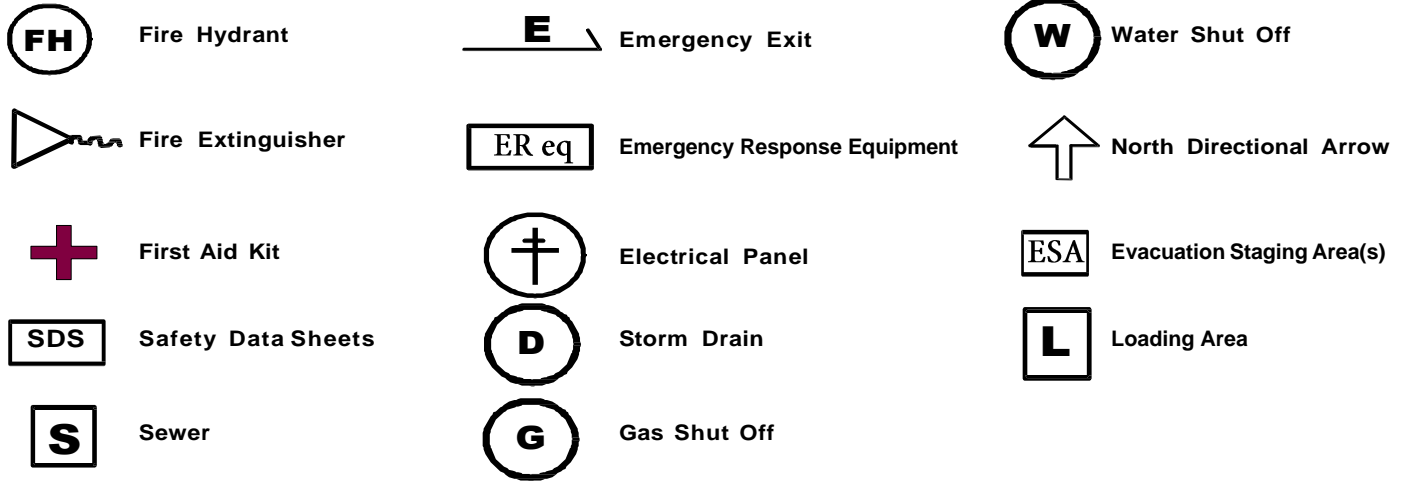

Use these symbols to designate hazardous materials locations:

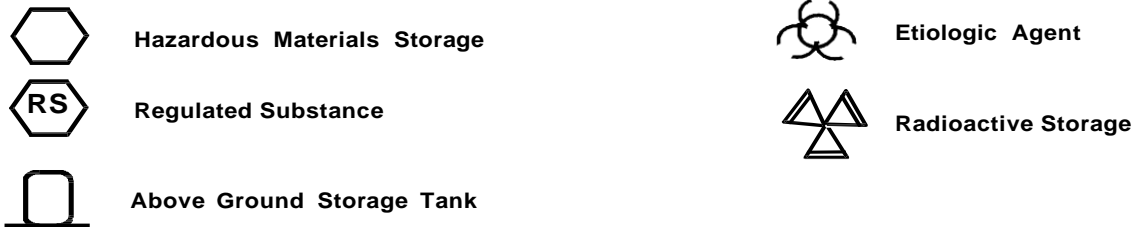

Use these symbols to designate hazardous waste/treatment locations:



Use this symbol to designate location of diesel back-up generators:



Use these symbols to designate underground storage tank locations:

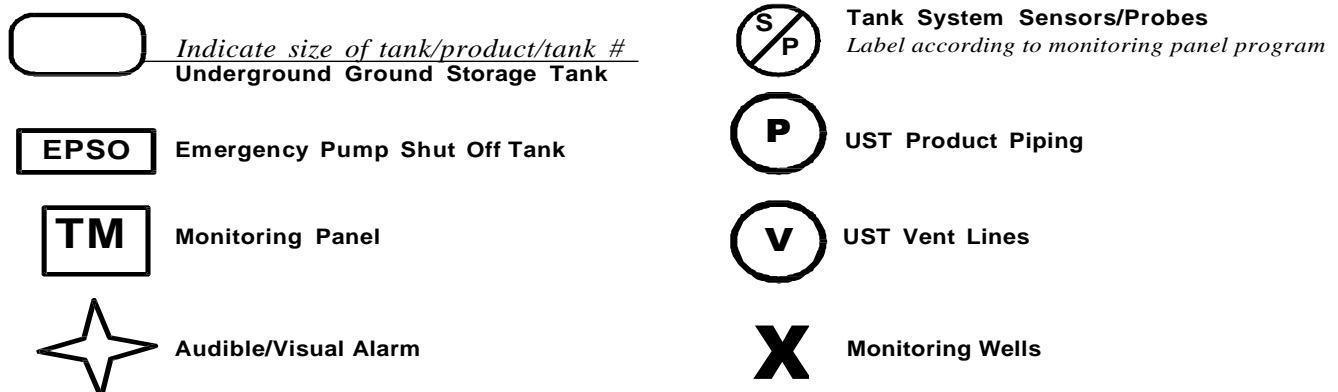

Facility ID # **14102** (Complete this box or affix label here)

Business Name **EZ Manufacturing Company**

Street Address **1101 South Market St. 91489**

The site map shows the layout of the University of California, Davis, with the following details:

- Streets:** Duke Av. (top), 29th St. (left), South Market St. (bottom), and Yuma Av. (right).
- Buildings and Areas:**
  - Manufacturing Plant:** Located in the top-left quadrant, containing equipment labeled #002/10,000 g SU and #001/10,000 g RU.
  - Vehicle Maintenance Shop:** Located in the top-right quadrant, containing compressed gas cylinders.
  - Parking Lot:** Located in the center-right area.
  - Administration:** Located in the bottom-right quadrant.
- Equipment and Symbols:**
  - TM:** Top-left corner of the Manufacturing Plant.
  - L:** Corner symbol between the Vehicle Maintenance Shop and the Parking Lot.
  - G, W:** Corner symbols between the Manufacturing Plant and the Vehicle Maintenance Shop.
  - ER eq:** Equipment symbol between the Manufacturing Plant and the Vehicle Maintenance Shop.
  - EPSO:** Equipment symbol between the Manufacturing Plant and the Vehicle Maintenance Shop.
  - HW:** Equipment symbol between the Manufacturing Plant and the Vehicle Maintenance Shop.
  - V, L1, L2, L3, L4, L5, L6, L7, L8:** Various equipment and location labels throughout the site.
  - X:** Multiple 'X' marks indicating specific locations or features.
  - FH:** Corner symbols at the top-left and bottom-right of the site.
  - S:** Corner symbols at the top-left, top-right, bottom-left, and bottom-right of the site.
  - ESA:** Equipment symbol at the bottom-right corner of the site.

## Sample #2

### Facility Map --Detailed Site Map

Facility ID #	<b>55555</b>	(Complete this box or affix label here)
Business Name	<b>Super Tell Communications</b>	
Street Address	<b>1103 South Market St.</b>	

Attach a Detailed Site Map to this sheet or draw your map below. Use the symbols on page 2.

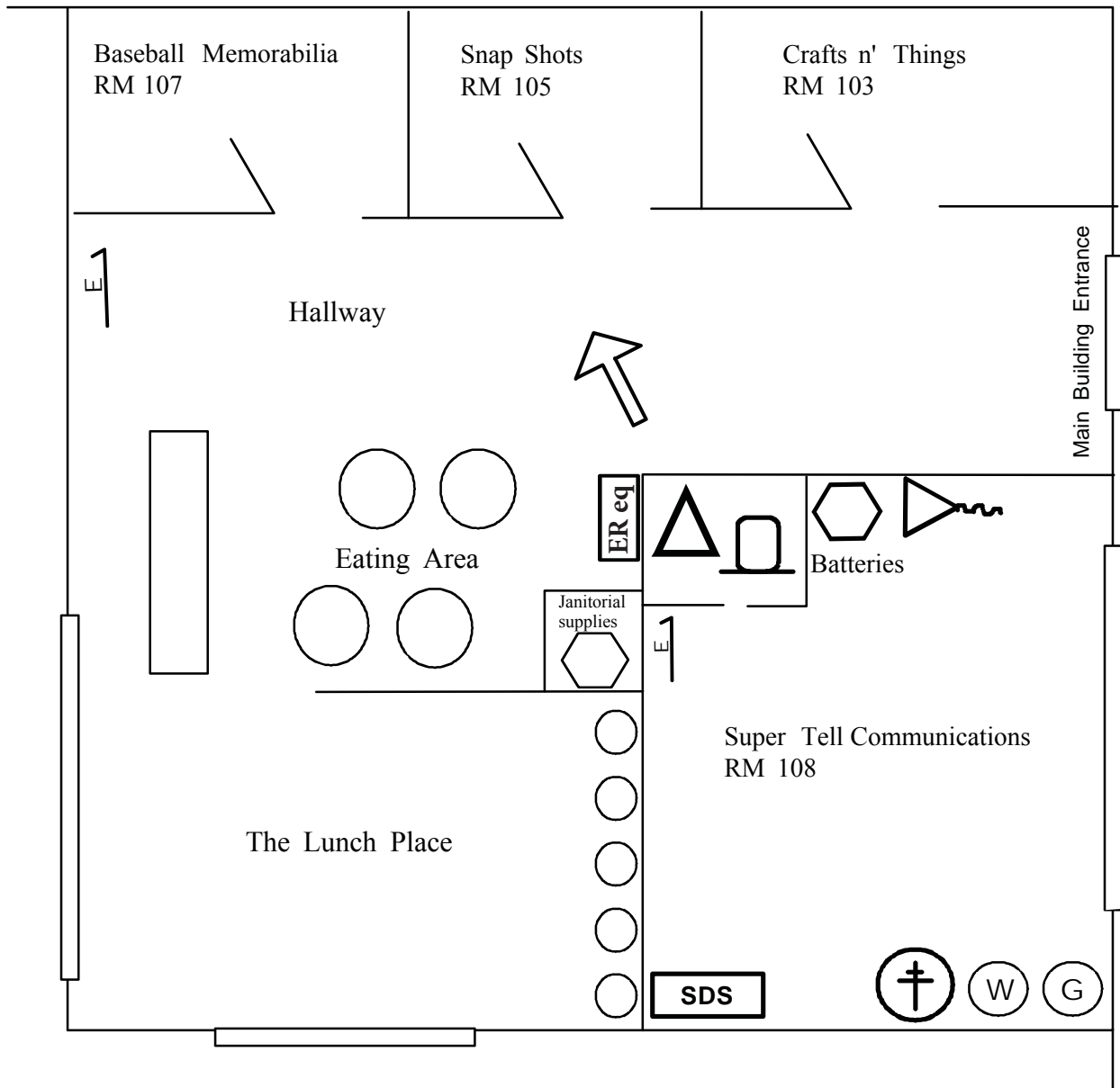

## Facility Map—General Site Map

<b>Facility ID#</b>	<i>(Complete this box or affix label here)</i>
<b>Business Name</b>	
<b>Street Address</b>	

Attach your General Site Map to this sheet or draw your map below.

## Facility Map—Detailed Site Map

<b>Facility ID#</b>	<i>(Complete this box or affix label here)</i>
<b>Business Name</b>	
<b>Street Address</b>	

Attach a Detailed Site Map to this sheet or draw your map below. The size of the map must be appropriate for storage in file cabinets. Make more copies of this sheet if necessary.