



San Francisco Sales Office
 1419 8TH Ave
 San Francisco, CA 94122
 Telephone: 415 362-5595
 Fax: 415 362-5599
 LBE CMD# 032116500

PROPOSAL: 66137
DATE: 05/15/23

PROJECT #: 30-13

PROPOSAL FOR:	SHIP TO:
DAN LEUNG SDA Office of the Inspector General	DAN LEUNG SDA Office of the Inspector General 1 VAN NESS AVE., 8TH FL SAN FRANCISCO CA 94103

SALESPERSON:
RANDY HERSHKOWITZ

CUSTOMER P/O:

QUOTE VALID THROUGH:
6/30/23

#	QTY	PRODUCT	DESCRIPTION	SELL	EXTENDED
1	9	WORKSTATION	FRIANT NOVO WORKSTATIONS PER DRAWING DATED 5/15/23 INCLUDING THE FOLLOWING: 67" HIGH NOVO PANELS WITH GLASS WINDOW INSERT, GRADE 1 FABRIC, STD PAINT, NO ELECTRICAL. 2-PIECE WORKSURFACE 6' X 6.5' CURVED CORNER, STD LAMINATE, 3-LEG SIT STAND 3-STAGE ELECTRICAL BASE, (1) BOX/FILE MOBILE FILE, (1) 53" HIGH 12" WIDE WARDROBE CLOSET	3,284.75	29,562.75
2	1	FD-LC29-2471-3L-F.ND	FRIANT DASH CREDENZA 24" X 72" X 29" HIGH SPLIT LATERAL FILE, 2-DOOR STORAGE	1,117.50	1,117.50
3	1	FD-LF-2-36-F	FRIANT DASH 2-DRAWER LATERAL FILE 24" X 36" X 29" HIGH STD LAMINATE	715.80	715.80
4	9	AF528-KR200	OM SEATING AFFIRM UPHOLSTERED SEAT AND MESH BACK EXEC SYNCHRO- TILT TASK CHAIR KR200 HEIGHT AND WIDTH ADJ ARMS FABRIC: TYPE 1300-Obsidian/Black Grade 1	448.85	4,039.65

San Francisco Sales Office
1419 8TH Ave
San Francisco, CA 94122
Telephone: 415 362-5595
Fax: 415 362-5599
LBE CMD# 032116500

PROPOSAL: 66137

DATE: 05/15/23

PROJECT #: 30-13

PROPOSAL FOR:	SHIP TO:
DAN LEUNG SDA Office of the Inspector General	DAN LEUNG SDA Office of the Inspector General 1 VAN NESS AVE., 8TH FL SAN FRANCISCO CA 94103

SALESPERSON:
RANDY HERSHKOWITZ

CUSTOMER P/O:

QUOTE VALID THROUGH:
6/30/23

#	QTY	PRODUCT	DESCRIPTION	SELL	EXTENDED
5	9	CPU600	HUMANSCALE CPU HOLDER	83.45	751.05
6	9	Q-M21CMSBTB	HUMANSCALE SINGLE MONITOR ARM	160.31	1,442.79
7	9	6G90090G22	HUMANSCALE 6G ADJUSTABLE KEYBOARD WITH CLIP MOUSE	206.59	1,859.31
8	9	ADP-TR2P1UA1UC9B	DESKTOP POWER WITH CLAMP. 2-PLUGS, USB B & C.	132.20	1,189.80
9	6	N85SA	NATIONAL OFFICE ELOQUENCE WOOD GUEST CHAIR GRD 6 FABRIC	642.40	3,854.40
10	20	N54AMM3ST	NATIONAL OFFICE VORA CONFERENCE CHAIR W/ARMS GRD 4 FABRIC TBD	394.24	7,884.80
12	2	88NA181818TSQVLW	NATIONAL OFFICE WIXLER OCCASSIONAL TABLE 18" SQUARE LAMINATE TOP	689.92	1,379.84
13	12	TCO DESIGN/PM	SPACE PLANNING/ON SITE PROJECT MANAGEMENT	105.00	1,260.00
14	1	DEL-OUT	FREIGHT AND DELIVERY TO SITE	3,000.00	3,000.00
15	1	DEL-RDI	REGULAR HOURS INSTALLATION INCLUDING ASSEMBLY NON UNION	4,000.00	4,000.00



San Francisco Sales Office
 1419 8TH Ave
 San Francisco, CA 94122
 Telephone: 415 362-5595
 Fax: 415 362-5599
 LBE CMD# 032116500

PROPOSAL: 66137
DATE: 05/15/23

PROJECT #: 30-13

PROPOSAL FOR:	SHIP TO:
DAN LEUNG SDA Office of the Inspector General	DAN LEUNG SDA Office of the Inspector General 1 VAN NESS AVE., 8TH FL SAN FRANCISCO CA 94103

SALESPERSON:
RANDY HERSHKOWITZ

CUSTOMER P/O:

QUOTE VALID THROUGH:
6/30 23

#	QTY	PRODUCT	DESCRIPTION	SELL	EXTENDED
<p>Thank you for the opportunity to quote on your requirements...</p>					
DEPOSIT REQUIRED:				PRODUCT SUBTOTAL:	53,797.69
ACCEPTED BY: _____				NON TAXABLE SERVICES:	4,260.00
DATE ACCEPTED: _____				DEL/INSTALL.:	4,000.00
				SALES TAX...:	4,985.07
				TOTAL.....:	67,042.76
					=====

Inspector General SDA Office - (8) workstations. 6.5' X 5.5' Sit/stand workstation with wardrobe closet on feet and B/F mobile pedestal. 67" high NOVO panels with glass insert, sit/stand table base and wardrobe cabinet. Additional Dash storage as shown below.

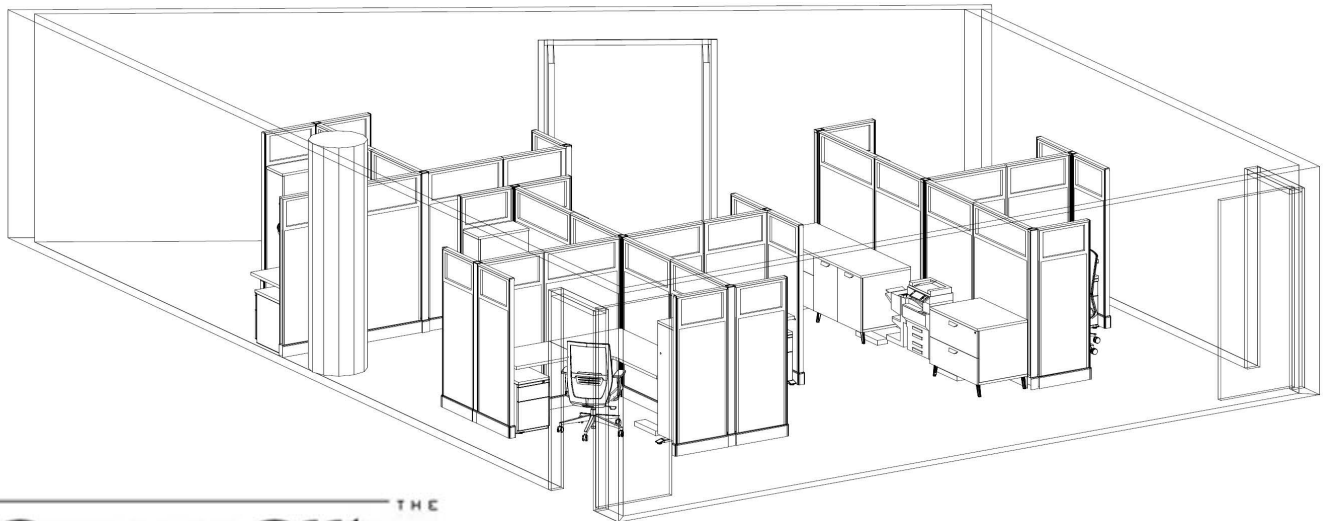
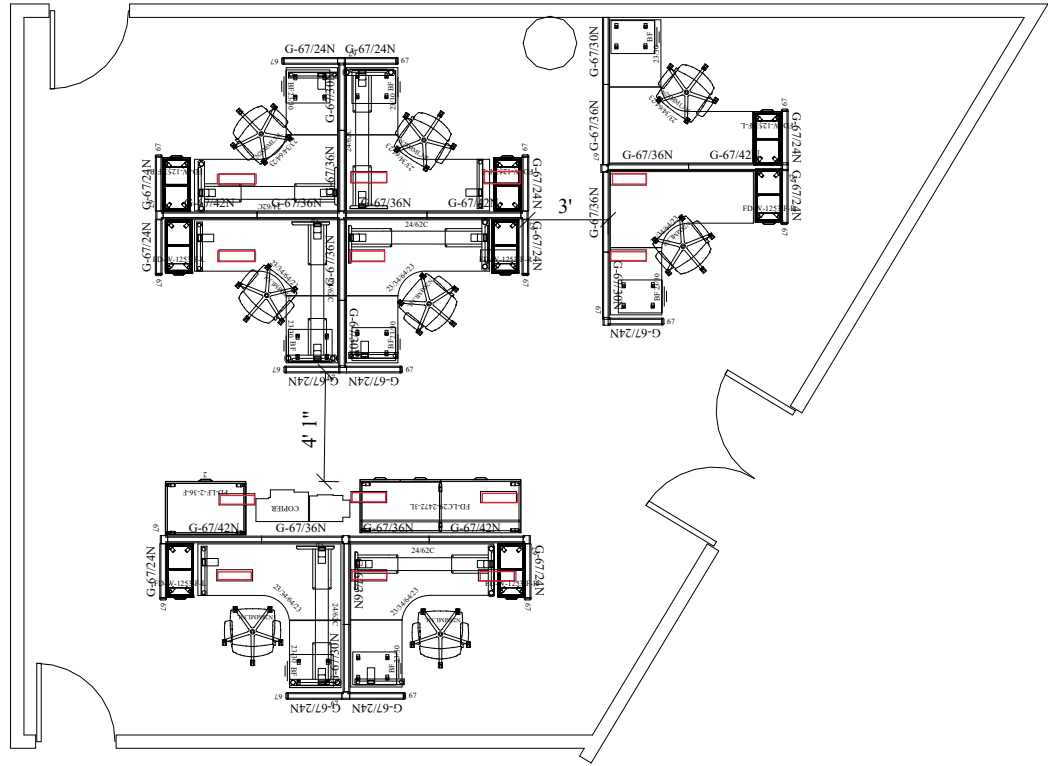

San Francisco Sales Office
 1419 8TH Ave
 San Francisco, CA 94122
 Telephone: 415 362-5595
 Fax: 415 362-5599
 LBE CMD# 032116500