

Mission Creek Park Extension Public Art Project







Mission Creek Park Extension Public Art Project

- Focal sculpture, or series of smaller sculptures, located at the entrance of Mission Creek Park where Channel Street meets Mission Bay Drive.
- Artwork may consist of durable, natural materials that are appropriate for exterior use, including metal, stone, glass, and/or wood.
- Artwork may be illuminated at night.

Project Goals

- Artwork should be inspired by and responsive to the site, including its natural and physical landscape, history, and use.
- Artwork should have a visual impact from a distance, yet be integrated into the landscape and appropriate to the scale of the site.

Budget

- **Total Art Implementation Budget: \$685,000**
 - **Estimated Artist Contract Budget: \$535,000**, inclusive of all artist's fees, as well as associated expenses for artwork design, engineering, fabrication, insurance, and transportation.
 - **Estimated Site Work and Installation Allocation: \$150,000**, performed under separate contract with the City, and inclusive of artwork foundation, lighting, installation, and other associated site expenses.

Review Process to Date

1. Request for Qualifications (RFQ) posted June 21 – August 27, 2021
2. Qualification Panel met September 17, 2021. Reviewed 135 artists to create a short-list of 30 artists.
3. Artist Review Panel met on September 23, 2021 to review shortlisted artists. Recommended 3 finalists, who were approved by the Visual Arts Committee and Full Commission.
4. Artist orientation with project team and stakeholders on October 28, 2021
5. Display of finalist proposals for public comment December 13 – January 3, 2022.
6. Presentation of proposals to Mission Bay CAC on January 13, 2022.

Voting Panel Composition

- **Arts Commission Representative:** *Commissioner Janine Shiota*
- **Client Representative:** *OCII Commissioners Miguel Bustos*
- **Outside Arts Professionals:** *Walter Kitundu and Jenny Gheith*
- **Community Representative:** *Sarah Davis*
- **Design Team Representatives** (shared vote): *Nick Gotthardt and Luke Stewart*

Scoring Criteria

Artistic Merit (7pts): Artistic merit may be judged by such measures as originality of concept and artistic vision; the degree to which the work engages the viewer emotionally, intellectually, spiritually; the quality of craftsmanship or mastery of skills and techniques.

Relevant Skills & Experience (3pts): The panel shall consider the assessed ability of an artist to successfully implement the project, such as the ability to work constructively with other project stakeholders, meet deadlines, willingness to resolve issues as they arise, and generally manage the demands of the project. (3 pts)

Meets Project Goals (6pts): Proposal that meets the specific goals of the project:

- ✓ Inspired by and responsive to the site, including its natural and physical landscape, history, and use.
- ✓ Visual impact from a distance yet be integrated into the landscape and appropriate to the scale of the site.
- ✓ Meaningful connection to Mission Creek/Mission Bay/San Francisco.

Feasibility and Maintainability (4pts): Proposal is judged to be feasible within the budget and maintainable within the means of the Commission.



**MISSION CREEK PARK EXTENSION
ARTIST REVIEW PANEL TWO SUMMARY**

MEETING DATE

January 18, 2022

VOTING SELECTION PANELISTS

Miguel Bustos, Chair, Commission on Community Investment and Infrastructure

Sarah Davis, Mission Bay Community Advisory Committee, Community Representative

Jenny Gheith, Assistant Curator, Department of Painting and Sculpture, SFMOMA

**Nick Gotthardt, Principal, Surfacedesign Inc

Walter Kitundu, Artist

**Luke Stewart, Director of Design and Planning, Mission Bay Development Group

**sharing a vote

PROCESS

Three artist finalists presented their proposals for the Mission Creek Park Extension Park Public Art Project. The Artist Review Panel discussed the finalists' proposals and scored each artist on the following criteria (1= low score):

Artistic Merit (1-7)

Relevant Skills and Experience (1-3)

Meets Project Goals (1-6)

Feasibility and Maintainability (1- 4)

RESULTS

Rigo 23 117

Windy Chien 97

Adrien Segal 87

ARTS COMMISSION APPROVAL

Discussion and Possible action: to approve artist Rigo 23 (Ricardo Gouveia) and proposal for the Mission Creek Park Extension Public Art Project, as recommended by the artist review panel.

Discussion and Possible action: to authorize the Director of Cultural Affairs to enter into contract with artist Rigo 23 (Ricardo Gouveia) for an amount not to exceed \$535,000 for design, fabrication, transportation and installation consultation of an artwork for the Mission Creek Park Extension Public Art Project.

RIGO 23 - Art Proposal for The Mission Creek Park Extension

Unflagging Presence:

The California Grizzlies of Mission Creek

Is a sculptural tribute to the original wildlife present within the area known today as Mission Creek Park.

In 1871, famed naturalist John Muir wrote, "Bears are made of the same dust as we, and breathe the same winds and drink of the same waters. And whether he at last goes into our stinky heaven or not, he has terrestrial immortality."

To this day, the Grizzly Bear continues to be one of California's most visible and enduring symbols, adorning both the state flag and seal. However, by the time the California Grizzly Bear is designated official state animal, in 1953, it had been extinct in the state for over two decades.

With these larger-than-life Grizzlies (150% actual size), I aim to call upon the kind of proximity the animal world shared with the human world at the time of the Ohlones, pre-California. This relationship would be underscored by the Native plant and animal life restoration area within which the sculptures exist.

I also aim to remind our contemporaries that the survival of even such a majestic and powerful animal, as the Grizzly Bear, is dependent foremost on the actions of us humans. The tender love and fierce protection of the bear mother alone is not sufficient to guarantee the survival of her cubs.

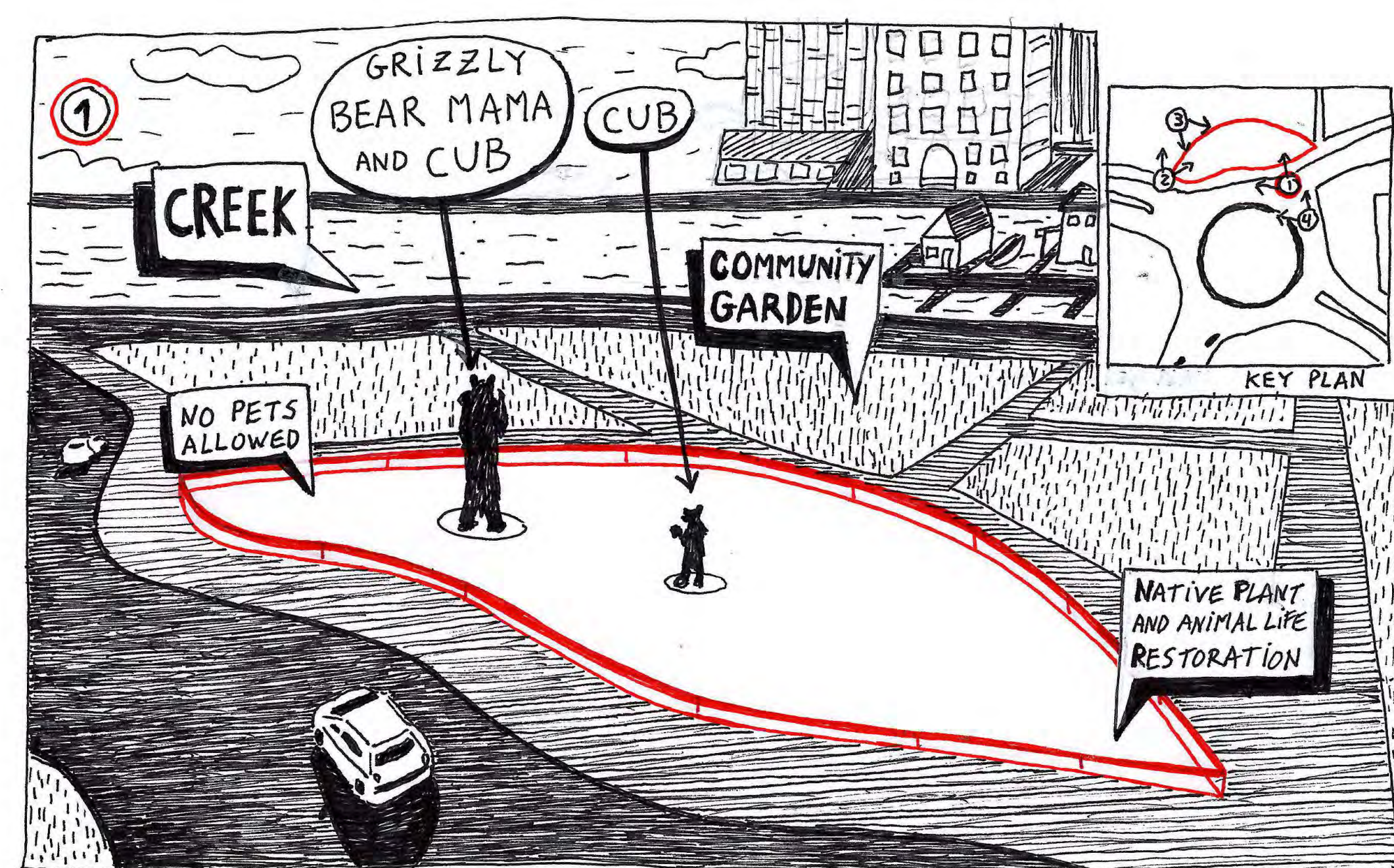

● PROPOSED ARTWORK LOCATION
 DIMENSIONS: MAMA BEAR IS 13½ FEET TALL
 CUB IS 6 FEET TALL

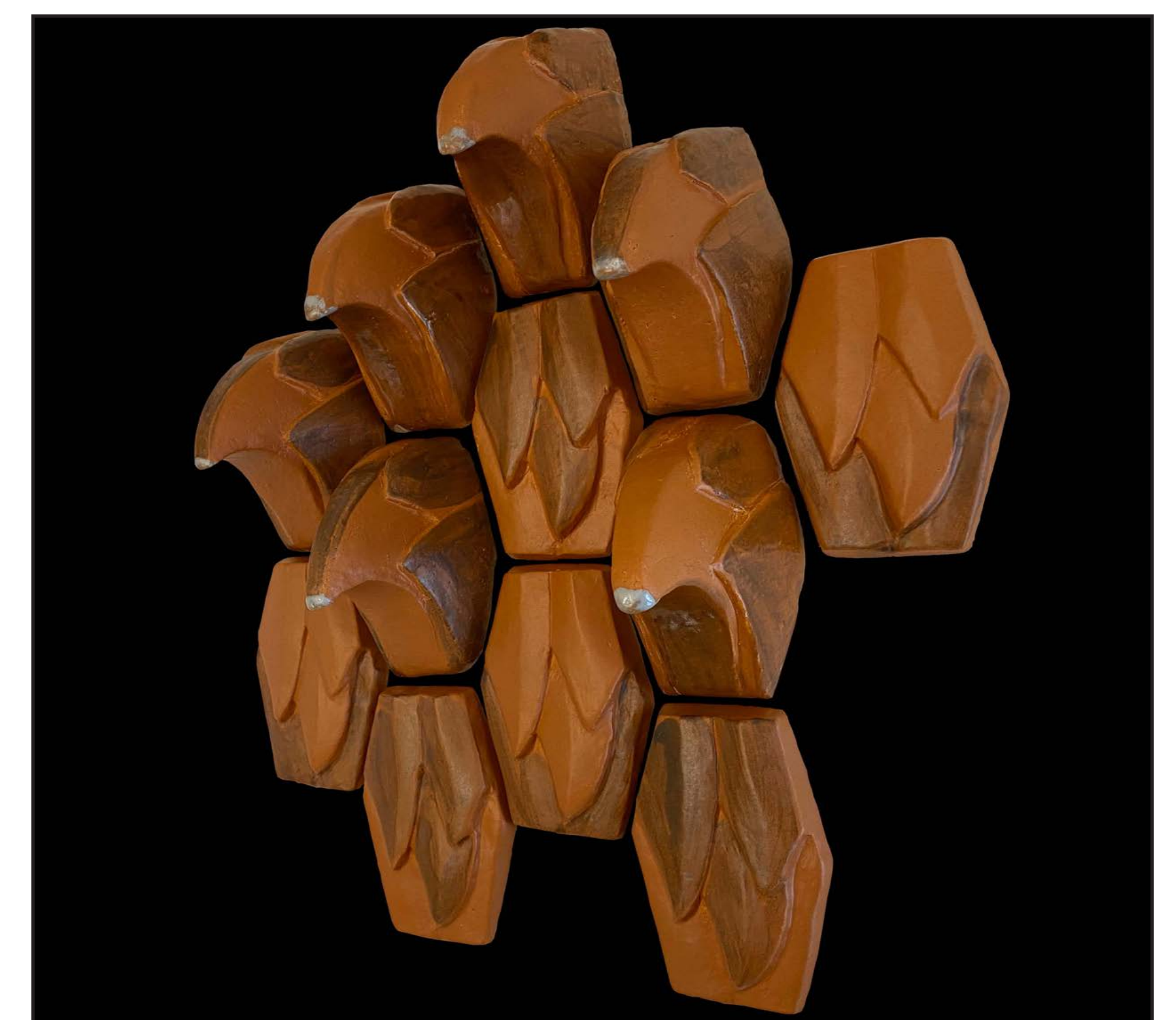
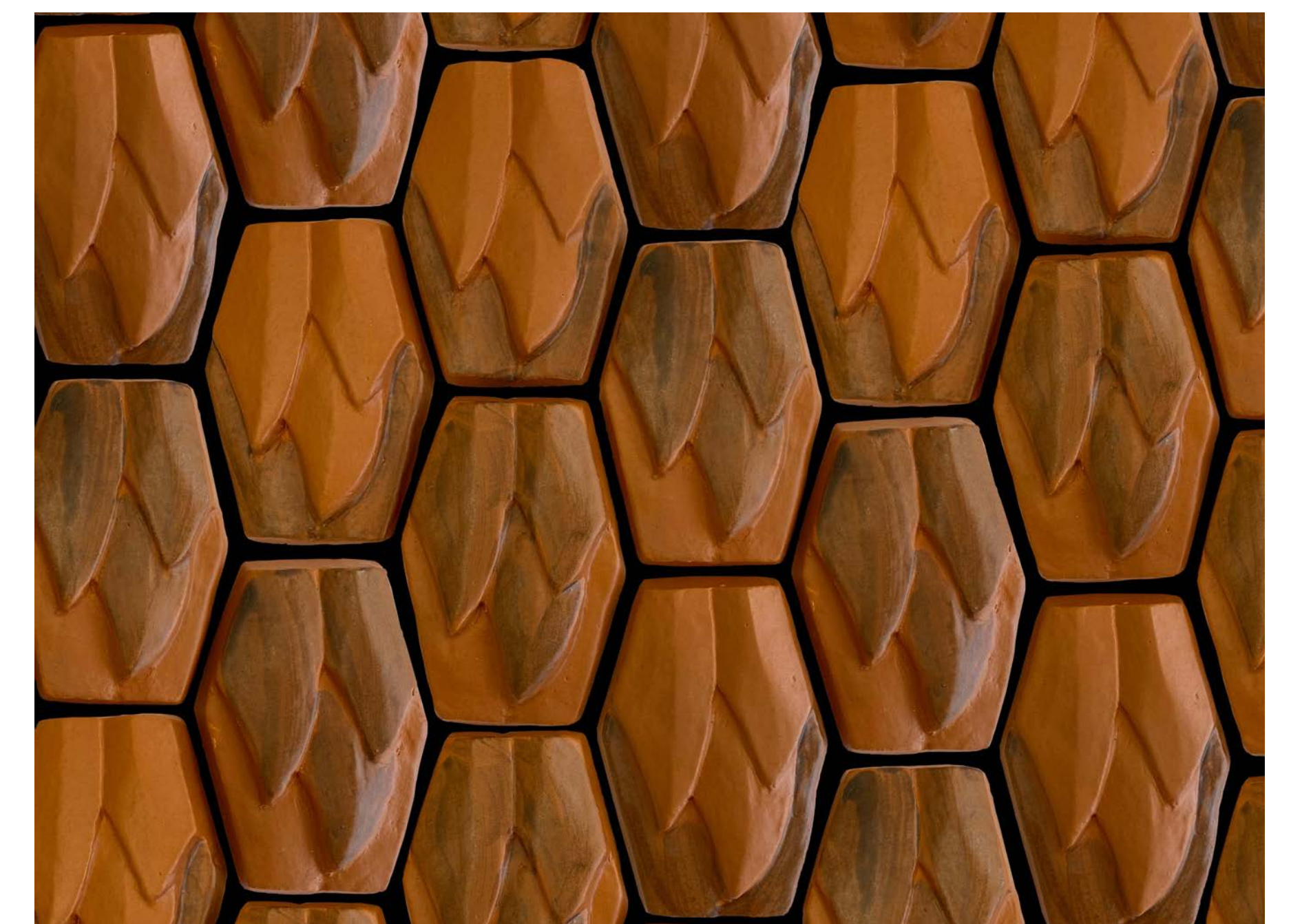
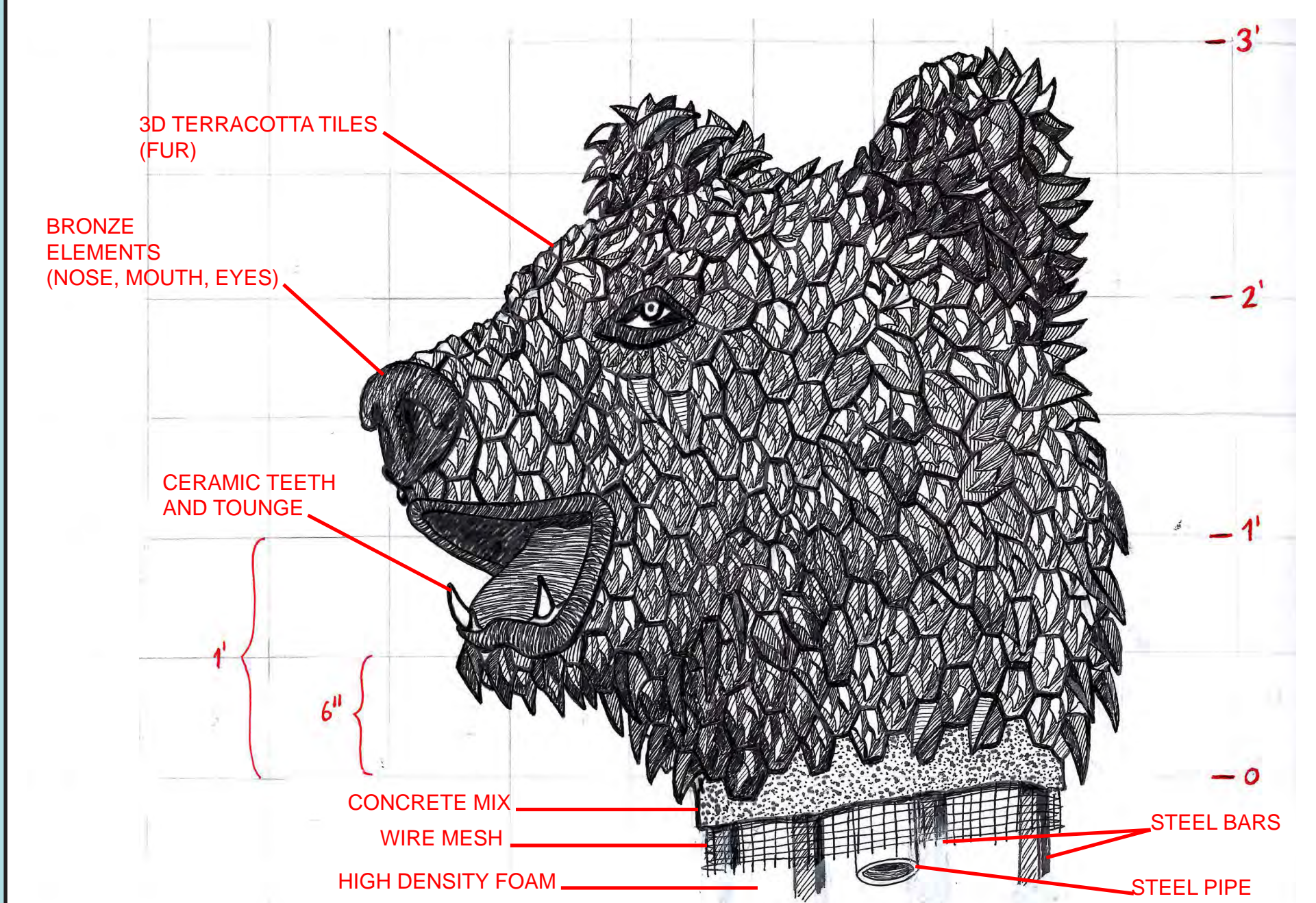

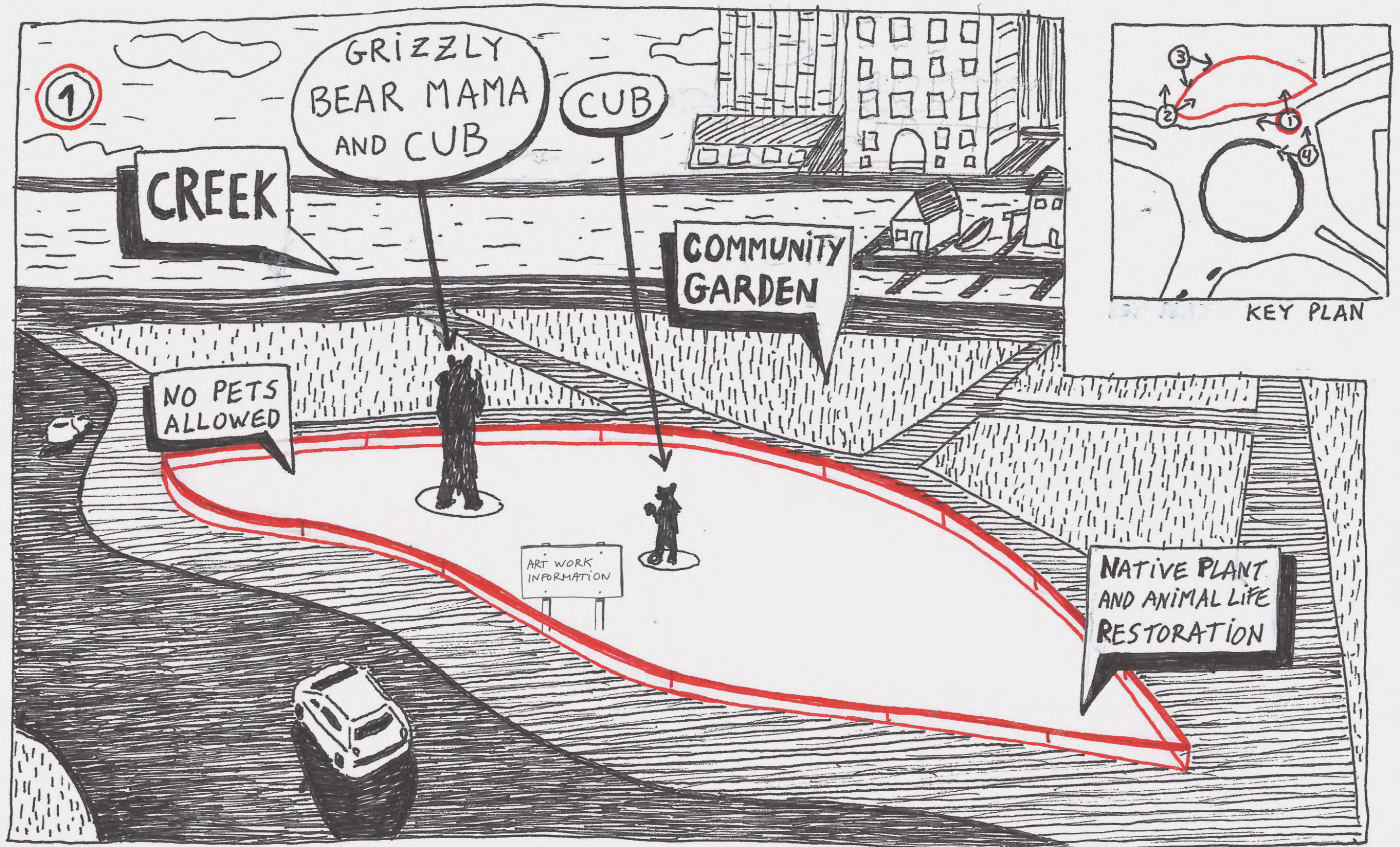

ARTWORK SIGNAGE IN THE PARK WOULD INCLUDE A Q.R. CODE THAT GIVES THE PARK GOER- VIA THEIR CELL PHONE- ACCESS TO A DATA BANK WHERE NATIVE INDIGENOUS CALIFORNIA LANGUAGE SPEAKERS SHARE WITH US THE WORDS FOR "GRIZZLY BEAR" OR "GRIZZLY BABY" IN THEIR NATIVE TONGUE.



405 CM
APROX: 13 1/2 FEET TALL
412 CM



5'9"



A SERIES OF HEXAGONAL TILES OF VARYING LENGTHS WILL BE DESIGNED TO REPLICATE THE VARIATIONS THAT ARE NATURALLY PRESENT ON THE GRIZZLY'S FUR. THE TIPS ARE GLAZED IN SILVER AND TONAL VARIATION WILL COME FROM THE TERRACOTA

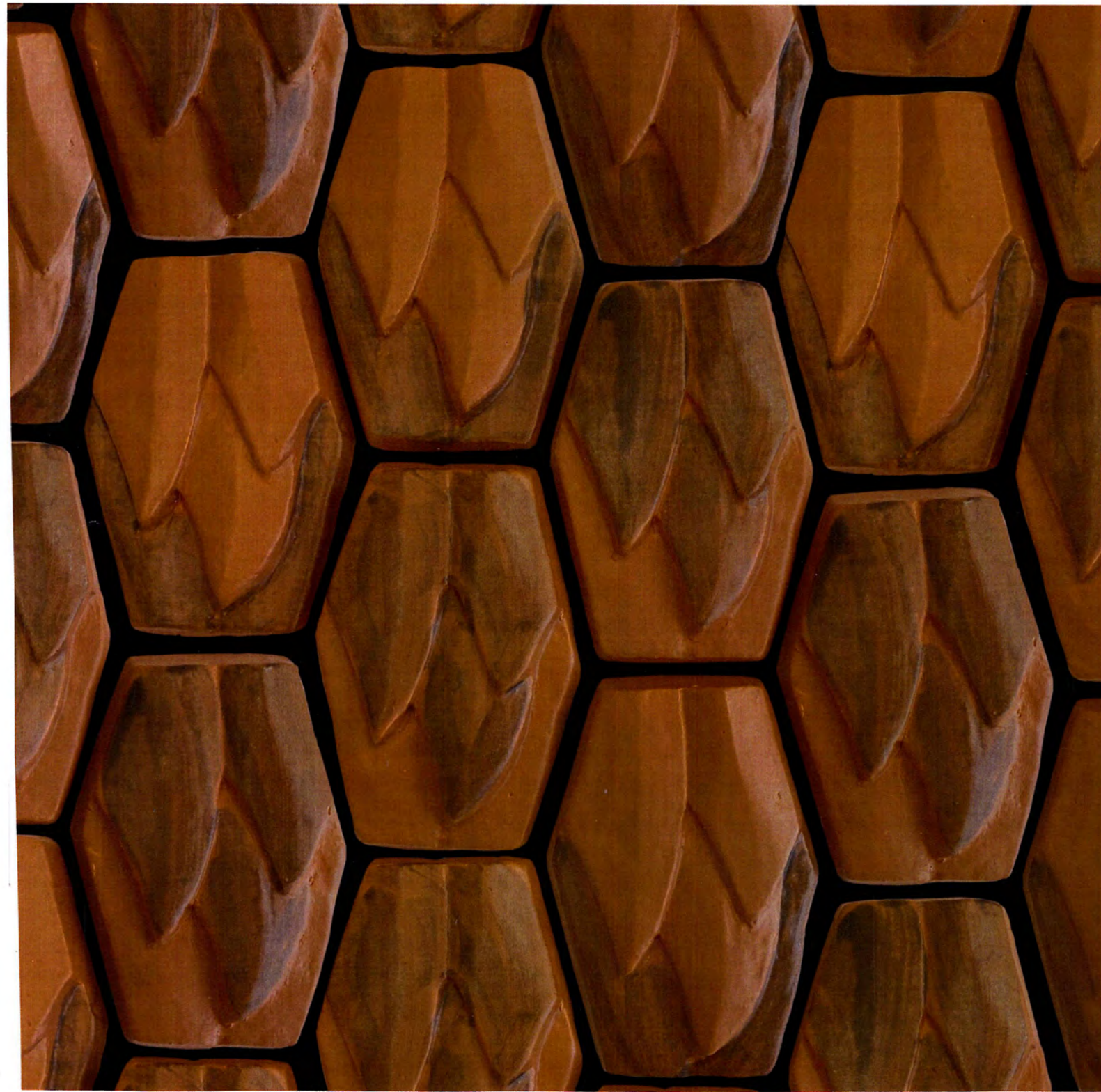

CLAY ITSELF. ASIDE FROM THE TONAL VARIATION PROVIDED BY THE CLAY, GLAZES WILL ALSO BE APPLIED TO SPECIFIC TILES ACCORDING TO THE PLACE THEY WILL OCCUPY ON THE BEAR'S BODY.

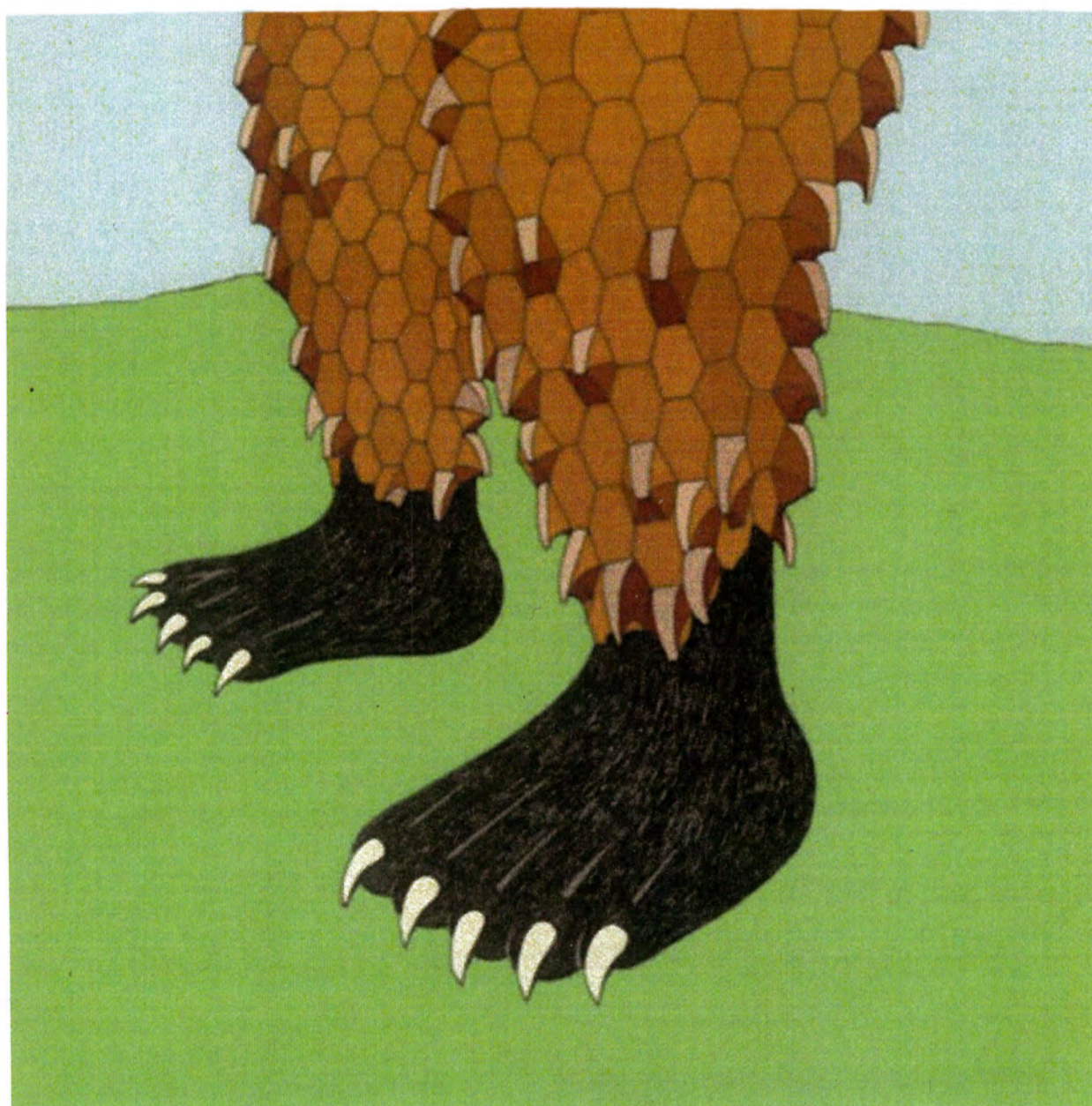

THE THREE BEARS' PAWS WILL BE RENDERED IN BRONZE - AS WILL THEIR NOSES, MOUTHS, EYES AND NIPPLES.

THE BRONZES WILL BE PATINAED TO FURTHER APPROXIMATE THE ANIMAL'S NATURAL COLORS.



THE BRANCHES WITH LEAVES THAT THE MAMMA GRIZZLY IS EATING ARE ALSO CAST IN BRONZE WITH PATINAS WHICH REPRODUCE NATURALISTIC COLORS.

(CLAWS, MOUTH AND LEAVES ARE CAST TOGETHER FOR STRENGTH)